

WARNING:

- This product must be installed in accordance with the applicable installation code by a person familiar with the construction and operation of the product and the hazards involved.
- Make sure all electrical power is turned off while installing the fixture.
- This luminaire must be adequately grounded for protection against shock hazards and to assure proper operation.
- Disconnect power before servicing.
- LEDs are ESD (Electro Static Discharge) sensitive devices that can be easily damaged if the proper ESD mitigating steps are not taken.
- LEDs are very sensitive to mechanical damage. Caution must be taken to avoid damage to the LEDs.
- ESD or mechanical damage voids all warranties.
- Suitable for dry and damp locations.

STAND-ALONE ASSEMBLY (See page 2 for Row Assembly)

STEP 1: For T-bar ceiling, install mounting brackets at desired locations. T-bar mounting bracket halves are supplied as a one-piece metal stamping. Bend inward at middle until bracket breaks into two pieces. Insert 1/4 - 20 threaded stud into "A" half of bracket.

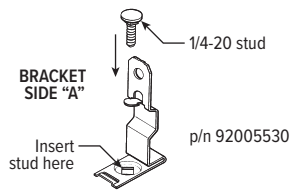

STEP 2: T-bar mounting bracket halves interlock and snap together around T-bar. Brackets must be placed exactly on each mounting point for correct installation and hanging of cables.

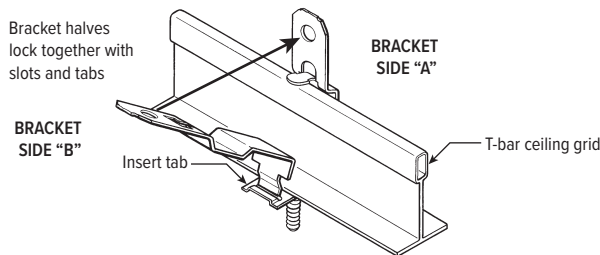

STEP 3: A stand-alone fixture will require two suspension cables with grippers and mounting hangers. For safety, always support the weight of the fixture. **Do not leave a fixture hanging by only one end while working.**

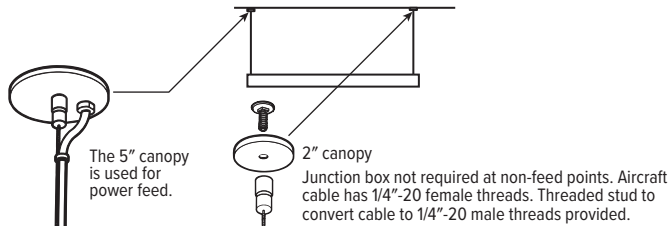

STEP 4: Hanger at ends of fixture are pre-attached loosely to each end plate.

- A.** Install hanger. Rock hanger up and tighten with phillips head screw driver. Insert cable into hanger. Repeat on opposite end.

END HANGER

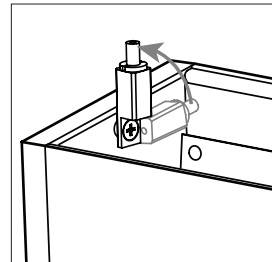

- B.** Level fixture and cut excess cable. Leave a minimum of 1" cable coming out of the gripper.

STEP 5: Make electrical connections in accordance with NEC and local codes. See "WIRING DIAGRAM" on page 4.

STEP 6: The lens will need to be cut to fit around the hangers. Measure and cut lens with a fine tooth cut off saw, feeding slowly.

STEP 7: Install the lens.

- A.** Insert one side of the lens into one side of the fixture housing.
B. Push the corner of the opposite side of the lens into place.
C. Continue pushing along the housing until the entire lens is installed.

- To remove the lens, pry out starting with the 4" wide end.

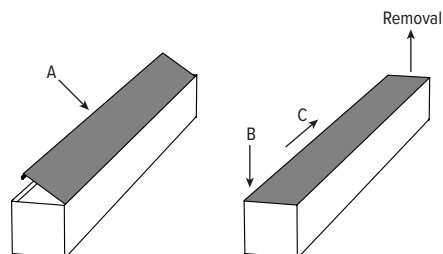

MX4U

INSTALLATION INSTRUCTIONS

ROW ASSEMBLY

STEP 1: For T-bar ceiling, install mounting brackets at desired locations (see stand-alone assembly step 1 & 2).

STEP 2: Install mounting cables at desired locations. Only the first fixture in each row will require two suspension cables. Each adjoining fixture will require only one cable before attaching to the previous fixture. For safety, always support the weight of the fixture. **Do not leave a fixture hanging by only one end while working.**

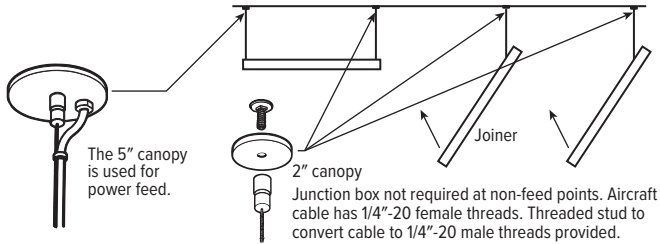

STEP 3: Lay out extrusions so that the row aligners are on opposite sides of connecting pieces.

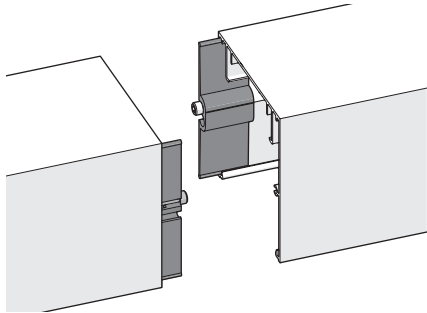

STEP 4: For safety, always support the weight of the fixture. Do not leave a fixture hanging by only one end while working. Hanger at ends of fixture are pre-attached loosely to each end plate.

A. Install hanger.

END HANGER

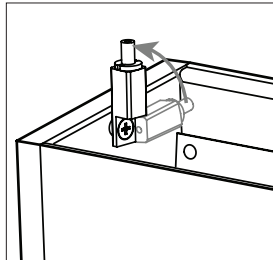

Rock hanger up and tighten with phillips head screw driver. Insert cable into hanger.

JOINER HANGER

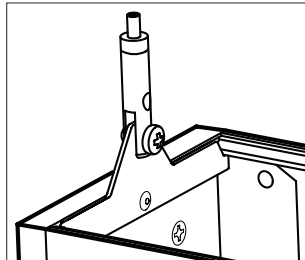

Insert hanger, squeeze together, and install screw.

B. Level fixture and cut excess cable. Leave a minimum of 1" cable coming out of the gripper.

STEP 5: While supporting the weight of the next extrusion, clip next hanger piece into next extrusion (see Step 4A).

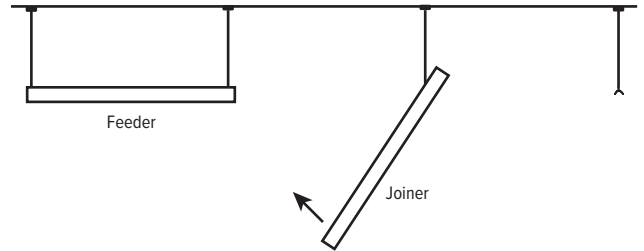

STEP 6: Connect row aligners using 10-24 x 1-1/2" socket head cap screw provided and 5/32" ball end hex bit. Secure tightly to achieve flush seams.

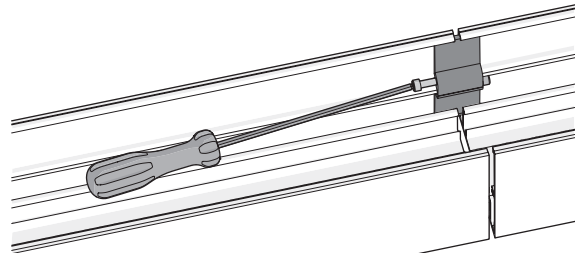

STEP 7: Repeat Steps 4 – 6 until only final extrusion remains.

STEP 8: Remove the row aligner from the end of the row-end extrusion using 5/32" ball end hex bit.

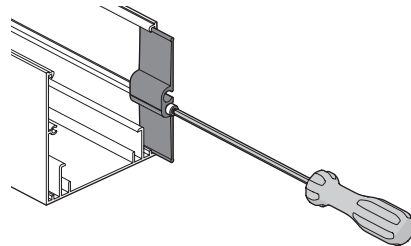

MX4U

INSTALLATION INSTRUCTIONS

STEP 9: Install end plate onto end of row-end extrusion (or single extrusion) using 10-24 x 1" SST socket head cap screw.

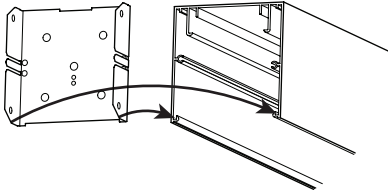

- Install and secure end cap from inside using (4) #8 x 1/4" flathead screws provided.

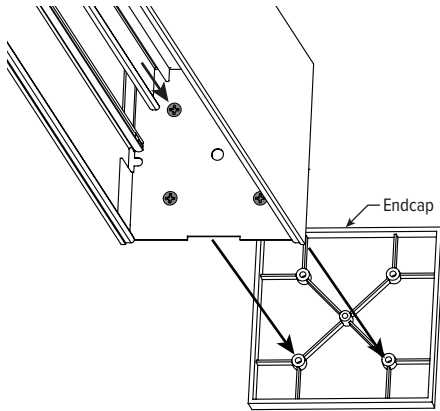

STEP 10: Starting with Feeder cartridge, snap light cartridges in place leaving 4" – 6" of space between units. Visually check that all catches are engaged.

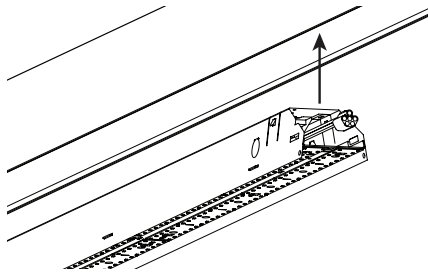

STEP 11: Make electrical connections in accordance with NEC & local codes. See "WIRING DIAGRAM" on page 4.

- A.** Connect quick-connect harness(es).

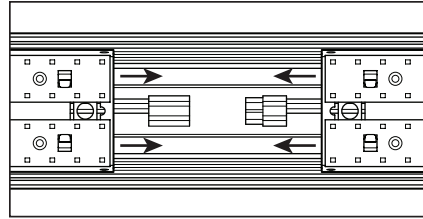

- B.** Slide cartridges tightly together toward end plate covering wiring harness(es).

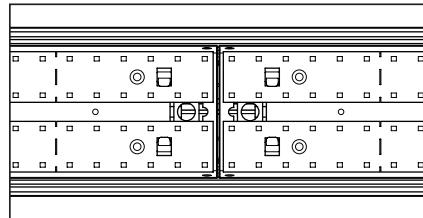

STEP 12: The lens will need to be cut to fit around the hangers. Measure and cut lens with a fine tooth cut off saw, feeding slowly.

STEP 13: Install the lens.

- A.** Insert one side of the lens into one side of the fixture housing.
- B.** Push the corner of the opposite side of the lens into place.
- C.** Continue pushing along the housing until the entire lens is installed.
- To remove the lens, pry out starting with the 4" wide end.

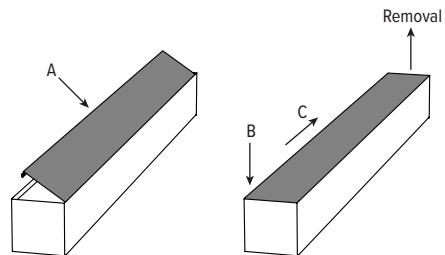

MX4U

INSTALLATION INSTRUCTIONS

ASY OPTION INSTALLATION

CHANGE DIRECTION OF THROW

- STEP 1: Remove (3) screws from reflector.
- STEP 2: Snap bracket out of channel, then rotate 180°.
- STEP 3: Snap bracket back into channel.
- STEP 4: Attach reflector to brackets using #8 flat screws.

FIG 4.1

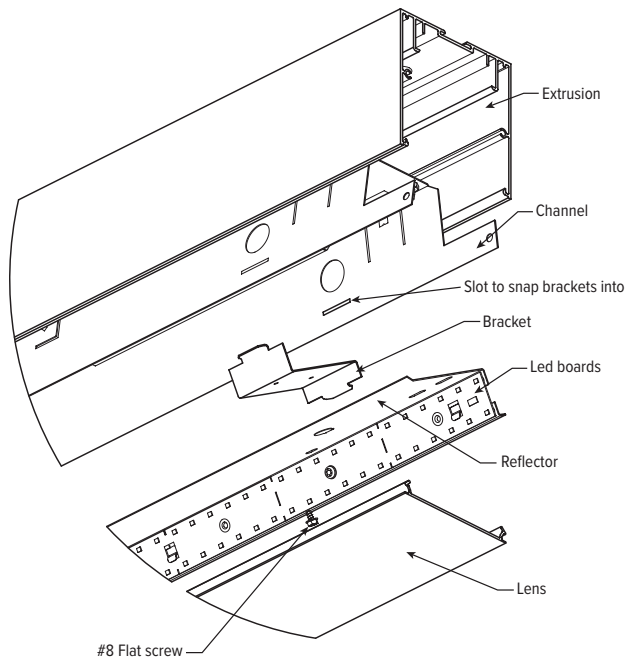
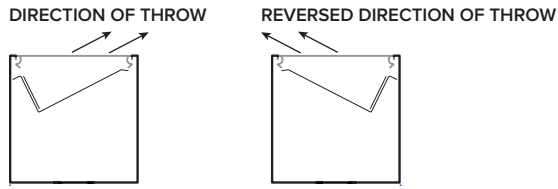

WIRING DIAGRAM

Make electrical connections in accordance with NEC and local codes.

