

4PS dim to WARM 4.5" Shallow Plenum Downlight – Square

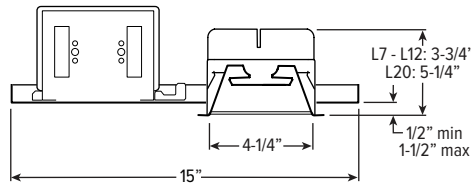
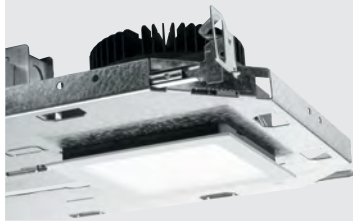

CATALOG #: _____

TYPE: _____

PROJECT: _____

NEW CONSTRUCTION AND REMODEL

FEATURES

- Dim to warm from 1800K to 3000K CCT, minimum 95 CRI
- Slim 5" depth for minimal plenum space applications
- Beam angles ranging from 30° narrow to 75° wide for tailored performance
- 4 inch aperture is unobtrusive in small scale spaces
- Square shape accentuates architectural styles
- Spring clip retention system eliminates trim sag
- Die cast trim with flush lens provides glare-free illumination for a soft ceiling appearance
- Fully room-side accessible

SPECIFICATIONS

- **HOUSING** – Formed steel housing with forged aluminum heat sink. Galvanized steel splice compartment with driver mounting plate/enclosure. Mounting clips allow for ceiling thickness from 1/2" – 1-1/2" (consult factory for additional ceiling thicknesses).
- **LENSED TRIM** – Die-cast aluminum frame with micro-prismatic, tempered glass lens.
- **ELECTRICAL** – High-performance Class 2 C.O.B. LED array. Modular quick-connect plug for easy field-connection of LED light assembly to driver. Reported L70>55,000 hours. Reported L90>55,000 hours. Estimated L70 = 200,000 hours.
- **MOUNTING** – Recessed. 20 ga. galvanized steel mounting pan for new construction or IC-rated enclosure. Remodel kit option includes receiver bracket hardware.
- **LISTINGS** –
 - cCSAus conforms to UL STD 1598; Certified to CAN/CSA STD C22.2 No. 250.0 for damp locations. LED light assembly conforms to UL 2108 for remote installation.
 - Suitable for wet location under covered ceiling when specified with WET/CC option.
 - IC-rated for direct contact with insulation when specified with I Mounting Type.
 - City of Chicago Environmental Air approved when specified with CP option.
 - Complies with ASTM-E283 when specified with ATH option.
 - RoHS compliant.
- **WARRANTY** – 5-year limited warranty, see hew.com/warranty.

ORDERING EXAMPLE: 4PS - L20/9DW - OPTIONS - DIM - UNV - LW - OF - WH - TRIM OPTIONS - N - F1

HOUSING

SERIES	LUMENS ^[1]	COLOR	OPTIONS	CONTROL	VOLTAGE
4PS	L7 700lm	9DW Dim to warm (95 CRI, 1800K – 3000K)	EM/7W	DIM Dimming driver (0-10V signal to control dimming and CCT) LUT Lutron Ecosystem enabled	UNV 120-277V 347 347V ^[7]
	L12 1,200lm		EM/10W		
	L20 2,000lm		EM/10W/RTS		
			ATH	Airtight construction	
			CP	Chicago plenum (CCEA) ^[5]	
			F	Fuse kit	
			SDT	Stepdown transformer ^[6]	

TRIM^[8]

TRIM TYPE	DISTRIBUTION ^[9]	FLANGE TYPE	REFLECTOR FINISH	TRIM OPTIONS
L Flush lens	W 75° Wide M 35° Medium N 30° Narrow	OF 1/2" standard flange SF 1/4" mud-in flange ^[10]	CS Clear semi-specular powder coat WH White texture powder coat BL Black texture powder coat	IP IP65 rated trim AD Diffuse acrylic lens ^[11] PD Diffuse 1/8" polycarbonate lens ^[12] WET/CC Wet location, covered ceiling listed AM Anti-microbial ^[13]

MOUNTING

MOUNTING TYPE^[14]

- N Open pan for new construction
- I IC-rated enclosure for new construction^[16]
- R Remodel kit^[17]

MOUNTING HARDWARE^[15]

- F1 Integral 2-position fixed pan bracket, universal bar hanger included^[18]
- BA1 Adjustable butterfly pan bracket, bar hanger not included^[19]
- CA1 Adjustable caterpillar pan bracket, universal bar hanger included^[20]

NOTES

- Lumen output based on full light output, L trim type, W distribution and WH finish, 3000K/95CRI. Actual lumens may vary +/-5%. See page 2 for FIXTURE PERFORMANCE DATA.
- N and R Mounting Types only.
- N and R Mounting Types only.
- Not available with WET/CC, ATH or IP options. N and R Mounting Types only. See page 3 for EM/10W/RTS DETAILS.
- I Mounting Type required.
- May be required for 347V, see product builder at hew.com/product-builder
- Not available with EM batteries
- Trim ships separately
- Beam angle based on WH reflector finish.
- For use with mud-in plaster construction only, supplied with mud flange installation kit. See page 2 for FLANGE TYPE DETAILS. Not available with ATH or IP options.

- W distribution only.
- W distribution only.
- WH and BL Reflector Finishes only.
- Mounting hardware required (N and I only), ordered separately, see MOUNTING HARDWARE ordering info. See page 3 for MOUNTING TYPE DETAILS.
- Additional mounting hardware options available. See page 4 for MOUNTING HARDWARE DETAILS.
- L12 lumen package max.
- Also used in new construction sheetrock ceilings.
- N and I Mounting Types only.
- N Mounting Type only
- N Mounting Type only



4PS dim to WARM 4.5" Shallow Plenum Downlight – Square

FIXTURE PERFORMANCE DATA

	DISTRIBUTION	DELIVERED LUMENS	CCT AT 100% (FULL OUTPUT)	CCT AT 1% (FULL DIM)	WATTAGE	EFFICACY (lm/W)
L7	W	753	3000K	1800K	14.0	53.8
	M	780			14.0	55.7
	N	754			14.0	53.7
L12	W	1321			23.4	56.5
	M	1367			23.4	58.5
	N	1323			23.4	56.6
L20	W	1955			37.7	51.9
	M	2021			37.7	53.6
	N	1956			37.7	51.9

MULTIPLIER TABLE

TRIM	
CATALOG NUMBER	CONVERSION FACTOR
AD	0.85
PD	0.85

- Photometrics tested in accordance with IESNA LM-79. Results shown are based on 25°C ambient temperature.
- Wattage shown is based on 120V input.
- Results based on 3000K, 95 CRI, full output, actual lumens may vary +/-5%
- Use multiplier table to calculate additional options.

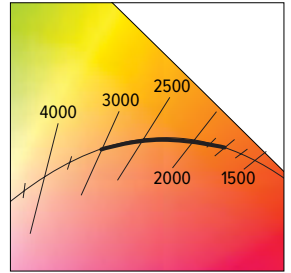

PHOTOMETRY

4PS-L20/9DW-DIM-UNV-LW-OF-WH Total Luminaire Output: 1955 lumens; 37.7 Watts | Efficacy: 51.9 lm/W | 95.0 CRI; 3000K CCT

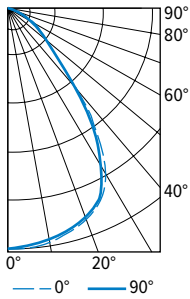

CANDLEPOWER DISTRIBUTION	VERTICAL ANGLE	HORIZONTAL ANGLE			ZONAL LUMENS
		0°	45°	90°	
	0	1100	1100	1100	
	5	1100	1094	1093	104
	15	1060	1055	1052	298
	25	991	994	981	452
	35	704	838	684	470
	45	317	488	306	305
	55	181	204	174	173
	65	99	97	96	99
	75	42	41	41	45
	85	6	6	5	9
	90	0	0	0	

LUMEN SUMMARY	ZONE	LUMENS	% FIXTURE
	0 - 30	854	44
	0 - 40	1324	68
	0 - 60	1802	92
	0 - 90	1955	100
	0 - 180	1955	100

4PS-L20/9DW-DIM-UNV-LM-OF-WH Total Luminaire Output: 2021 lumens; 37.7 Watts | Efficacy: 53.6 lm/W | 95.0 CRI; 3000K CCT

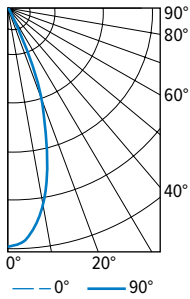

CANDLEPOWER DISTRIBUTION	VERTICAL ANGLE	HORIZONTAL ANGLE			ZONAL LUMENS
		0°	45°	90°	
	0	4343	4343	4343	
	5	4200	4188	4202	385
	15	2875	2876	2855	777
	25	995	990	992	487
	35	290	293	308	198
	45	107	116	113	90
	55	48	53	49	46
	65	23	25	25	24
	75	10	10	11	11
	85	0	1	1	2
	90	0	0	0	

LUMEN SUMMARY	ZONE	LUMENS	% FIXTURE
	0 - 30	1648	82
	0 - 40	1847	91
	0 - 60	1983	98
	0 - 90	2021	100
	0 - 180	2021	100

4PS-L20/9DW-DIM-UNV-LN-OF-WH Total Luminaire Output: 1956 lumens; 37.7 Watts | Efficacy: 51.9 lm/W | 95.0 CRI; 3000K CCT

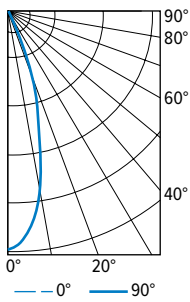

CANDLEPOWER DISTRIBUTION	VERTICAL ANGLE	HORIZONTAL ANGLE			ZONAL LUMENS
		0°	45°	90°	
	0	5104	5104	5104	
	5	4807	4766	4753	429
	15	2695	2727	2680	750
	25	831	904	883	427
	35	230	248	261	167
	45	99	105	108	83
	55	56	61	59	54
	65	27	32	30	30
	75	10	12	12	13
	85	0	1	1	2
	90	0	0	0	

LUMEN SUMMARY	ZONE	LUMENS	% FIXTURE
	0 - 30	1607	82
	0 - 40	1774	91
	0 - 60	1911	98
	0 - 90	1956	100
	0 - 180	1956	100

FLANGE TYPE DETAILS

1/2" STANDARD

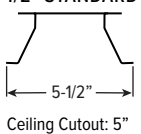

1/4" MUD-IN

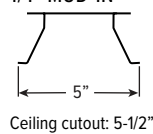

MUD FLANGE MOUNTING KIT (SLIM FLANGE TYPE)

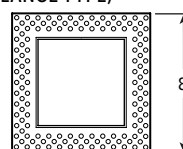
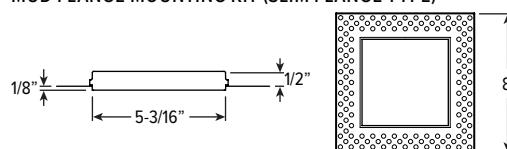

4PS dim to WARM 4.5" Shallow Plenum Downlight – Square

REFLECTOR FINISH DETAILS

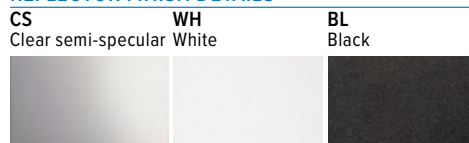

MOUNTING TYPE DETAILS

NEW CONSTRUCTION

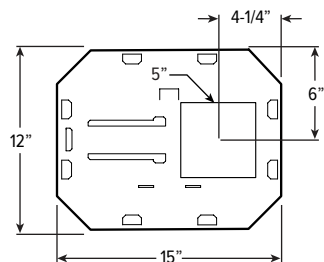

IC-RATED

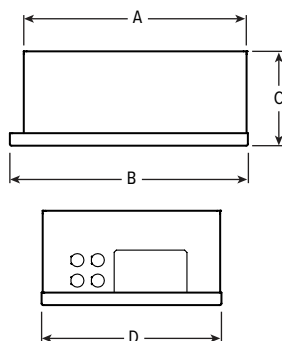

REMODEL

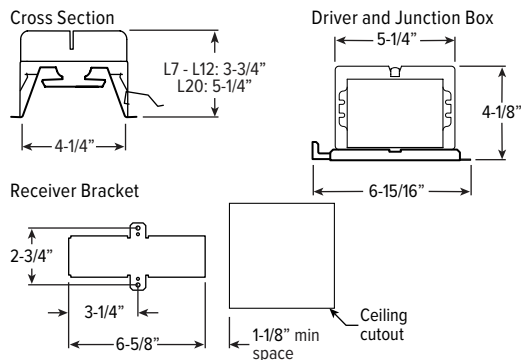

LUMENS	LENGTH			
	A	B	C	D
L7	15-1/16"	16"	4-1/2"	12-1/8"
L12	15-1/16"	16"	6-3/8"	12-1/8"

EM/10W/RTS DETAILS

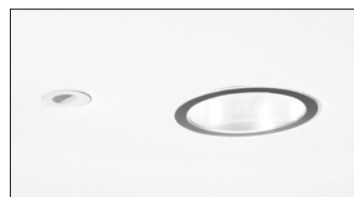

Shown Installed

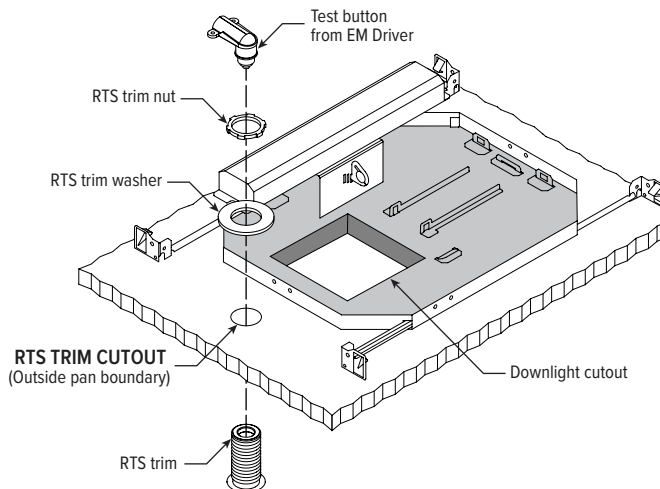

4PS dim to WARM 4.5" Shallow Plenum Downlight – Square

MOUNTING HARDWARE DETAILS

F1 Integral 2-position fixed pan bracket, universal bar hanger included

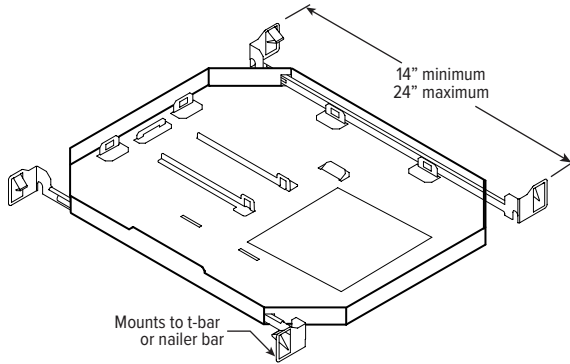

BA1 Adjustable butterfly pan bracket, bar hanger not included (N Mounting Type only)

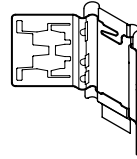

BA2 Adjustable butterfly pan bracket, heavy-duty universal bar hanger included (N Mounting Type only)

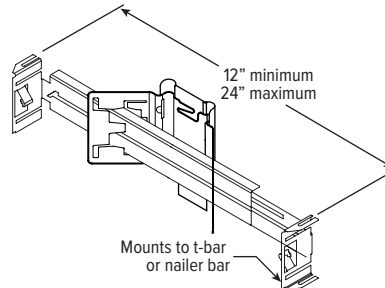

CA1 Adjustable caterpillar pan bracket, universal bar hanger included (N Mounting Type only)

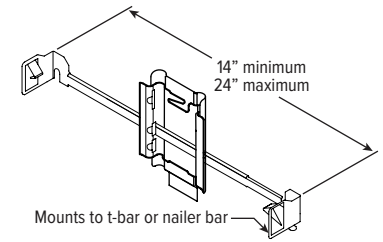

CA2 Adjustable caterpillar pan bracket, t-bar hanger included (N Mounting Type only)

