

4PS^{LED} 4.5" Shallow Plenum Downlight – Square

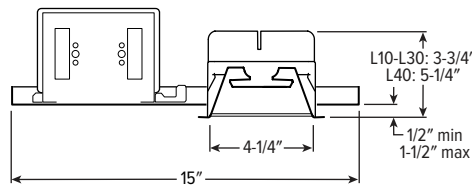

CATALOG #: _____

TYPE: _____

PROJECT: _____

NEW CONSTRUCTION AND REMODEL

ORDERING EXAMPLE: 4PS - L40/835 - OPTIONS - CONTROL/DIM - UNV - LW - OF - WH - TRIM OPTIONS - N - F1



HOUSING

SERIES	LUMENS ^[1]	CRI	CCT	OPTIONS	CONTROL	DRIVER	VOLTAGE
4PS	L10 1,000lm ^[2] L15 1,500lm L20 2,000lm L30 3,000lm L40 4,000lm	8 80 9 90 ^[3]	27 2700K 30 3000K 35 3500K 40 4000K 50 5000K	See page 3 for EMERGENCY BATTERY OPTIONS. ATH Airtight construction CP Chicago plenum (CCEA) ^[4] F Fuse kit SDT Stepdown transformer ^[5]	See page 6 for ADDITIONAL CONTROL/DRIVER OPTIONS. - None AVI-LVFA Avi-on wireless fixture control ^[6] AWNRLutron Athena wireless node integral fixture control, RF only ^[7]	See page 6 for ADDITIONAL CONTROL/DRIVER OPTIONS. DIM Dimming driver, 0-10V DIM1 1% Dimming driver, 0-10V DA Driver with 12V auxiliary power, without external dimming wires ^[8]	UNV 120-277V 347 347V ^[9]

TRIM^[10]

TRIM TYPE	DISTRIBUTION ^[11]	FLANGE TYPE	REFLECTOR FINISH	TRIM OPTIONS
L Flush lens	W 75° Wide M 35° Medium N 30° Narrow	OF 1/2" standard flange SF 1/4" mud-in flange ^[12]	CS Clear semi-specular powder coat WH White texture powder coat BL Black texture powder coat	IP IP65 rated trim AD Diffuse acrylic lens ^[13] PD Diffuse 1/8" polycarbonate lens ^[14] WET/CC Wet location, covered ceiling listed ^[15] AM Anti-microbial ^[16]

MOUNTING

MOUNTING TYPE ^[17]	MOUNTING HARDWARE ^[18]
N Open pan for new construction I IC-rated enclosure for new construction ^[19] R Remodel kit ^[20]	F1 Integral 2-position fixed pan bracket, universal bar hanger included ^[21] BA1 Adjustable butterfly pan bracket, bar hanger not included ^[22] CA1 Adjustable caterpillar pan bracket, universal bar hanger included ^[23]

NOTES

- ¹ Lumen output based on L trim type, W distribution and WH finish, 3500K/80CRI. Actual lumens may vary +/-5%. See page 2 for FIXTURE PERFORMANCE DATA.
- ² Not available with EM/10W emergency batteries.
- ³ Extended lead times may apply. Consult factory for availability.
- ⁴ I Mounting Type required.
- ⁵ May be required for 347V, see product builder at hew.com/product-builder.
- ⁶ DA Driver only. See page 6 for AVI-ON BLUETOOTH WIRELESS CONTROL DETAILS.
- ⁷ DA Driver only.
- ⁸ Avi-on and Lutron Athena Controls only.
- ⁹ Not available with EM batteries, DA or DMX Drivers.
- ¹⁰ Trim ships separately.
- ¹¹ Beam angle based on WH reflector finish.
- ¹² For use with mud-in plaster construction only, supplied with mud flange installation kit. See page 3 for FLANGE TYPE DETAILS. Not available with ATH or IP options.
- ¹³ Wide distribution only.
- ¹⁴ Wide distribution only.
- ¹⁵ Not available with PD trim option.
- ¹⁶ WH and BL Reflector Finishes only.
- ¹⁷ Mounting hardware required (N and I only), ordered separately, see MOUNTING HARDWARE ordering info. See page 4 for MOUNTING TYPE DETAILS.
- ¹⁸ Additional mounting hardware options available. See page 5 for MOUNTING HARDWARE DETAILS.
- ¹⁹ Not available with L30 and L40 lumen packages. Not available with EM batteries.
- ²⁰ Also used in new construction sheetrock ceilings. Pan-less installation. See page 3 for REGRESSED TEST SWITCH DETAILS.
- ²¹ N and I Mounting Types only. I Mounting requires external brackets.
- ²² N Mounting Type only.
- ²³ N Mounting Type only.



4PS^{LED} 4.5" Shallow Plenum Downlight – Square

FEATURES

- Beam angles ranging from 30° narrow to 75° wide for tailored performance
- 4 inch aperture is unobtrusive in small scale spaces
- Slim 5 inch depth for minimal plenum space applications
- Square shape accentuates architectural styles
- Spring clip retention system eliminates trim sag
- Die-cast trim with flush lens provides glare-free illumination for a soft ceiling appearance
- New construction mounting pan, IC-rated, or pan-less remodel kit available
- Fully room-side accessible
- Wireless in-fixture control solutions available

SPECIFICATIONS

- **HOUSING** – Formed steel housing with forged aluminum heat sink. Galvanized steel splice compartment with driver mounting plate/enclosure. Mounting clips allow for ceiling thickness from 1/2" – 1-1/2" (consult factory for additional ceiling thicknesses).
- **LENSED TRIM** – Die-cast aluminum frame with micro-prismatic, acrylic lens.
- **ELECTRICAL** – High-performance Class 2 C.O.B. LED array. Modular quick-connect plug for easy field-connection of LED light assembly to driver. Reported L70>55,000 hours. Reported L90>55,000 hours. Estimated L70 = 200,000 hours.
- **MOUNTING** – Recessed. 20 ga. galvanized steel mounting pan for new construction or IC-rated enclosure. Remodel kit option includes receiver bracket hardware. Minimum 24" O.C. marked spacing required for L40 lumen package.

- **LISTINGS** –
 - cCSAus conforms to UL STD 1598; Certified to CAN/CSA STD C22.2 No. 250.0 for dry and damp locations. LED light assembly conforms to UL 2108 for remote installation.
 - Suitable for wet location under covered ceiling when specified with WET/CC option.
 - IC-rated for direct contact with insulation when specified with I Mounting Type.
 - City of Chicago Environmental Air approved when specified with CP option.
 - Complies with ASTM-E283 when specified with ATH option.
 - RoHS compliant.
 - Complies with the Buy American Act and other federal regulations. Request certification at hew.com/baa.
- **WARRANTY** – 5-year limited warranty, see hew.com/warranty.

FIXTURE PERFORMANCE DATA

	DISTRIBUTION	DELIVERED LUMENS	WATTAGE	EFFICACY (lm/W)
L10	W	1029	10.7	96
	M	1064	10.7	99
	N	1030	10.7	96
L15	W	1581	17.2	92
	M	1634	17.2	95
	N	1581	17.2	92
L20	W	2058	23.5	88
	M	2127	23.5	91
	N	2059	23.5	88
L30	W	3087	33.2	93
	M	3191	33.2	96
	N	3088	33.2	93
L40	W	4116	44.7	92
	M	4261	44.7	95
	N	4122	44.7	92

MULTIPLIER TABLES

	COLOR TEMPERATURE	
	CCT	CONVERSION FACTOR
80 CRI	2700K	0.92
	3000K	0.98
	3500K	1.00
	4000K	1.01
90 CRI	5000K	1.02
	2700K	0.76
	3000K	0.79
	3500K	0.82
	4000K	0.84
	5000K	0.88

TRIM	
CATALOG NUMBER	CONVERSION FACTOR
AD	0.85
PD	0.85

- Photometrics tested in accordance with IESNA LM-79. Results shown are based on 25°C ambient temperature.
- Wattage shown is based on 120V input.
- Results based on L trim type, W distribution and WH finish. 3500K/80CRI, actual lumens may vary +/-5%
- To calculate lumen output in emergency mode, multiply the battery wattage by the efficacy.
- Use multiplier tables to calculate additional options.

PHOTOMETRY

4PS-L40/835-DIM-UNV-LW-OF-WH Report #: 20339; 04/25/18 | Total Luminaire Output: 4116 lumens; 44.7 Watts | Efficacy: 92 lm/W | 82.8 CRI; 3431K CCT

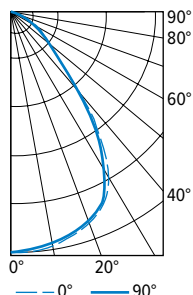

VERTICAL ANGLE	HORIZONTAL ANGLE			ZONAL LUMENS
	0°	45°	90°	
0	2316	2316	2316	
5	2315	2303	2302	220
15	2232	2221	2214	629
25	2087	2092	2065	964
35	1483	1764	1441	1016
45	667	1028	644	620
55	382	429	367	358
65	208	205	203	205
75	88	87	87	93
85	13	12	10	12
90	0	0	0	

LUMEN SUMMARY	ZONE	LUMENS	% FIXTURE
	0 - 30	1813	44
	0 - 40	2829	69
	0 - 60	3806	93
	0 - 90	4116	100
	0 - 180	4116	100

4PS-L40/835-DIM-UNV-LM-OF-WH Report #: 20341; 04/24/18 | Total Luminaire Output: 4261 lumens; 44.7 Watts | Efficacy: 95 lm/W | 82.8 CRI; 3431K CCT

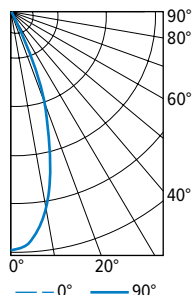

VERTICAL ANGLE	HORIZONTAL ANGLE			ZONAL LUMENS
	0°	45°	90°	
0	9143	9143	9143	
5	8842	8817	8847	842
15	6053	6054	6011	1714
25	2094	2085	2088	967
35	611	616	649	388
45	226	244	238	182
55	100	111	103	93
65	48	52	52	50
75	21	21	24	22
85	1	3	2	2
90	0	0	0	

LUMEN SUMMARY	ZONE	LUMENS	% FIXTURE
	0 - 30	3523	83
	0 - 40	3911	92
	0 - 60	4186	98
	0 - 90	4261	100
	0 - 180	4261	100



H.E. Williams, Inc.

Carthage, Missouri

www.hew.com

417-358-4065

Designed and Manufactured in the USA

Information contained herein is subject to change without notice.

REV.08/21/23.LA

Downlights
Page 2 of 6

4PS LED 4.5" Shallow Plenum Downlight – Square

4PS-L40/835-DIM-UNV-LN-OF-WH Report #: 20342; 04/24/18 | Total Luminaire Output: 4122 lumens; 44.7Watts | Efficacy: 92 lm/W | 82.8 CRI; 3431K CCT

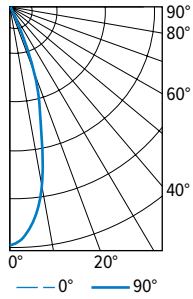

VERTICAL ANGLE	HORIZONTAL ANGLE			ZONAL LUMENS
	0°	45°	90°	
0	10746	10746	10746	
5	10121	10033	10007	958
15	5673	5741	5643	1618
25	1750	1904	1859	850
35	485	522	550	324
45	208	221	228	170
55	118	129	125	112
65	57	67	63	63
75	22	26	26	26
85	0	2	3	2
90	0	0	0	

LUMEN SUMMARY	ZONE	LUMENS	% FIXTURE
	0 - 30	3425	83
	0 - 40	3750	91
	0 - 60	4031	98
	0 - 90	4122	100
	0 - 180	4122	100

EMERGENCY BATTERY OPTIONS

Additional limitations apply, see page 1. Specify CEC in the option code when California Energy Commission regulations are required.

CATALOG NUMBER	DESCRIPTION
EM/7W	7-watt emergency battery ^[1]
EM/7W/RTS	7-watt emergency battery with regressed test switch ^[2]
EM/7W/IPRTS	7-watt emergency battery with IP65 rated regressed test switch
EM/10W	10-watt emergency battery ^[3]
EM/10W/RTS	10-watt emergency battery with regressed test switch ^[4]
EM/10W/IPRTS	10-watt emergency battery with IP65 rated regressed test switch ^[5]

- 1 Not available with IP Option.
- 2 Not available with IP or WET/CC Options.
- 3 Not available with L10 lumen package or IP Option.
- 4 Not available with L10 lumen package, IP or WET/CC Options.
- 5 Not available with L10 lumen package.

REGRESSED TEST SWITCH DETAILS

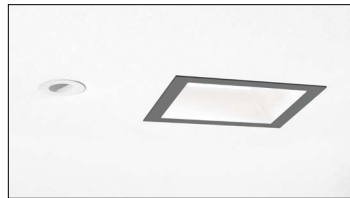

Shown Installed

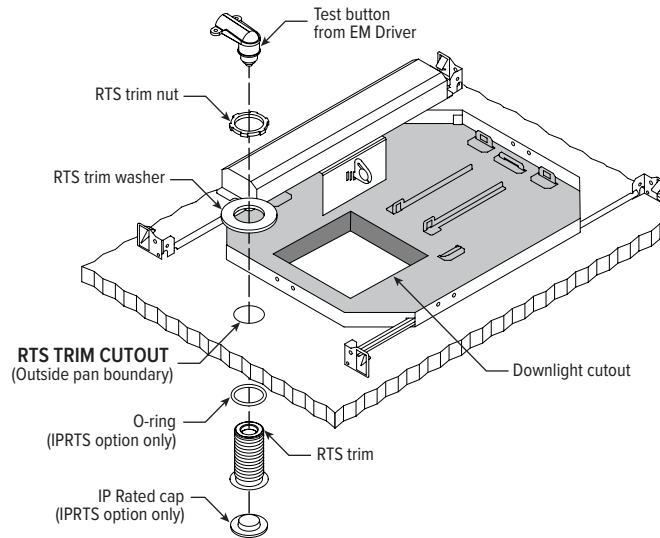

FLANGE TYPE DETAILS

1/2" STANDARD

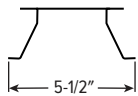

Ceiling Cutout: 5"

1/4" MUD-IN

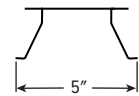

Ceiling cutout: 5-1/2"

MUD FLANGE MOUNTING KIT (SLIM FLANGE TYPE)

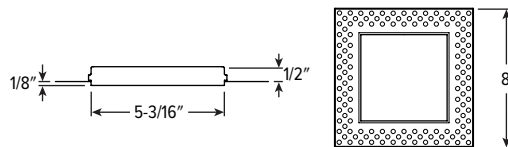

REFLECTOR FINISH DETAILS

CS
Clear semi-specular

WH
White

BL
Black

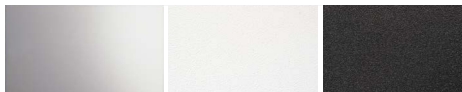

4PS LED 4.5" Shallow Plenum Downlight – Square

MOUNTING TYPE DETAILS

NEW CONSTRUCTION

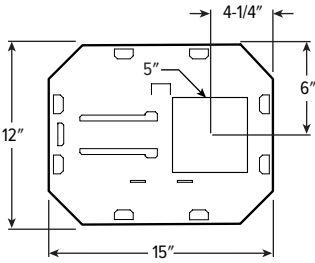

IC-RATED

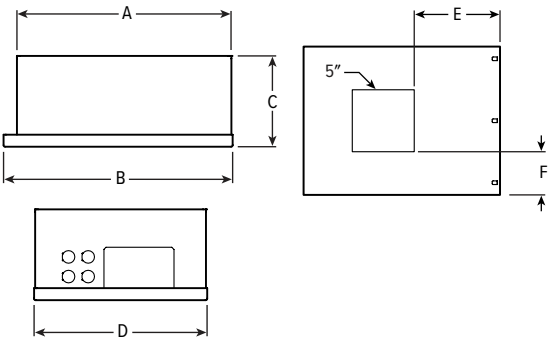

LUMENS	LENGTH					
	A	B	C	D	E	F
L10 - L20	15-1/16"	16"	4-1/2"	12-1/8"	7"	3-9/16"

REMODEL

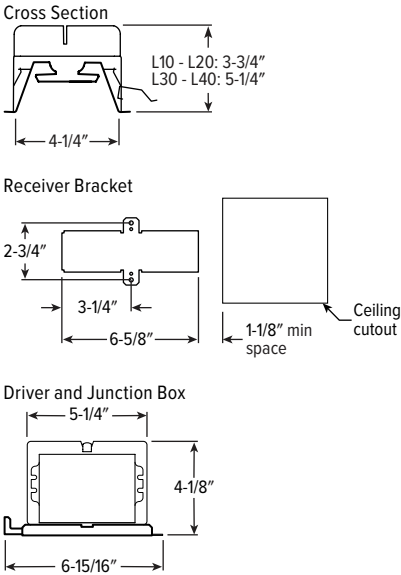

APERTURE ADAPTOR ORDERING INFO

ORDERING EXAMPLE: 4DR - GR - 0575 - WHT			
SERIES	CATALOG NUMBER	CEILING CUTOUT	FINISH
4AR 6AR 4DR 6DR 4DS 6DS 4PR 6PR 4PS 6PS 8DR	GR	Specify ceiling cutout in 1/8" increments. Example: 5.75" = 0575 See Kit Components for application limits.	CS Clear semi-specular powder coat WH White texture powder coat BL Black texture powder coat

For use with remodel downlights. Additional finishes available, consult factory.
For limitations and instructions, see hew.com/aperture-adaptor.pdf



4PS^{LED} 4.5" Shallow Plenum Downlight – Square

MOUNTING HARDWARE DETAILS

F1 Integral 2-position fixed pan bracket, universal bar hanger included

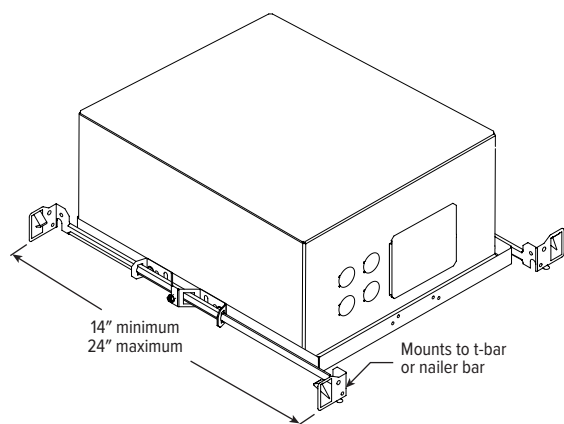
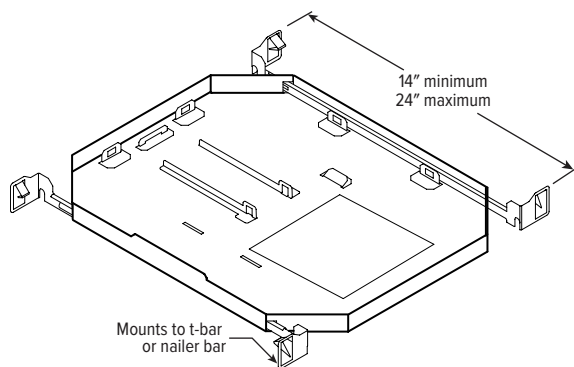

F1 with I Mounting Type

BA1 Adjustable butterfly pan bracket, bar hanger not included (N Mounting Type only)

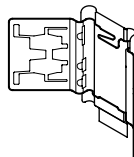

BA2 Adjustable butterfly pan bracket, heavy-duty universal bar hanger included (N Mounting Type only)

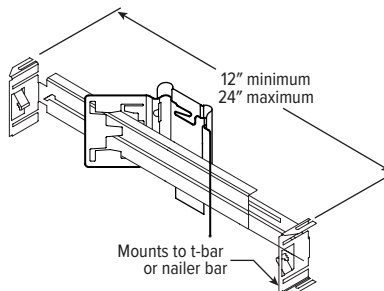

CA1 Adjustable caterpillar pan bracket, universal bar hanger included (N Mounting Type only)

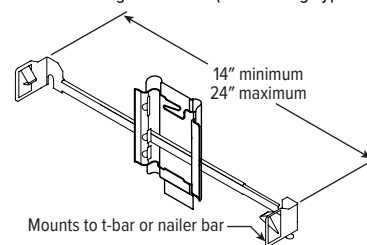

CA2 Adjustable caterpillar pan bracket, t-bar hanger included (N Mounting Type only)

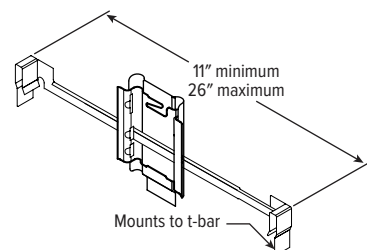

SEE NEXT PAGE FOR CONTROL DETAILS.



4PS LED 4.5" Shallow Plenum Downlight – Square

AVI-ON BLUETOOTH WIRELESS CONTROL DETAILS

FEATURES

Simple

- Gateway-free distributed control
- Factory pre-commissioning
- Contractor friendly installation
- Occupancy/vacancy/daylight sensing

Scalable

- Virtually unlimited network size
- Spans small offices to large warehouses
- Flexible control strategies

Secure

- Optional cloud connectivity
- UL IoT platinum security rating
- DLC 5.0 compliant

COMMISSIONING & INSTALLATION TOOLS

Avi-on mobile apps provide intuitive, quick installation and commissioning. Pro tools are available to qualified installers. Live commissioning training and on-site or remote support by Avi-on must be ordered separately through Avi-on.



Commissioning Mobile App



Zone Scanner Web App



Commissioning Pro App

SYSTEM COMPONENTS

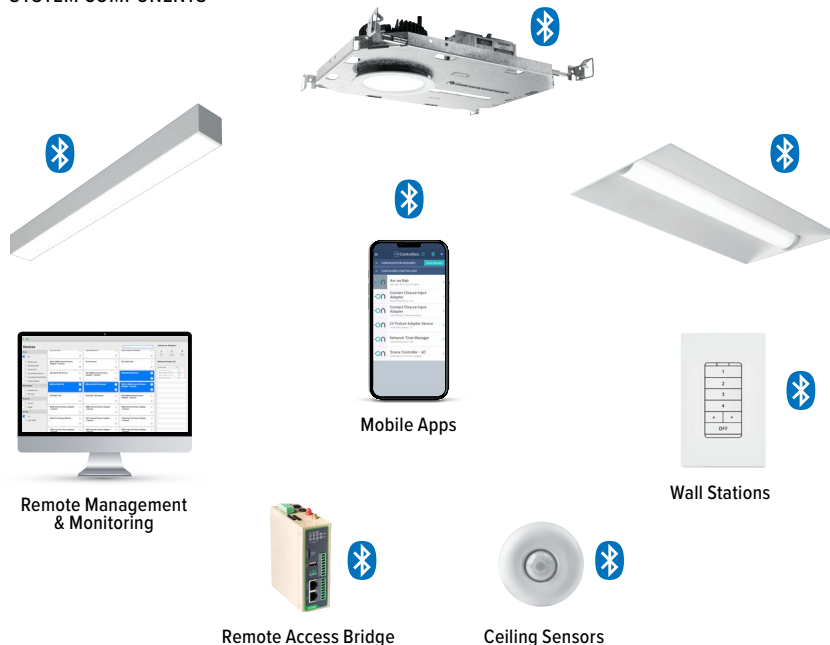

The Bluetooth® word mark and logos are registered trademarks owned by Bluetooth SIG, Inc. and any use of such marks by Avi-on is under license. Other trademarks and trade names are those of their respective owners.

ACCESSORIES

WALL STATIONS	
AVI-2401AC	Scene controller - numbered 1-4, 120-277VAC
AVI-2402BAT	Scene controller - numbered 1-4, battery powered
AVI-2401AC-2	Dimmer with presets - percentages, 120-277VAC
AVI-2402BAT-2	Dimmer with presets - percentages, battery powered
AVI-2401AC-3	On/off/dimming, 120-277VAC
AVI-2402BAT-3	On/off/dimming, battery powered

NETWORK	
AVI-RAB-LTE	Remote access bridge – LTE connection
AVI-2001RAB-01-C	Remote access bridge – Wifi connection
AVI-KIT-NTM	Network time manager with battery backup
CEILING MOUNT SENSORS	
AVI-KIT-SEN-DUCM	PIR motion and ultrasonic sensor kit
AVI-KIT-SEN-ICM	PIR motion and photocell sensor kit

For load controllers and additional accessory info, see hew.com/avi-on

ADDITIONAL CONTROL/DRIVER OPTIONS

Lumen restrictions apply: L30 max for DMX driver, L30 max for Lutron drivers, L40 max for DIM LINE driver. R mounting type requires top access with DMX controls. R Mounting Type not available with VRF or FCJS controls. 347V may require stepdown transformer, see product builder at hew.com/product-builder. I Mounting Type not available with Lutron controls.

CATALOG NUMBER	DESCRIPTION
AVI-LVFA/DA	Avi-on wireless fixture control for use with driver with 12V auxiliary power
VRF/DBI/LDE1	Lutron Vive integral fixture control, RF only (DFCSJ-OEM-RF) and digital link interface, with Lutron Hi-lume 1% EcoSystem dimming LED driver
FCJS/DIM	Lutron Vive PowPak wireless fixture control with dimming driver
FCJS/DIM1	Lutron Vive PowPak wireless fixture control with 1% dimming driver
DIM	Dimming driver prewired for 0-10V low voltage applications
DIM1	1% dimming driver prewired for 0-10V low voltage applications
DIM LINE	Line voltage dimming driver (TRIAC and ELV compatible at 120V only)
DALI	DALI dimming driver
DMX	0.1% dimming driver for DMX controls
LDE1	Lutron Hi-lume 1% EcoSystem dimming LED driver

