

STATIC TROFFER

50

T5 | T8

CATALOG #:	TYPE:
PROJECT:	NOTES:

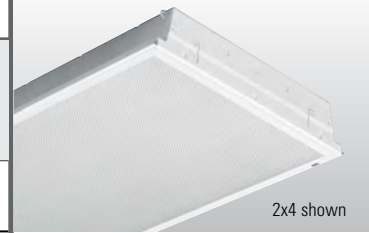

EXAMPLE

50 G - S 2 4 - 3 32 - S A12125 - OPTIONS - EB3 - UNV

SERIES CEILING TYPE FIX. NOM. NOM. TOTAL WATTAGE/ DOOR SHIELDING OPTIONS BALLAST VOLTAGE
TYPE STYLE W. L. LAMPS TYPE FRAME TYPE TYPE TYPE TYPE TYPE

CROSS SECTIONS

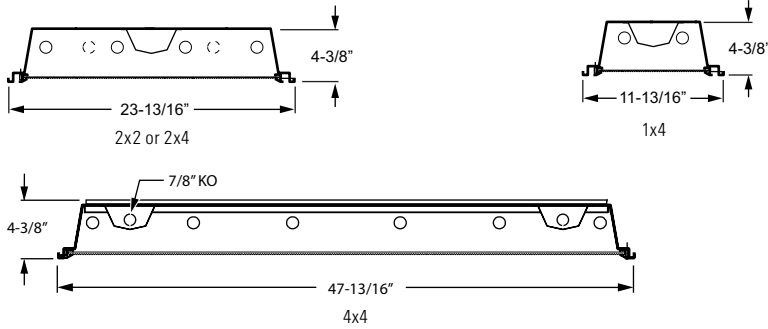

FEATURES

- ▶ Fully-enclosed spring-loaded cam latches allow years of hassle-free maintenance.
- ▶ T-slot steel hinge ensures positive retention when door is opened.
- ▶ 4-3/8" deep housing eliminates lens shadowing.
- ▶ Deep reinforcement ribs and rolled-edge channel provide added strength.
- ▶ Optional anti-microbial powder coating available to prevent the spread of dangerous micro-organisms and suppress the growth of mold and bacteria.
- ▶ Field convertible to NEMA Type "F".
- ▶ Fully gasketed door minimizes contaminants.
- ▶ All parts painted after fabrication to facilitate installation, increase efficiency, and inhibit corrosion.
- ▶ This fixture is proudly made in the USA.

ORDERING INFORMATION

SERIES
50 Static Troffer (no air handling)

CEILING TYPE
G NEMA Type "G"
F NEMA Type "F"

FIXTURE STYLE
S Full door frame—no reveal

NOMINAL WIDTH
1 1'
2 2'
4 4'

NOMINAL LENGTH
2 2' (2' width only)
4 4'

TOTAL LAMPS
2 (1' x 4' only)
2, 3, or 4 (2' x 2' only)
2, 3, 4, or 6 (2' x 4' only)
4, 6, or 8 (4' x 4' only)

LAMP WATTAGE/TYPE

2x2 LAMP OPTIONS
14T5S 2', 14-watt T5
17 2', 17-watt T8
24T5H 2', 24-watt T5HO
31UN 2', U-bent, 31-watt T8, 1-5/8" leg spacing
40TT 2', 40-watt long twin tube (2' x 2' only)
32U 2', U-bent, 32-watt T8, 6" leg spacing

1x4, 2x4, or 4x4 LAMP OPTIONS
28T5S 4', 28-watt T5
32 4', 32-watt T8
54T5H 4', 54-watt T5HO (4 lamps max. in 2' x 4')

DOOR FRAME
S White flat steel (not available for 4' x 4')
F White flat aluminum
R White regress aluminum
SB Black flat steel (not available for 4' x 4')
FB Black flat aluminum
RB Black regress aluminum

SHIELDING

1' or 2' WIDTHS
A12125 Acrylic, pattern #12, .125" thick
A19156 Acrylic, pattern #19, .156" thick
PC1SS Parabolic louver, silver styrene, nominal 1/2" x 1/2" x 1/2"
PC2SS Parabolic louver, silver styrene, nominal 1-1/2" x 1-1/2" x 1"

4' WIDTH
A12187 Acrylic, pattern #12, .187" thick
A19187 Acrylic, pattern #19, .187" thick

OPTIONS

For generic EM ballast options (must specify voltage), see [Technical Info](#).

For flexible whip options, see [Technical Info](#).

TP Tamper-resistant (flat aluminum door only)
DG Double gasket (flat aluminum door only)
TG Triple gasket (flat aluminum door only; field installed)

EQCLIPS Earthquake clips (4 per fixture)
HIEF High Efficiency (2x4 T8 only)
F338 6', 3/8" flex, 3-conductor, No. 18 AWG
AMW Anti-microbial white finish
CP Chicago Plenum (CCEA)

BALLAST TYPE

Additional ballast options available, see [Technical Info](#).

EB2 2-lamp electronic ballast
EB3 3-lamp electronic ballast
EB4 4-lamp electronic ballast
EB3/3 (2) 3-lamp electronic ballasts
EB4/4 (2) 4-lamp electronic ballasts

VOLTAGE
120 120V
277 277V
UNV 120-277V
347 347V



PHOTOMETRY

SPECIFICATIONS

Housing – 22-gauge die-formed C.R.S.
Door Frame – 20-gauge C.R.S. or .050" extruded aluminum, flat or regress, with mitered corners. T-slot steel hinge allows reversible hinging and latching. Fully enclosed spring-loaded cam latches.

Shielding – Acrylic, pattern #12, .125" thick (.187" thick for 4' x 4').

Finish – 92% minimum average reflective white polyester powder coat bonded to phosphate-free, multi-stage pretreated metal. All parts painted after fabrication to facilitate installation, increase efficiency, and inhibit corrosion.

Electrical – Electronic ballast standard, instant start T8, program start T5, rated Class P.

Mounting – NEMA Type "G" standard. NEMA Type "F" available.

Labels –

- UL/CUL listed as recessed fluorescent luminaire suitable for dry or damp locations.
- City of Chicago Environmental Air approved when specified with CP option.

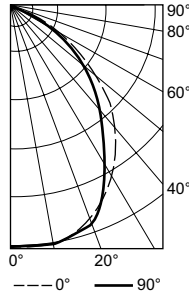

Vertical Angle	Horizontal Angle			Zonal Lumens
	0°	45°	90°	
0	1902	1902	1902	
5	1890	1888	1891	180.5
15	1849	1854	1856	526.1
25	1711	1703	1677	787.0
35	1436	1372	1288	859.2
45	1100	991	939	775.7
55	636	585	541	524.3
65	320	259	254	278.4
75	156	123	149	150.1
85	61	47	45	54.0
90	0	0	0	

Zone	Lumens	% Lamp	% Fixture
0 - 30	1494	25.3	36.1
0 - 40	2353	39.9	56.9
0 - 60	3653	61.9	88.3
0 - 90	4135	70.1	100.0
0 - 180	4135	70.1	100.0

ROOM CAVITY RATIO	ZONAL CAVITY COEFFICIENTS									
	Ceiling	.80			.70			.50		
	Wall	.70	.50	.30	.70	.50	.30	.50	.30	.10
0	.83	.83	.83	.81	.81	.81	.78	.78	.75	
1	.78	.75	.73	.76	.74	.71	.71	.67	.65	
2	.72	.67	.64	.70	.66	.63	.64	.58	.57	
3	.67	.61	.56	.65	.60	.55	.58	.51	.50	
4	.62	.55	.50	.61	.54	.49	.52	.45	.44	
5	.57	.49	.44	.56	.49	.43	.47	.39	.39	
6	.53	.45	.39	.52	.44	.39	.43	.35	.34	
7	.49	.41	.35	.48	.40	.35	.39	.31	.31	
8	.45	.37	.31	.44	.36	.31	.35	.27	.27	
9	.42	.33	.28	.41	.33	.27	.32	.24	.24	
10	.39	.30	.25	.38	.30	.25	.29	.21	.21	

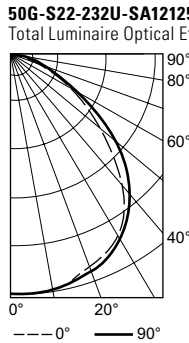

Vertical Angle	Horizontal Angle			Zonal Lumens
	0°	45°	90°	
0	1921	1921	1921	
5	1929	1913	1908	182.9
15	1858	1864	1880	529.4
25	1721	1750	1798	812.0
35	1458	1558	1607	971.3
45	1087	1117	1272	886.6
55	674	672	815	635.1
65	367	285	391	319.9
75	194	182	192	197.6
85	77	86	79	89.7
90	0	0	0	

Zone	Lumens	% Lamp	% Fixture
0 - 30	1524	26.7	33.0
0 - 40	2496	43.8	54.0
0 - 60	4017	70.5	86.9
0 - 90	4624	81.1	100.0
0 - 180	4624	81.1	100.0

ROOM CAVITY RATIO	ZONAL CAVITY COEFFICIENTS									
	Ceiling	.80			.70			.50		
	Wall	.70	.50	.30	.70	.50	.30	.50	.30	.10
0	.97	.97	.97	.94	.94	.94	.90	.90	.90	
1	.90	.86	.83	.88	.85	.82	.81	.79	.77	
2	.83	.77	.73	.81	.76	.71	.73	.69	.66	
3	.77	.69	.64	.75	.68	.63	.66	.61	.58	
4	.71	.62	.56	.69	.61	.56	.59	.54	.50	
5	.65	.56	.49	.64	.55	.49	.53	.48	.44	
6	.60	.51	.44	.59	.50	.44	.48	.43	.39	
7	.56	.46	.39	.55	.45	.39	.44	.38	.34	
8	.52	.41	.35	.50	.41	.34	.39	.34	.30	
9	.47	.37	.30	.46	.36	.30	.35	.30	.26	
10	.44	.37	.27	.43	.33	.27	.32	.27	.23	

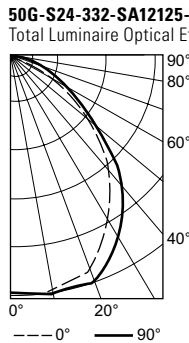

Vertical Angle	Horizontal Angle			Zonal Lumens
	0°	45°	90°	
0	2809	2809	2809	
5	2781	2778	2789	265.6
15	2740	2780	2820	788.4
25	2478	2589	2665	1194.5
35	2055	2198	2282	1372.1
45	1527	1643	1775	1275.1
55	935	956	1083	889.3
65	537	405	556	466.7
75	328	263	338	301.8
85	119	119	130	133.5
90	0	0	0	

Zone	Lumens	% Lamp	% Fixture
0 - 30	2248	26.3	33.6
0 - 40	3621	42.3	54.1
0 - 60	5785	67.7	86.5
0 - 90	6687	78.2	100.0
0 - 180	6687	78.2	100.0

ROOM CAVITY RATIO	ZONAL CAVITY COEFFICIENTS									
	Ceiling	.80			.70			.50		
	Wall	.70	.50	.30	.70	.50	.30	.50	.30	.10
0	.93	.93	.93	.91	.91	.91	.87	.87	.87	
1	.86	.83	.80	.84	.81	.79	.78	.76	.74	
2	.80	.74	.70	.78	.73	.69	.70	.67	.64	
3	.74	.67	.61	.72	.66	.61	.64	.59	.56	
4	.68	.60	.54	.67	.59	.54	.57	.52	.49	
5	.63	.54	.48	.62	.53	.47	.52	.46	.42	
6	.58	.49	.42	.57	.48	.42	.47	.41	.37	
7	.54	.44	.38	.53	.44	.37	.42	.37	.33	
8	.50	.40	.33	.49	.39	.33	.38	.33	.29	
9	.46	.36	.30	.45	.35	.29	.34	.29	.25	
10	.43	.33	.27	.42	.32	.26	.31	.26	.22	

PHOTOMETRY

50G-S24-232-SA12125-HIEF-EB2 Report #: 12329.1; 06/23/04 | Lamp Type: F32T8/835/RS; Lamp Quantity: 2
 Total Luminaire Optical Efficiency: 86.5%; IES Spacing Criteria: End = 1.2, Across = 1.4; Effective Floor Cavity Reflectance = .20

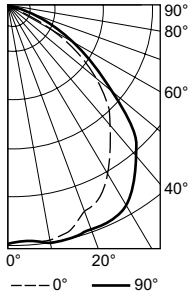

Vertical Angle	Horizontal Angle			Zonal Lumens
	0°	45°	90°	
0	1956	1956	1956	
5	1950	1950	1953	186.3
15	1918	1955	1990	554.0
25	1760	1868	1962	862.8
35	1468	1668	1794	1034.6
45	1182	1326	1487	1029.9
55	729	800	880	722.1
65	401	366	456	393.9
75	239	198	225	224.5
85	88	86	78	95.7
90	0	0	0	

Zone	Lumens	% Lamp	% Fixture
0 - 30	1603	27.2	31.4
0 - 40	2638	44.7	51.7
0 - 60	4390	74.4	86.0
0 - 90	5104	86.5	100.0
0 - 180	5104	86.5	100.0

ROOM CAVITY RATIO	ZONAL CAVITY COEFFICIENTS									
	Ceiling	.80			.70			.50		
	Wall	.70	.50	.30	.70	.50	.30	.50	.30	.10
0	1.03	1.03	1.03	1.01	1.01	1.01	.96	.96	.96	
1	.95	.92	.89	.93	.90	.87	.86	.84	.82	
2	.88	.82	.77	.86	.80	.76	.78	.74	.70	
3	.82	.74	.67	.80	.72	.67	.70	.65	.61	
4	.75	.66	.59	.73	.65	.59	.63	.57	.53	
5	.69	.59	.52	.67	.58	.51	.56	.50	.46	
6	.64	.53	.46	.62	.52	.46	.51	.45	.40	
7	.59	.48	.41	.57	.47	.40	.46	.40	.35	
8	.54	.43	.36	.53	.42	.36	.41	.35	.31	
9	.50	.38	.32	.49	.38	.31	.37	.31	.27	
10	.46	.35	.28	.45	.34	.28	.34	.28	.24	

50G-S24-332-SA12125-HIEF-EB3 Report #: 12252.1; 03/31/04 | Lamp Type: F32T8/835/RS; Lamp Quantity: 3
 Total Luminaire Optical Efficiency: 84.2%; IES Spacing Criteria: End = 1.3, Across = 1.3; Effective Floor Cavity Reflectance = .20

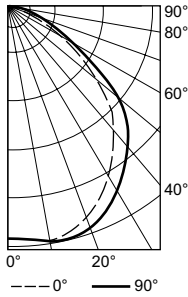

Vertical Angle	Horizontal Angle			Zonal Lumens
	0°	45°	90°	
0	2889	2889	2889	
5	2885	2890	2894	275.9
15	2901	2947	2991	835.2
25	2635	2738	2824	1265.6
35	2236	2396	2459	1486.8
45	1786	1921	2055	1486.6
55	1077	1145	1315	1051.0
65	601	544	645	580.2
75	321	288	355	327.0
85	115	125	132	139.6
90	14	23	23	

Zone	Lumens	% Lamp	% Fixture
0 - 30	2377	26.9	31.9
0 - 40	3864	43.7	51.9
0 - 60	6401	72.3	85.9
0 - 90	7448	84.2	100.0
0 - 180	7448	84.2	100.0

ROOM CAVITY RATIO	ZONAL CAVITY COEFFICIENTS									
	Ceiling	.80			.70			.50		
	Wall	.70	.50	.30	.70	.50	.30	.50	.30	.10
0	1.00	1.00	1.00	.98	.98	.98	.94	.94	.94	
1	.93	.89	.86	.91	.88	.85	.84	.82	.80	
2	.86	.80	.75	.84	.78	.74	.75	.72	.68	
3	.79	.72	.66	.77	.70	.65	.68	.63	.59	
4	.73	.64	.58	.71	.63	.57	.61	.56	.52	
5	.67	.57	.51	.66	.57	.50	.55	.49	.45	
6	.62	.52	.45	.61	.51	.44	.50	.44	.39	
7	.57	.47	.40	.56	.46	.39	.45	.39	.35	
8	.53	.42	.35	.52	.41	.35	.40	.34	.30	
9	.49	.38	.31	.47	.37	.31	.36	.30	.26	
10	.45	.34	.28	.44	.34	.27	.33	.27	.23	

50G-S44-632-RA12187-EB3/3 Report #: 8649.0; 02/21/96 | Lamp Type: F32T8/SPX35/RS; Lamp Quantity: 6
 Total Luminaire Optical Efficiency: 88.2%; IES Spacing Criteria: End = 1.2, Across = 1.4; Effective Floor Cavity Reflectance = .20

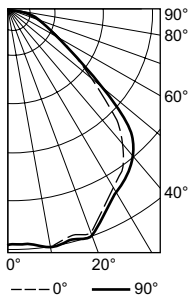

Vertical Angle	Horizontal Angle			Zonal Lumens
	0°	45°	90°	
0	6206	6206	6206	
5	6213	6179	6213	591.7
15	6179	6213	6274	1764.6
25	5644	5825	5929	2693.8
35	4860	5214	5446	3260.3
45	3671	3998	4619	3174.8
55	1947	2197	2430	1998.3
65	1111	1085	1223	1101.8
75	698	689	715	738.0
85	284	249	293	292.0
90	0	0	0	

Zone	Lumens	% Lamp	% Fixture
0 - 30	5050	28.5	32.3
0 - 40	8310	47.0	53.2
0 - 60	13484	76.2	86.3
0 - 90	15615	88.2	100.0
0 - 180	15615	88.2	100.0

ROOM CAVITY RATIO	ZONAL CAVITY COEFFICIENTS									
	Ceiling	.80			.70			.50		
	Wall	.70	.50	.30	.70	.50	.30	.50	.30	.10
0	1.05	1.05	1.05	1.03	1.03	1.03	.98	.98	.98	
1	.97	.94	.91	.95	.92	.89	.88	.86	.84	
2	.90	.84	.79	.88	.82	.78	.79	.75	.72	
3	.83	.75	.69	.81	.74	.68	.71	.67	.62	
4	.77	.68	.61	.75	.67	.60	.64	.59	.55	
5	.71	.61	.53	.69	.60	.53	.58	.52	.47	
6	.66	.55	.48	.64	.54	.47	.52	.46	.42	
7	.61	.49	.42	.59	.49	.42	.47	.41	.37	
8	.56	.44	.37	.54	.44	.37	.43	.36	.32	
9	.51	.40	.33	.50	.39	.33	.38	.32	.28	
10	.48	.36	.29	.47	.36	.29	.35	.29	.25	



FIXTURE DETAILS

1x4 BACK VIEW

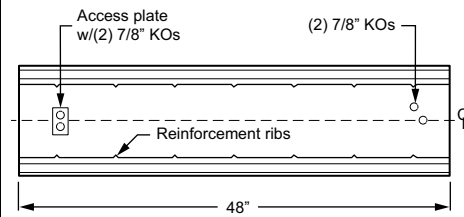

1x4 NEMA TYPE "F" INSTALLATION

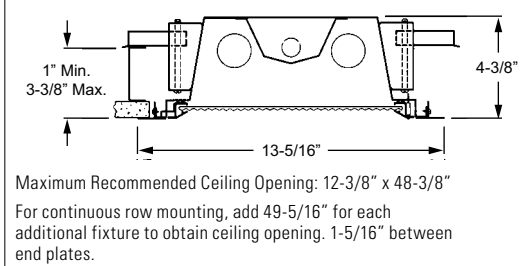

2x2 | 2x4 BACK VIEW

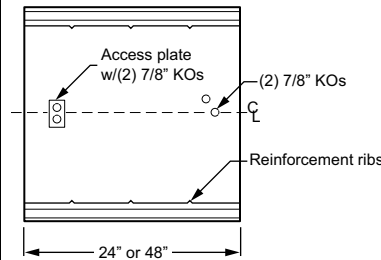

4x4 BACK VIEW

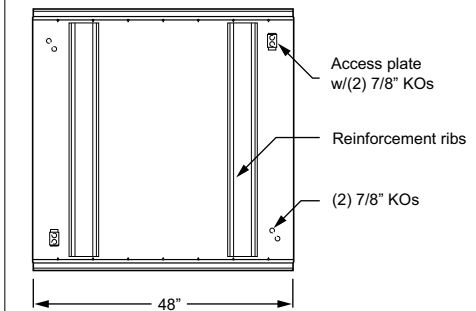

2x2 | 2x4 NEMA TYPE "F" INSTALLATION

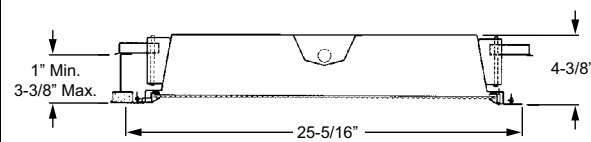

2' x 2' Max. Recommended Ceiling Opening:
24-3/8" x 24-3/8"

2' x 4' Max. Recommended Ceiling Opening:
24-3/8" x 48-3/8"

For 2'x4' continuous row mounting, add 49-5/16" for each additional fixture to obtain ceiling opening. 1-5/16" between end plates.

4x4 NEMA TYPE "F" INSTALLATION

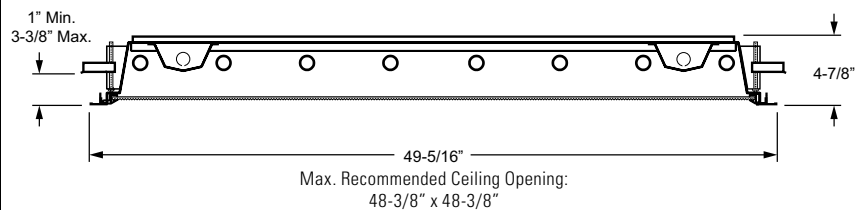

DOUBLE GASKETING (DG)

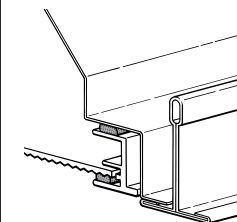

Gasketing is factory-installed continuously between door frame and luminaire housing; and between door frame and lens.

TRIPLE GASKETING (TG)

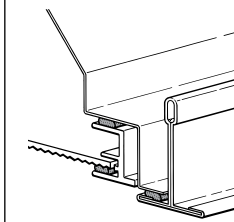

Gasketing is factory-installed continuously between door frame and luminaire housing; and between door frame and lens. Gasketing between bottom perimeter of unit (adjacent to T-bar or hardpan ceiling) is provided by factory and field installed.