

CORNER LIGHT

CL

T5 | T8

CATALOG #:

TYPE:

PROJECT:

NOTES:

EXAMPLE

CL - 4 - 3 32 - F A12125 - OPTIONS - EB3 - UNV

SERIES NOMINAL LENGTH TOTAL WATTAGE/ LAMPS TYPE DOOR FRAME SHIELDING OPTIONS/ ACCESSORIES BALLAST TYPE VOLTAGE



CROSS SECTION

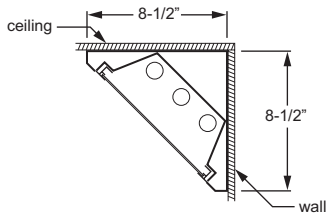

ORDERING INFORMATION

SERIES

CL Corner Light

NOMINAL LENGTH

4 4'

TOTAL LAMPS

1, 2, or 3

LAMP WATTAGE/TYPE

28T5S 4', 28-watt T5
32 4', 32-watt T8
54T5H 4', 54-watt T5HO

DOOR FRAME

F White flat aluminum
R White regress aluminum
FB Black flat aluminum
RB Black regress aluminum

SHIELDING

A12125 Acrylic, pattern #12, .125" thick
A19156 Acrylic, pattern #19, .156" thick

OPTIONS

For generic EM ballast options (must specify voltage), see [Technical Info.](#)

AMW Anti-microbial white finish
DG Double gasket (flat aluminum door only)
TP Tamper-resistant screws. This option requires a tamper-resistant tool (must be ordered separately). Please specify quantity required per project.

ACCESSORIES

WG-CL-4 Wireguard, 14-gauge, white, 4'

BALLAST TYPE

EB1 1-lamp electronic ballast
EB2 2-lamp electronic ballast
EB3 3-lamp electronic ballast
EB2/1 (1) 2-lamp and (1) 1-lamp electronic ballast

VOLTAGE

120 120V
277 277V
UNV 120-277V
347 347V

FEATURES

- ▶ Wall or ceiling mount adds versatility.
- ▶ Available with T5 or T8 lamps for design flexibility.
- ▶ Optional anti-microbial powder coating available to prevent the spread of dangerous micro-organisms and suppress the growth of mold and bacteria.
- ▶ Welded end plates for crisp, clean appearance.
- ▶ Fully enclosed spring-loaded cam latches.
- ▶ This fixture is proudly made in the USA.



PHOTOMETRY

CL-4-332-FA12125 Report #: 13698.0; 10/25/07; Lamp Type: F32T8/835; Lamp Quantity: 3;
Total Luminaire Optical Efficiency: 69.8%; Effective Floor Cavity Reflectance = .20

SPECIFICATIONS

- Housing** – 20-gauge die-formed C.R.S.
- Reflective Surfaces** – 92% minimum average reflective white polyester powder coat on interior components.
- Shielding** – Patterned acrylic, .125" or .156" thick.
- Finish** – 92% minimum average reflective white polyester powder coat bonded to phosphate-free, multi-stage pretreated metal. All parts painted after fabrication to facilitate installation, increase efficiency, and inhibit corrosion.
- Electrical** – Electronic ballast standard, instant start T8, program start T5, rated Class P.
- Mounting** – Wall or ceiling mount.
- Labels** – UL/CUL listed as fluorescent luminaire suitable for dry or damp locations.

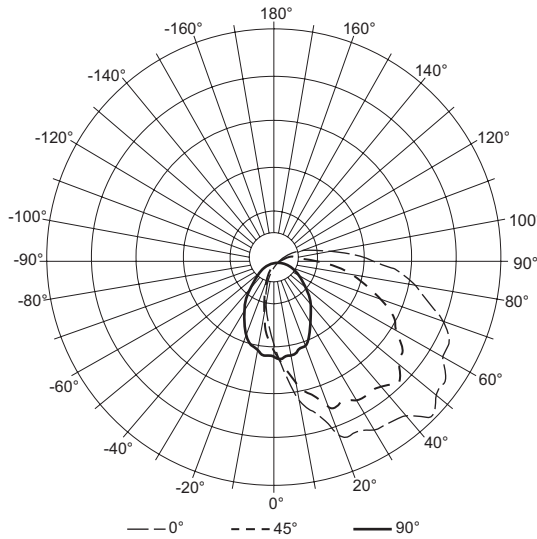

Vertical Angle	Horizontal Angle					Zonal Lumens
	0°	45°	90°	135°	180°	
0	1365	1365	1365	1365	1365	
5	1696	1570	1325	1155	1049	129.9
15	2239	1942	1254	759	609	382.1
25	2627	2174	1073	424	375	595.7
35	2745	2244	817	273	198	743.5
45	3067	2404	594	172	28	887.7
55	2873	2135	374	22	0	895.1
65	2651	1795	260	0	0	825.1
75	2169	1268	178	0	0	655.4
85	1718	844	61	0	0	477.9
90	1388	623	0	0	0	
95	1161	435	0	0	0	313.4
105	651	244	0	0	0	155.5
115	402	197	0	0	0	76.2
125	241	39	0	0	0	42.6
135	42	0	0	0	0	0
145	0	0	0	0	0	0
155	0	0	0	0	0	0
165	0	0	0	0	0	0
175	0	0	0	0	0	0
180	0	0	0	0	0	

		ZONAL CAVITY COEFFICIENTS									
		Ceiling			Wall			Floor			
		.80	.70	.50	.80	.70	.50	.80	.70	.50	.20
ROOM CAVITY RATIO	0	.82	.82	.82	.79	.79	.79	.74	.74	.74	.22
	1	.73	.69	.65	.70	.66	.63	.62	.59	.57	.22
	2	.65	.59	.53	.63	.57	.52	.53	.49	.45	.22
	3	.59	.51	.45	.57	.50	.44	.47	.42	.38	.22
	4	.54	.45	.38	.52	.44	.37	.41	.36	.31	.22
	5	.49	.39	.33	.47	.38	.32	.36	.30	.26	.22
	6	.45	.35	.28	.43	.34	.28	.32	.26	.22	.22
	7	.41	.31	.25	.40	.30	.24	.29	.23	.19	.22
	8	.38	.28	.22	.36	.27	.21	.26	.20	.16	.22
	9	.35	.25	.19	.33	.24	.18	.23	.18	.14	.22
	10	.32	.23	.17	.31	.22	.17	.21	.16	.12	.22

Zone	Lumens	% Lamp	% Fixture
0 - 30	1108	12.5	17.9
0 - 40	1851	20.9	30.0
0 - 60	3634	41.1	58.8
0 - 90	5592	63.2	90.5
90 - 120	545	6.2	8.8
90 - 130	588	6.6	9.5
90 - 150	588	6.6	9.5
90 - 180	588	6.6	9.5
0 - 180	6180	69.8	100.0

FIXTURE DETAILS

FOOTCANDLE ESTIMATOR

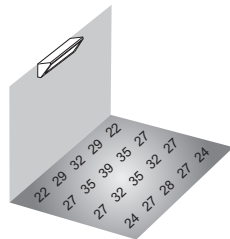

Footcandle calculations based on standard reflectance of 80/50/20 and a light loss factor of .85.

Fixture installed at 8' mounting height in 8' x 10' room.

BACKVIEW

