

MEDIUM SHALLOW-BACK WALL PACK

WP1

SUBMITTAL:

CFL

JOB:

TYPE:

VOLTAGE:

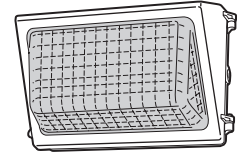

EXAMPLE: WP1 - 1 42T - GX24q-4 - OPTIONS - UNV

SERIES #OF LAMPS LAMP WATTAGE LAMP BASE OPTIONS/ACCESSORIES VOLTAGE

SERIES

FEATURES

- ▶ Overall dimensions: 14-1/4" x 9-1/16" x 7-1/4".
- ▶ Dark bronze finish standard. Black or white finish available.
- ▶ Wet location listed.
- ▶ Fully gasketed side-hinging door.
- ▶ Horizontal lamp position and specular aluminum faceted reflector provide good forward and lateral distribution of illumination.
- ▶ Optional stainless steel wireguard, cutoff shields, and vandal shield available.
- ▶ 1/2" NPS threaded hub and plugged conduit entry points.

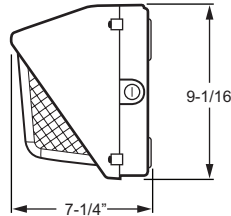

WP1 SERIES

HOUSING — Die-cast aluminum.
REFLECTIVE SURFACES — Anodized aluminum reflector.
LENS — Impact-resistant prismatic borosilicate glass refractor.

LAMP OPTIONS (Must specify)

COMPACT FLUORESCENT

# LAMPS	WATTAGE	LAMP BASE
1, 2	26W	G24q-3
1, 2	32W	GX24q-3
1, 2	42W	GX24q-4

OPTIONS

SF	Single Fuse (120V, 277V, or 347V only; must specify voltage)	DF	Double Fuse (208V or 240V only; must specify voltage)
GMF	HLR-GMF Style Slow Blow Fuse (Factory installed inside of unit. 120V and 277V only; must specify voltage)	PC	Factory-installed Photocell (120V, 208V and 277V only, must specify voltage)
BLK	Black Finish (RAL #9004)	WHT	White Finish (RAL #9003)

ACCESSORIES (Only one lens-mounted accessory per fixture)



FCS
Full Cutoff Shield



SCS
Side Cutoff Shield



PVS
Polycarbonate Vandal Shield



WG
Stainless Steel Wireguard

ACCESSORIES

Fixture is designed to accommodate only one lens-mounted accessory.

VOLTAGE (Must specify)

120	120V	208	208V
240	240V	277	277V
347	347V	UNV	120-277V

FINISH

Powder coated finish on heavy-duty die-cast housing. Bronze finish standard. Black or white finish available.

CFL

MOUNTING

MOUNTING

Wall mounts directly over a 4" maximum recessed outlet box.

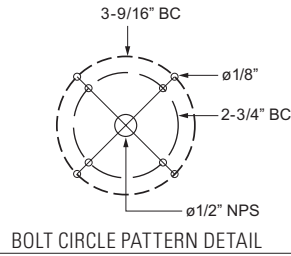
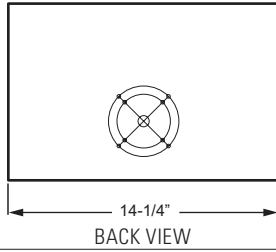

LABELS

cCSAus Certified as luminaire suitable for wet locations.

