

# 6AR tunable WHITE 6" Adjustable Downlight – Round

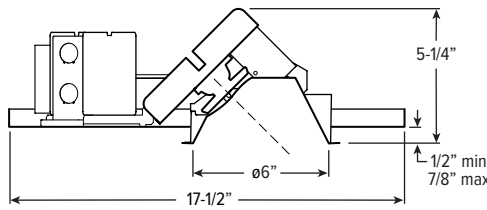

CATALOG #: \_\_\_\_\_

TYPE: \_\_\_\_\_

PROJECT: \_\_\_\_\_

## NEW CONSTRUCTION AND REMODEL

### FEATURES

- Tunable white from 2700K to 5000K CCT, minimum 80 CRI
- Adjustable aim with 0° - 45° tilt and 360° rotation
- Beam angles ranging from 25° narrow to 55° wide for tailored performance
- Etched degree markers and directional indicator make it simple to fine-tune the illumination angle
- Spring clip retention system eliminates trim sag
- Choice of open reflector or die-cast lensed trims to complement interior style
- Contemporary design provides glare-free illumination for a soft ceiling appearance
- Fully room-side accessible

### SPECIFICATIONS

- HOUSING** – Die-cast aluminum spun and stamped articulating mechanism with forged aluminum heat sink. Galvanized steel splice compartment with driver mounting plate/enclosure. Mounting clips allow for ceiling thickness from 1/2" - 7/8".
- OPEN REFLECTOR** – Low-iridescent anodized aluminum. Clear semi-specular finish standard.
- LENSED TRIM** – Die-cast aluminum frame with micro-prismatic, tempered glass lens.
- ELECTRICAL** – High-performance Class 2 LED array. Modular quick-connect plug for easy field-connection of LED light assembly to driver. Reported L70>50,000 hours. Tunable White products use LEDs of multiple CCTs and may produce a perceptibly different shade of white from single-CCT products at the same CCT. All CCTs are within 3 MacAdam ellipses.
- MOUNTING** – Recessed. 20 ga. galvanized steel mounting pan for new construction or IC-rated enclosure. Remodel kit option includes receiver bracket hardware. N and R mounting types for use in non-fire rated installations only.
- LISTINGS** –
  - cCSAus conforms to UL STD 1598; Certified to CAN/CSA STD C22.2 No. 250.0 for damp locations. LED light assembly conforms to UL 2108 for remote installation.
  - Suitable for wet location under covered ceiling when specified with WET/CC option.
  - IC-rated for direct contact with insulation when specified with I Mounting Type.
  - City of Chicago Environmental Air approved when specified with CP option.
  - Complies with ASTM-E283 when specified with ATH option.
  - RoHS compliant.
- WARRANTY** – 5-year limited warranty, see [hew.com/warranty](http://hew.com/warranty).

ORDERING EXAMPLE: 6AR - L12/8TW - OPTIONS - DIM - UNV - OW - OF - CS - TRIM OPTIONS - N - F1

### HOUSING

SERIES	LUMENS <sup>(1)</sup>	COLOR	OPTIONS	CONTROL	VOLTAGE	
6AR	L12 1,200lm	8TW Tunable white (80 CRI, 2700K-5000K)	EM/7W	7-watt emergency battery <sup>(2)</sup>	UNV 120-277V	
	L20 2,000lm		EM/10W	10-watt emergency battery <sup>(3)</sup>		
			EM/10W/RTS	10-watt emergency battery with regressed test switch <sup>(4)</sup>	DIM	Dimming driver with (1) 0-10V signal to control dimming and (1) 0-10V signal to control CCT
			ATH	Airtight construction <sup>(5)</sup>	DMX	Driver prewired for DALI applications
			CP	Chicago plenum (CCEA) <sup>(6)</sup>		Dimming driver with (1) 0-10V signal to control dimming and (1) 0-10V signal to control CCT
		F	Fuse kit		Driver prewired for DMX applications	

### TRIM <sup>(7)</sup>

TRIM TYPE	DISTRIBUTION <sup>(8)</sup>	FLANGE TYPE	REFLECTOR FINISH	TRIM OPTIONS
O Open reflector	W Wide	OF 1/2" standard flange	Open trim types	MWT Textured white trim flange <sup>(11)</sup>
L Flush lens	55° Open	SF 1/4" mud-in flange <sup>(10)</sup>	CS Clear semi-specular anodize	AD Diffuse acrylic lens <sup>(12)</sup>
A Angled lens	55° Flush		WH White texture powder coat	PD Diffuse 1/8" polycarbonate lens <sup>(13)</sup>
	50° Angled		BL Black texture powder coat	WET/CC Wet location, covered ceiling listed <sup>(14)</sup>
	M Medium		CS Clear semi-specular powder coat	AM Anti-microbial <sup>(15)</sup>
	35° Open		WH White texture powder coat	
	35° Flush		BL Black texture powder coat	
	35° Angled			
	N Narrow <sup>(9)</sup>			
	25° Flush			
	30° Angled			

### MOUNTING

#### MOUNTING TYPE <sup>(16)</sup>

- N Open pan for new construction
- I IC-rated enclosure for new construction
- R Remodel kit <sup>(18)</sup>

#### MOUNTING HARDWARE <sup>(17)</sup>

- F1 Factory-installed 2-position fixed pan bracket, universal bar hanger included <sup>(19)</sup>
- BA1 Adjustable butterfly pan bracket, bar hanger not included <sup>(20)</sup>
- CA1 Adjustable caterpillar pan bracket, universal bar hanger included <sup>(21)</sup>

### NOTES

- Lumen output based on O trim type, M distribution and CS finish, 4000K/80CRI. Actual lumens may vary +/-5%. See page 2 for FIXTURE PERFORMANCE DATA.
- N and R Mounting Types only.
- N and R Mounting Types only.
- Not available with WET/CC or ATH options. N and R Mounting Types only. See page 4 for EM/10W/RTS DETAILS.
- I Mounting Type required.
- I Mounting Type required
- Trim ships separately
- Beam angle based on CS or WH reflector finish.
- L and A Trim Types only.
- For use with mud-in plaster construction only, supplied with mud flange installation kit. See page 3 for FLANGE TYPE DETAILS. Not available with ATH option

<sup>11</sup> Not available with WH Reflector Finish or L Trim Type.

<sup>12</sup> L and A Trim Types only. W distribution only.

<sup>13</sup> L and A Trim Types only. W distribution only.

<sup>14</sup> L Trim Type only

<sup>15</sup> WH and BL Reflector Finishes only.

<sup>16</sup> Mounting hardware required (N and I only), ordered separately, see MOUNTING HARDWARE ordering info. See page 4 for MOUNTING TYPE DETAILS.

<sup>17</sup> Additional mounting hardware options available. See page 5 for MOUNTING HARDWARE DETAILS.

<sup>18</sup> Also used for new construction sheetrock ceilings.

<sup>19</sup> N and I Mounting Types only. Universal bar hanger ships uninstalled

<sup>20</sup> N Mounting Type only

<sup>21</sup> N Mounting Type only



# 6AR tunable WHITE 6" Adjustable Downlight – Round

## FIXTURE PERFORMANCE DATA

### OPEN REFLECTOR TRIM TYPE

	DIST.	DELIVERED LUMENS	WATTAGE	EFFICACY (lm/W)
L12	W	1180	14.6	80.8
	M	1228	14.6	84.1
	N	-	-	-
L20	W	1985	24.0	82.7
	M	2027	24.0	84.5
	N	-	-	-

### FLUSH LENS TRIM TYPE

	DISTRIBUTION	DELIVERED LUMENS	WATTAGE	EFFICACY (lm/W)
L12	W	1065	14.6	72.9
	M	1141	14.6	78.2
	N	1133	14.6	77.6
L20	W	1771	24.0	73.8
	M	1877	24.0	78.2
	N	1793	24.0	74.7

- Photometrics tested in accordance with IESNA LM-79. Results shown are based on 25°C ambient temperature.
- Wattage shown is based on 120V input.
- Results based on 4000K, 80 CRI, 0° tilt, actual lumens may vary +/-5%
- Use multiplier tables to calculate additional options.

### ANGLED LENS TRIM TYPE

	DIST.	DELIVERED LUMENS	WATTAGE	EFFICACY (lm/W)
L12	W	887	14.6	60.8
	M	1058	14.6	72.5
	N	1080	14.6	74.0
L20	W	1475	24.0	61.5
	M	1728	24.0	72.0
	N	1693	24.0	70.5

### MULTIPLIER TABLES

COLOR TEMPERATURE		
CCT	LUMENS	WATTS
2700K	0.83	1.03
3000K	1.00	1.00
3500K	0.99	0.99
4000K	1.00	1.00
5000K	0.98	1.03

OPEN REFLECTOR FINISH	
CATALOG NUMBER	CONVERSION FACTOR
CS	1.00
WH	0.89
BL	0.79

TRIM	
CATALOG NUMBER	CONVERSION FACTOR
AD <sup>1</sup>	0.85
PD <sup>1</sup>	0.85

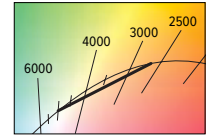

<sup>1</sup> Distribution will also be affected, consult factory.

## PHOTOMETRY

**6AR-L12/8TW-DIM-UNV-OW-OF-CS (25° tilt)** Total Luminaire Output: 1104 lumens; 14.6 Watts | Efficacy: 75.6 lm/W | 80.0 CRI; 4037K CCT

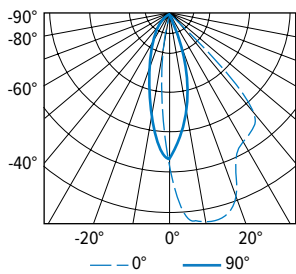

VERTICAL ANGLE	HORIZONTAL ANGLE					ZONAL LUMENS
	0°	45°	90°	135°	180°	
0	1459	1459	1459	1459	1459	
5	2038	1796	1292	900	726	121
15	2134	1593	740	248	174	263
25	1635	1424	303	68	52	306
35	1452	1068	61	15	11	281
45	949	119	6	3	3	126
55	11	1	0	0	1	7
65	0	0	0	0	0	0
75	0	0	0	0	0	0
85	0	0	0	0	0	0
90	0	0	0	0	0	0

LUMEN SUMMARY	ZONE	LUMENS	% FIXTURE
	0 - 40	971	88
	0 - 60	1104	100
	0 - 90	1104	100
	0 - 180	1104	100

**6AR-L12/8TW-DIM-UNV-OM-OF-CS (25° tilt)** Total Luminaire Output: 1093 lumens; 14.6 Watts | Efficacy: 74.9 lm/W | 80.0 CRI; 4037K CCT

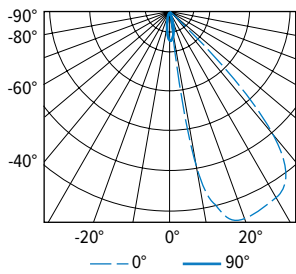

VERTICAL ANGLE	HORIZONTAL ANGLE					ZONAL LUMENS
	0°	45°	90°	135°	180°	
0	491	491	491	491	491	
5	1190	816	415	244	199	58
15	3461	1340	207	88	74	239
25	3511	992	87	37	30	365
35	3221	362	33	7	4	325
45	685	81	3	0	0	98
55	20	0	0	0	0	6
65	0	0	0	0	0	0
75	0	0	0	0	0	0
85	0	0	0	0	0	0
90	0	0	0	0	0	0

LUMEN SUMMARY	ZONE	LUMENS	% FIXTURE
	0 - 40	988	91
	0 - 60	1093	100
	0 - 90	1093	100
	0 - 180	1093	100

**6AR-L12/8TW-DIM-UNV-LM-OF-WH (25° tilt)** Total Luminaire Output: 1050 lumens; 14.6 Watts | Efficacy: 71.9 lm/W | 80.0 CRI; 4037K CCT

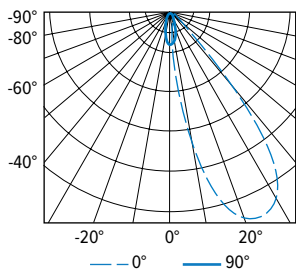

VERTICAL ANGLE	HORIZONTAL ANGLE					ZONAL LUMENS
	0°	45°	90°	135°	180°	
0	471	471	471	471	471	
5	1229	887	439	259	198	58
15	2789	1378	245	97	80	220
25	3217	1088	114	55	50	333
35	2307	474	54	37	40	269
45	667	124	27	31	37	110
55	137	32	18	25	31	38
65	30	12	11	16	21	16
75	10	5	4	7	11	7
85	0	0	0	0	0	0
90	0	0	0	0	0	0

LUMEN SUMMARY	ZONE	LUMENS	% FIXTURE
	0 - 40	879	84
	0 - 60	1027	98
	0 - 90	1050	100
	0 - 180	1050	100



# 6AR tunable WHITE 6" Adjustable Downlight – Round

6AR-L12/8TW-DIM-UNV-LN-OF-WH (25° tilt) Total Luminaire Output: 1130 lumens; 14.6 Watts | Efficacy: 77.4 lm/W | 80.0 CRI; 4037K CCT

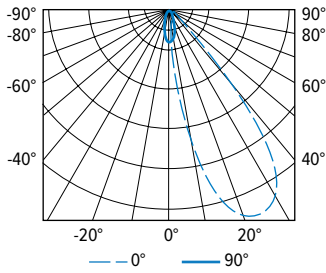

CANDLEPOWER DISTRIBUTION	VERTICAL ANGLE	HORIZONTAL ANGLE					ZONAL LUMENS
		0°	45°	90°	135°	180°	
	0	352	352	352	352	352	
	5	878	643	306	158	132	43
	15	3259	1081	150	54	47	210
	25	5109	881	62	30	28	393
	35	3603	357	30	20	18	326
	45	1054	87	16	10	11	128
	55	154	16	7	5	7	27
	65	13	3	1	1	2	4
	75	2	0	0	0	0	0
	85	0	0	0	0	0	0
	90	0	0	0	0	0	0

LUMEN SUMMARY	ZONE	LUMENS	% FIXTURE
	0 - 40	971	86
	0 - 60	1126	99
	0 - 90	1130	100
	0 - 180	1130	100

6AR-L12/8TW-DIM-UNV-AM-OF-WH (25° tilt) Total Luminaire Output: 997 lumens; 14.6 Watts | Efficacy: 68.3 lm/W | 80.0 CRI; 4037K CCT

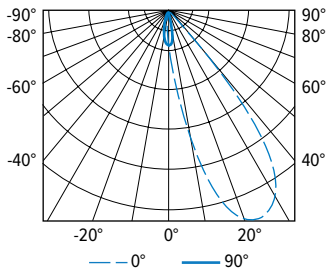

CANDLEPOWER DISTRIBUTION	VERTICAL ANGLE	HORIZONTAL ANGLE					ZONAL LUMENS
		0°	45°	90°	135°	180°	
	0	460	460	460	460	460	
	5	1028	776	415	247	199	53
	15	2652	1266	227	86	65	206
	25	3179	1018	98	39	31	322
	35	2517	428	41	20	20	275
	45	760	111	18	14	17	113
	55	75	16	10	10	12	22
	65	8	4	4	6	7	5
	75	3	1	0	1	2	1
	85	0	0	0	0	0	0
	90	0	0	0	0	0	0

LUMEN SUMMARY	ZONE	LUMENS	% FIXTURE
	0 - 40	856	86
	0 - 60	991	99
	0 - 90	997	100
	0 - 180	997	100

## TRIM TYPE DETAILS

OPEN



FLUSH

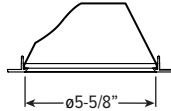

ANGLED



## FLANGE TYPE DETAILS

1/2" STANDARD



Ceiling Cutout:  $\phi 6\text{-}1/2"$

1/4" MUD-IN

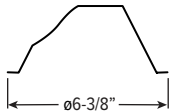

Ceiling cutout:  $\phi 6\text{-}3/4"$

MUD FLANGE MOUNTING KIT (SLIM FLANGE TYPE)

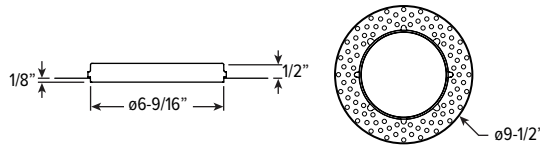

## REFLECTOR FINISH DETAILS

CS

Clear semi-specular

WH

White

BL

Black

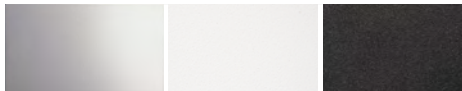

# 6AR tunable WHITE 6" Adjustable Downlight – Round

## MOUNTING TYPE DETAILS

### NEW CONSTRUCTION

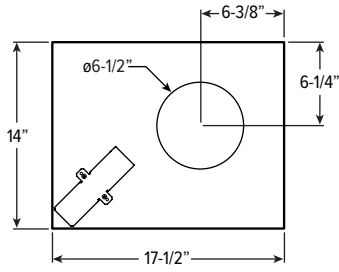

### IC-RATED

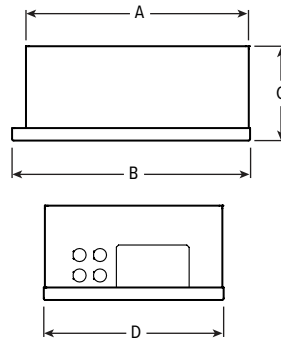

### REMODEL

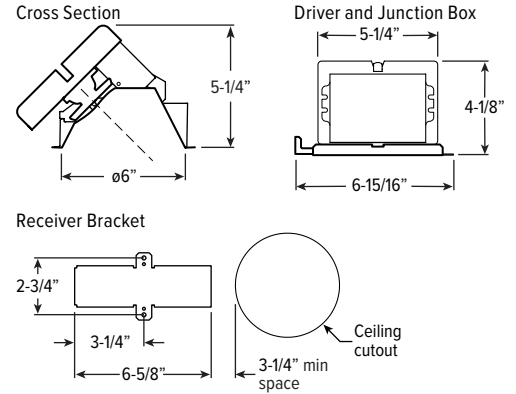

LUMENS	LENGTH			
	A	B	C	D
L12	15-3/16"	16"	6-3/8"	12-1/8"
L20	16-5/8"	17-1/2"	7-7/8"	14"

## EM/10W/RTS DETAILS

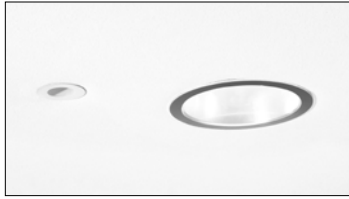

Shown Installed

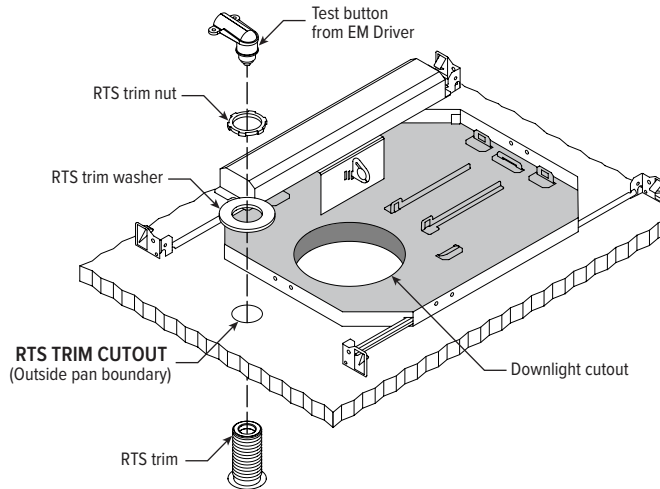

# 6AR tunable WHITE 6" Adjustable Downlight – Round

## MOUNTING HARDWARE DETAILS

**F1** Factory-installed 2-position fixed pan bracket, universal bar hanger included, ships uninstalled

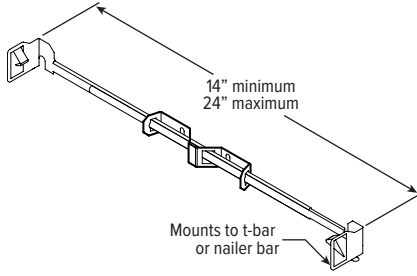

**BA1** Adjustable butterfly pan bracket, bar hanger not included (N Mounting Type only)

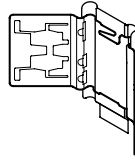

**CA1** Adjustable caterpillar pan bracket, universal bar hanger included (N Mounting Type only)

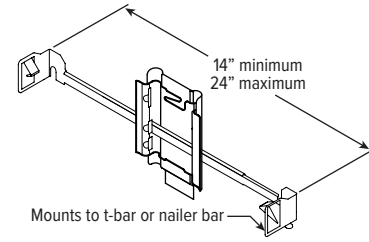

**BA2** Adjustable butterfly pan bracket, heavy-duty universal bar hanger included (N Mounting Type only)

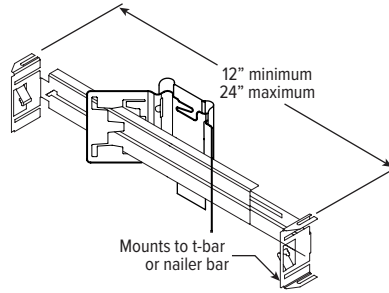

**CA2** Adjustable caterpillar pan bracket, t-bar hanger included (N Mounting Type only)

