

# SMALL WALL PACK WITH POLYCARBONATE LENS

# WPS1

## CFL

**SUBMITTAL:**

**JOB:**

**TYPE:**

**VOLTAGE:**

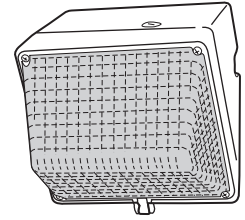

**EXAMPLE:** **WPS1** - **1 42T** - **GX24q-4** - **OPTIONS** - **UNV**

SERIES
# OF WATTAGE LAMPS
LAMP BASE
OPTIONS
VOLTAGE

## SERIES

### FEATURES

- ▶ Overall dimensions: 8-1/2" x 9" x 7"
- ▶ Hinged and gasketed U.V. stabilized polycarbonate lens.
- ▶ Designed for quick and easy installation.
- ▶ 1/2" NPS threaded hub and plugged conduit entry points.
- ▶ Fully gasketed for wet locations.
- ▶ Dark bronze finish only.

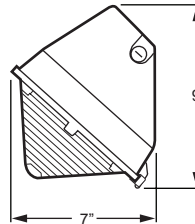

## WPS1 SERIES

**HOUSING** — Die-cast aluminum.  
**REFLECTIVE SURFACES** — Anodized aluminum reflector.  
**LENS** — .145" thick, clear, heat-resistant U.V. stabilized polycarbonate.

## LAMP OPTIONS

### COMPACT FLUORESCENT

# LAMPS	WATTAGE	LAMP BASE
1	26Q	G24q-3
1	32T	GX24q-3
1	42T	GX24q-4

## ELECTRICAL

4-pin socket, electronic ballast standard.  
 Prewired at factory for easy field installation.  
 Rated 0°F minimum starting temperature.

## OPTIONS

<b>PC</b>	Factory-installed Photocell (120V, 208V and 277V only; must specify voltage)	<b>SF</b>	Single Fuse (120V or 277V only; must specify voltage)
<b>DF</b>	Double Fuse (208V or 240V only; must specify voltage)	<b>GMF</b>	HLR-GMF Style Slow Blow Fuse (Factory installed inside of unit. 120V and 277V only; must specify voltage)

## FINISH

Powder coated on heavy-duty die-cast housing. Dark bronze finish only.

## VOLTAGE

<b>120</b>	120V
<b>208</b>	208V
<b>240</b>	240V
<b>277</b>	277V
<b>UNV</b>	120-277V

## MOUNTING

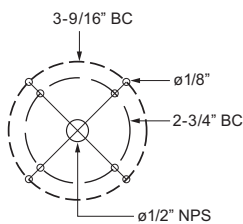

BOLT CIRCLE PATTERN DETAIL

## MOUNTING

Includes a die-cast mounting plate with locknut, O-ring and weatherproof gasket. Wall mounts directly over a 4" recessed outlet box.

#### FOOTCANDLE ESTIMATOR

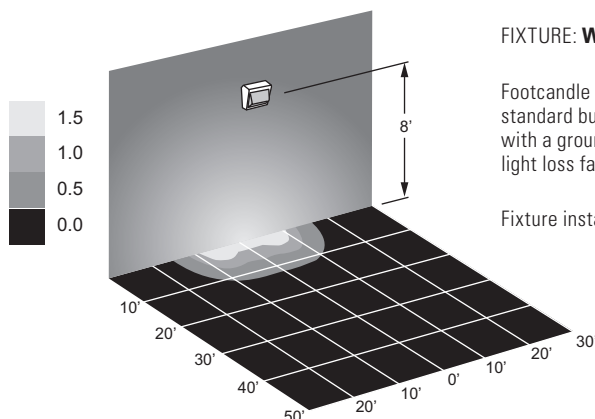

FIXTURE: **WPS1-142T-GX24q-4**

Footcandle calculations based on standard building reflectance of .10 with a ground reflectance of .0 and a light loss factor of .85.

Fixture installed at 8' mounting height.

#### LABELS

cCSAus Certified as luminaire suitable for wet location.