

SURFACE OR WALL MOUNT LIGHT

SLF

LED

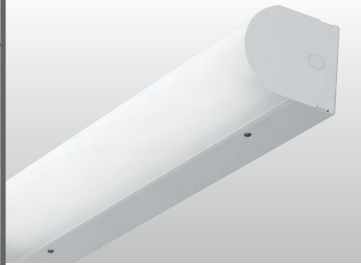

CATALOG #: _____ TYPE: _____

PROJECT: _____ NOTES: _____

EXAMPLE → **SLF - 4 - L90/840 - HIA - OPTIONS - DIM - UNV**

SERIES NOMINAL LENGTH LUMEN PACKAGE CRI & CCT SHIELDING OPTIONS DRIVER VOLTAGE

CROSS SECTION

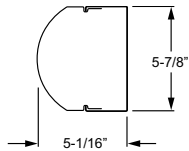

ORDERING INFORMATION

SERIES
SLF Surface or Wall Mount Light

NOMINAL LENGTH

2	2'
4	4'

LED PACKAGE

Example: L90/840			
LUMEN PACKAGE	NOMINAL LUMENS	MINIMUM CRI & CCT	AVERAGE SYSTEM WATTAGE
2'			
L13	1,300	827 = 82 CRI, 2700K 830 = 80 CRI, 3000K 835 = 80 CRI, 3500K	12
L26	2,600		23
L45	4,500		46
4'			
L26	2,600	840 = 80 CRI, 4000K 850 = 80 CRI, 5000K	26
L52	5,200		58
L90	9,000		92

Nominal lumen output based on 3500 CCT. Actual lumens may vary +/-5%, see specific photometric tests. Additional LED lumen packages available, see options.

SHIELDING

HIA Frosted high-impact acrylic, lens secured with Phillips head screws. Optional tamper-resistant screws available, see HIA/TP.

HIA/TP Frosted high-impact acrylic with tamper resistant screws. Tamper-resistant (TPSN-8) tool is required with HIA/TP option, must be ordered separately, see accessories.

OPTIONS

For color options, visit the SLF online at hew.com.

EM/10W 10-watt emergency LED driver (120V-277V only; 4' only)

EM/10W REMOTE (L__) Remote mount 10-watt emergency LED driver (120V-277V only; 2' only) Additional lower lumen packages available. Specify in increments of 100 nominal lumens. Option must be specified with next higher lumen package.

PSBR/120 Single-circuit bottom-mounted pull switch on right (120V only)

PSBL/120 Single-circuit bottom-mounted pull switch on left (120V only)

FSIR-100 Remote controller for OCCWS FSP-211 occupancy sensor. Please specify quantity required per project, see back for details.

TPSN-8 #8 snake eye tamper-resistant tool, required with HIA/TP option. Ordered separately, specify quantity required per project.

OCCUPANCY SENSORS

Factory-installed, must specify 120V or 277V. See back for details

Passive Infrared (PIR):

OCCSS SBR-10 Line voltage, end mount (DRV only)

OCCWS FSP-211-L__ Digital programmable high/low, side mount. Must specify lens, see back for details. Optional FSIR-100 remote controller available, ordered separately, see accessories.

Ultrasonic:

OCCWS FS-505-PP-___ Line voltage, side mount.

DRIVER

Additional dimming drivers available, see [Technical Info](#).

DRV Driver prewired for non-dimming applications

DIM Dimming driver prewired for 0-10V low voltage applications

VOLTAGE

120 120V

277 277V

UNV 120-277V

347 347V (not available with EM drivers)

FEATURES

- ▶ Attractive source of direct lighting for use in stairwells and hallways.
- ▶ Optional end- or side-mount occupancy sensors provide added energy-efficiency.
- ▶ Sleek design for wall or surface-mount applications.
- ▶ LEDs are shielded from view by frosted high-impact acrylic lens.
- ▶ Heavy-duty 16-gauge C.R.S. spot-welded housing.
- ▶ Multiple dimming protocols available.
- ▶ Optional system-integrated emergency LED driver available.
- ▶ Optional tamper-resistant screws available.
- ▶ This fixture is proudly made in the USA.



LED

SPECIFICATIONS

- Housing** – 16-gauge C.R.S.
Shielding – Frosted high-impact acrylic lens, .100" thick.
Finish – 92% minimum average reflective white polyester powder coat bonded to phosphate-free, multi-stage pretreated metal. All parts painted after fabrication to facilitate installation, increase efficiency, and inhibit corrosion.
Electrical – High quality mid-power LED board. Rated for 50,000 hours at 70% lumen maintenance (L70). 25°C maximum ambient operating temperature.
Mounting – Wall and surface mount.
Listings –
- cETLus conforms to UL STD 1598 and UL STD 8750. Certified to CAN/CSA STD C22.2 No. 250.0. Suitable for damp locations.
 - DesignLights Consortium qualified product. Not all versions of this product may be DLC qualified, see the DLC Qualified Products List at www.designlights.org/QPL.

Warranty – 5-year limited warranty, see hew.com/warranty.

IMPORTANT:

Electrostatic sensitive unit. Observe precautions when handling.

OCCUPANCY SENSOR DETAILS

FSIR-100 – Occupancy Sensor Remote
 For use with OCCWS FSP-211



Initial setup and subsequent sensor adjustments are made using a handheld configuration tool (FSIR-100). The wireless tool stores up to five sensor parameter profiles to speed configuration of multiple sensors. Please specify quantity required per project.

Visit www.willstopper.com for more information.



PHOTOMETRY

SLF-4-L90/840-HIA-(L75) Report #: 17257.0; 04/25/13 | Total Luminaire Output: 7522 lumens; 75.8 Watts
 Efficacy: 99.2 lm/W | 84.8 CRI; 4016K CCT | IES Spacing Criteria: End: 1.1, Across: 1.2, Diagonal: 1.2

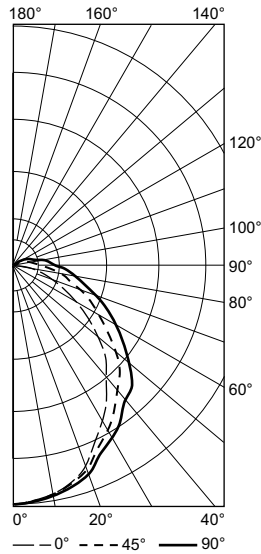

Vertical Angle	Horizontal Angle			Zonal Lumens
	0°	45°	90°	
0	2443	2443	2443	
5	2411	2411	2414	230.2
15	2287	2316	2339	656.0
25	1971	2045	2111	945.4
35	1649	1789	1903	1119.9
45	1314	1535	1713	1181.3
55	903	1164	1360	1030.8
65	569	855	1059	829.2
75	278	563	733	566.2
85	82	390	549	388.6
90	10	284	417	
95	0	240	367	232.9
105	0	144	237	138.4
115	0	91	163	79.1
125	0	65	113	50.3
135	0	51	82	31.9
145	0	49	68	22.8
155	0	43	51	13.8
165	0	0	45	4.9
175	0	0	0	0
180	0	0	0	

Zone	Lumens	% Fixture
0 - 30	1832	24.4
0 - 40	2951	39.2
0 - 60	5163	68.6
0 - 90	6948	92.4
90 - 120	450	6.0
90 - 130	501	6.7
90 - 150	555	7.4
90 - 180	574	7.6
0 - 180	7522	100.0

FIXTURE DETAILS

BACK VIEW

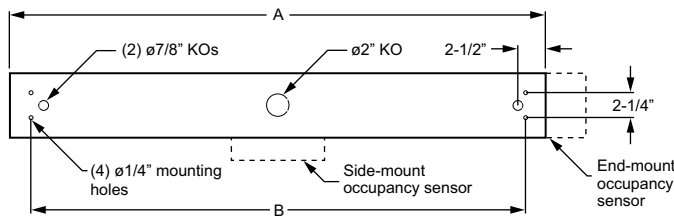

NOMINAL LENGTH	ACTUAL LENGTH (A)	ACTUAL LENGTH (B)
2'	24-5/8"	20-1/2"
3'	36-5/8"	32-1/2"
4'	48-5/8"	44-1/2"

PULL SWITCH

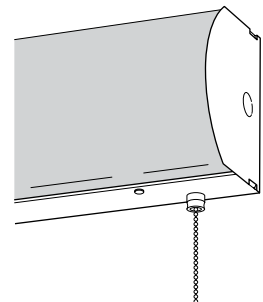

FSP-211 OCCUPANCY SENSOR

- Fully adjustable high and low dimmed light levels.
- Designed for LED fixtures; rated for up to 200,000 on/off cycles.
- Hold-off setpoint with automatic calibration option for convenience and added energy savings.
- Adjustable via handheld wireless configuration tool (FSIR-100, ordered separately, see accessories).
- Adjustable time delay and cutoff delay.
- Factory set to 10% dimming at 5 minutes, cutoff at 1 hour.



ORDERING INFORMATION

OCCWS FSP-211 Digital high/low passive infrared (PIR) integrated sensor, side mount, must specify lens (120V or 277V only).

LENS

- L2** Coverage at 8' mounting height: ø48'
- L3** Coverage at 20' mounting height: ø40'
- L7** Coverage at 40' mounting height: ø100'

