

# DESIGNERLINE SMALL WALL MOUNT COVE

# SMC

**SUBMITTAL:**

**JOB:**

**TYPE:**

**VOLTAGE:**

EXAMPLE

**SMC CL - 4 - 1 54T5H - F / F - OPTIONS - EB1 - UNV**

▼ SERIES   
 ▼ STYLE   
 ▼ NOMINAL LENGTH   
 ▼ TOTAL LAMPS   
 ▼ WATTAGE/TYPE   
 ▼ FIXTURE TYPE   
 ▼ END CAP   
 ▼ OPTIONS   
 ▼ BALLAST TYPE   
 ▼ VOLTAGE

ClassicLine (CL)

CurviLine (CV)

## SMC SERIES

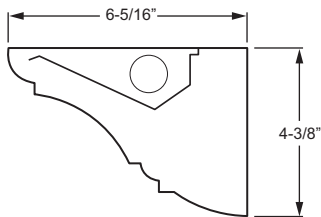

ClassicLine (CL)  
Shown with 1-lamp T8

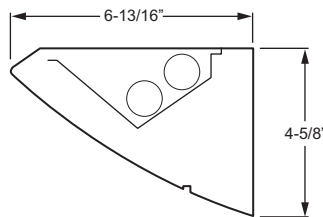

CurviLine (CV)  
Shown with 2-lamp T8



## FEATURES

- ▶ Architecturally styled cove creates a comfortable, low glare environment without cluttering the ceiling surface.
- ▶ Quality workmanship and attention to detail encompass this small scale indirect luminaire designed to perform well in spaces with low to moderate ceiling heights.
- ▶ Common applications include smaller offices, corridors, healthcare facilities and areas where it is important to avoid typical glare or direct view of the lamps.
- ▶ The DesignerLine Small Cove is part of an extensive system of matched products.
- ▶ Heavy-duty hook-on mounting brackets make it easy to securely install and level fixtures.
- ▶ Joiner and alignment system permit mounting in continuous rows with hairline seams that virtually disappear.
- ▶ Optional clear or prismatic dustcover allows easy cleaning and prevents accumulation of dust and debris.
- ▶ Optional anti-microbial white finish available for use in healthcare applications.
- ▶ This fixture is proudly made in the USA.

## ORDERING INFORMATION

SERIES	
<b>SMC</b>	DesignerLine Small Wall Mount Cove

STYLE	
<b>CL</b>	ClassicLine
<b>CV</b>	CurviLine

NOMINAL LENGTH	
<b>2</b>	2'
<b>3</b>	3'
<b>4</b>	4'
<b>6</b>	6'
<b>8</b>	8'

TOTAL LAMPS	
<b>1, 2, or 4</b>	(1- or 2-lamp cross-section only)

LAMP WATTAGE/TYPE	
2' LAMP OPTIONS	
<b>14T5S</b>	2', 14-watt T5 (1- or 2-lamp ballast[s] only)
<b>17</b>	2', 17-watt T8
<b>24T5H</b>	2', 24-watt T5HO
3' or 6' LAMP OPTIONS	
<b>21T5S</b>	3', 21-watt T5 (1- or 2-lamp ballast[s] only)
<b>25</b>	3', 25-watt T8
<b>39T5H</b>	3', 39-watt T5HO
4' or 8' LAMP OPTIONS	
<b>28T5S</b>	4', 28-watt T5 (1- or 2-lamp ballast[s] only)
<b>32</b>	4', 32-watt T8
<b>54T5H</b>	4', 54-watt T5HO

FIXTURE TYPE	
See back for fixture type details.	
<b>F</b>	Electrical feeder unit, quick-connect wiring harness, left end cap installed
<b>J</b>	Joiner unit, quick-connect wiring harness, no end caps
<b>E</b>	End unit, quick-connect wiring harness, right end cap installed
<b>S</b>	Stand-alone unit, two end caps installed

END CAP STYLE	
<b>F</b>	Flat ends
<b>M</b>	Mitered ends (increases overall length, see back for details)

OPTIONS	
For <b>color options</b> , visit the SMC at <a href="http://hewilliams.com">hewilliams.com</a> .	
For generic <b>EM ballast</b> options (must specify voltage), see Information section. <b>Ballast size restrictions apply.</b>	
<b>C2_</b>	Two-circuit quick-connect wiring harness (see Information section for complete quick-connect offering)
<b>GLR</b>	Fuse, fast blow (specify voltage), one per ballast
<b>CDC</b>	Clear flat dustcover
<b>PDC</b>	Clear prismatic lens dustcover
<b>3SL</b>	3" staggered lamps, available in 2-lamp cross-section only (adds 3" to overall length)
<b>AMW</b>	Anti-microbial white finish

BALLAST TYPE	
For <b>dimming ballast</b> options, see Information section. <b>Ballast size restrictions apply.</b>	
<b>EB1</b>	1-lamp electronic ballast
<b>EB2</b>	2-lamp electronic ballast
<b>EB4</b>	4-lamp electronic ballast
<b>EB2/2</b>	(2) 2-lamp electronic ballasts

VOLTAGE	
<b>120</b>	120V
<b>277</b>	277V
<b>UNV</b>	120-277V
<b>347</b>	347V

## SPECIFICATIONS

**Housing** – Minimum .100" thick extruded aluminum.  
**Weight** – 5 lbs. per foot  
**End Caps** – 3/32" thick aluminum, welded, seam-filled and finished at ends of individual units and rows.  
**Reflective Surfaces** –20-gauge CRS with 92% minimum average reflective white polyester powder coat.  
**Finish** – Textured matte white polyester TGIC powder coat bonded to phosphate-free, multi-stage pretreated metal. All parts painted after fabrication to facilitate installation, increase efficiency, and inhibit corrosion.  
**Electrical** –Electronic ballast standard, instant start T8, program start T5, rated Class P.  
**Mounting** –Wall mount, individual units or continuous rows.  
**Labels** – UL/CUL listed as fluorescent luminaire suitable for dry or damp locations.

## PHOTOMETRY INFORMATION

Catalog #: **SMCCL-4-154T5H**

### TEST REPORT INFORMATION

- ▶ Test Report #: SMCCL-4-154T5H.IES
- ▶ Lamp Type: FP54T5HO
- ▶ Lamp Quantity: 1

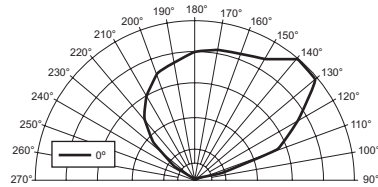

### CANDLEPOWER DISTRIBUTION

Vertical Angle	Horizontal Angle					Zonal Lumens
	0°	45°	90°	135°	180°	
90°	9	15	24	5	5	7.4
100°	279	377	268	28	25	123.9
110°	905	878	572	134	53	392.1
120°	1218	1286	771	424	252	661.3
130°	1605	1474	918	691	571	827.4
140°	1619	1347	1051	895	824	839.2
150°	1421	1310	1170	1063	1004	726.9
160°	1368	1328	1262	1183	1153	565.6
170°	1345	1326	1327	1265	1218	362.6
180°	1309	1309	1309	1309	1309	124.5

### ZONAL CAVITY COEFFICIENTS

	Ceiling	.80			.70			.50		
	Wall	.70	.50	.30	.70	.50	.30	.50	.30	.10
Room Cavity Ratio	0	.88	.88	.88	.75	.75	.75	.52	.52	.52
	1	.80	.76	.73	.68	.65	.63	.43	.43	.42
	2	.73	.67	.61	.62	.57	.53	.39	.37	.34
	3	.66	.58	.52	.56	.50	.45	.34	.31	.29
	4	.61	.51	.45	.51	.44	.39	.30	.27	.24
	5	.55	.46	.39	.47	.39	.34	.27	.23	.21
	6	.51	.41	.34	.43	.35	.29	.24	.20	.18
	7	.47	.36	.30	.40	.31	.26	.22	.18	.15
	8	.43	.33	.26	.37	.28	.23	.19	.16	.13
	9	.40	.30	.23	.34	.25	.20	.18	.14	.12
v	.37	.27	.21	.32	.23	.18	.16	.13	.10	

Effective Floor Cavity Reflectance = .20

### LUMEN SUMMARY

Zone	Lumens	% Lamp	% Fixture
90° - 120°	1177	23.5	25.4
90° - 130°	2005	40.1	43.3
90° - 150°	3571	71.4	77.1
90° - 180°	4623	92.5	99.8
<b>Total Luminaire:</b>			
0° - 180°	4631	92.6	100.0
Total Luminaire Optical Efficiency: <b>92.6%</b>			

### WALL MOUNT BRACKET

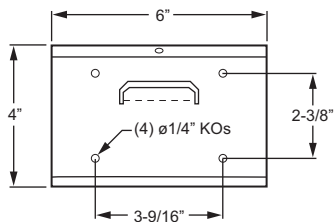

## FIXTURE DETAILS

### BACK VIEW

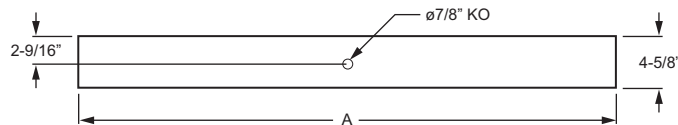

NOMINAL LENGTH	ACTUAL LENGTH (A)	
	T5	T8
2'	22-5/8"	24-1/16"
3'	34-3/8"	36-1/16"
4'	46-3/16"	48-1/16"
6'	68-9/16"	71-15/16"
8'	92-1/8"	95-15/16"

**Note:** Mitered ends add to overall length, see details at right.

### MITERED END DETAILS

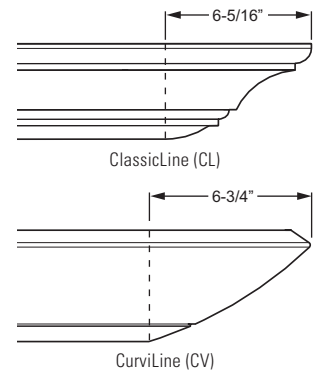

### FIXTURE TYPE DETAILS (ClassicLine shown)

	F	J	E	S
Mitered				
Flat				