

CATALOG #:	TYPE:
PROJECT:	NOTES:

EXAMPLE **96 - 4 - L62/830 - HIAFR - OPTIONS - DRV - UNV**

SERIES NOMINAL LENGTH LUMEN PACKAGE CRI & CCT SHIELDING OPTIONS/ACCESSORIES DRIVER VOLTAGE



CROSS SECTION

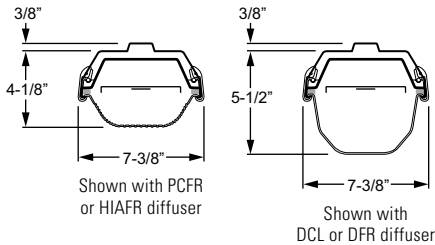

ORDERING INFORMATION

SERIES
96 Fully Enclosed & Gasketed Industrial

NOMINAL LENGTH
2 2'
4 4'
8 8' (acrylic diffusers only)

LED PACKAGE
NOTE: Nominal lumens based on HIAFR shielding.

LUMEN PACKAGE	EXAMPLE: L62/830		MINIMUM CRI & CCT	AVERAGE SYSTEM WATTAGE	
	HIAFR	PCFR			
2'					
L21	2,100	1,900	830 = 82 CRI, 3000K 835 = 82 CRI, 3500K 840 = 82 CRI, 4000K 850 = 82 CRI, 5000K	18	
L29	2,900	2,600		25	
4'					
L40	4,000	3,900		30	
L62	6,400	5,800		48	
L81	8,100	7,400		65	
L110	11,100	10,100		88	
8'					
L80	8,000	-		61	
L130	13,000	-		95	
L160	16,000	-		123	
L220	22,000	-		166	

See back for lumen maintenance details.

SHIELDING
HIAFR Frosted, ribbed, impact-resistant acrylic
PCFR Frosted, ribbed, UV stabilized polycarbonate (not available in 8' units)
DFR Drop, frosted, impact-resistant acrylic
DCL Drop, clear, impact-resistant acrylic with frosted ends

OPTIONS/ACCESSORIES
 Cord and receptacle options available, see back for details.
(L__) Additional lower lumen packages in 100 nominal lumen increments available. Option must be specified with next *higher* lumen package.
Example: 4,100 nominal lumens = 96-4-L62/840-HIAFR-(L41).

OPTIONS/ACCESSORIES (Continued)

EM/10W 10-watt emergency battery (120-277V only; not available with L110 or L220 lumen packages; 4' or 8' only) see page 2 for temperature restrictions

LA40 -40°C minimum operating temperature

WET/1 (1) 1/2" watertight hub (factory-installed in end of housing)

WET/2 (2) 1/2" watertight hubs (factory-installed in ends of housing; not available with occupancy sensor option)

SSCMB Stainless steel chain mounting brackets (2 per fixture)

TP Tamper-resistant polycarbonate latches (Requires a tamper-resistant tool. Must be ordered separately. Please specify quantity required per project.)

SS LATCH Stainless steel latches

TP/SS LATCH Tamper-resistant stainless steel latches (Requires a tamper-resistant tool. Must be ordered separately. Please specify quantity required per project.)

WMB Stainless steel 45° wall mount bracket (2 per fixture). See back for details.

OCCUPANCY SENSORS
 Specify from the following options (must specify 120 or 277V; IP65 certified when specified with occupancy sensor):

OCCWS HB350W-L3W
OCCWS FSP-211B-L_ Factory-installed occupancy and daylight control, must specify lens, see page 3 for details. Optional FSIR-100 remote controller available, ordered separately.

FSIR-100 Remote controller for occupancy sensor, please specify quantity required per project, ships separately, see page 3 for details

DRIVER
 Additional dimming drivers available, see [Technical Info](#).
DRV Driver prewired for non-dimming applications
DIM 10% dimming driver prewired for 0-10V low voltage applications

VOLTAGE
 Must specify 120V or 277V when using occupancy sensor.
120 120V
277 277V
UNV 120-277V

FEATURES

- Fully gasketed fixture resists dust, bugs, and moisture.
- Polycarbonate toggle latches (standard) ensure a tight seal and provide easy access to electrical components.
- Optional stainless steel, tamper-resistant stainless steel, or tamper-resistant polycarbonate latches available.
- Closed-cell polyurethane gasket poured and formed in place to ensure tight seal—does not absorb water or support fungal growth.
- NSF/ANSI Standard 2—Splash Zone certified.
- IP65, IP66, and IP67 certified.
- Rated for -20°C to 40°C maximum ambient operating temperature (restrictions apply, see page 2 for details). -40°C minimum operating temperature with LA40 option.
- Multiple dimming protocols available.
- This fixture is proudly made in the USA.



LED

SPECIFICATIONS

Enclosure – Outer housing consists of 5VA (f1) fiberglass, rated for flame and weather resistance.

Internal Housing – .050" aluminum.

Latching – Injection-molded polycarbonate latches.

Reflector – 92% minimum average reflective white polyester powder coat bonded to phosphate-free, multi-stage pretreated metal.

Shielding – Frosted, ribbed, impact-resistant acrylic.

Electrical – High quality mid-power LED board. L70 >50,000 hours. -20°C to 40°C maximum ambient operating temperature (restrictions apply, see Performance Data for details). -40°C minimum operating temperature with LA40 option.

Mounting – Surface or suspended. Stainless steel ceiling mount brackets included.

Listings –

- cETLus conforms to UL STD 1598 and UL STD 8750. Certified to CAN/CSA STD C22.2 No. 250.0. Suitable for dry or damp locations.
- DesignLights Consortium qualified product. Not all versions of this product may be DLC qualified, see the DLC Qualified Products List at www.designlights.org/QPL.
- cETLus listed as suitable for wet locations when specified with watertight hub, STOW or SOOW cord, or mini-male receptacle option.
- NSF/ANSI Standard 2–Splash Zone certified, IP65, IP66, and IP67 certified, and rated for NEMA 4X.

Warranty – 5-year limited fixture warranty, see hew.com/warranty.

IMPORTANT:

Electrostatic sensitive unit. Observe precautions when handling.

CORD OPTIONS

EXAMPLE: 5WMRC6		
NUMBER OF CONDUCTORS	POWER CONNECTION – NON-DIMMING	CORD LENGTH
3 = 3-wire 4 = 4-wire	WMR = Mini-male receptacle only	N/A
	WC = STOW cord	6 = 6' 20 = 20'
	WMRC = Mini-male receptacle with STOW cord	
POWER CONNECTION – DIMMING		
5 = 5-wire 6 = 6-wire	WMR = Mini-male receptacle only	N/A
	WC = SOOW cord	6 = 6' 20 = 20'
	WMRC = Mini-male receptacle with SOOW cord	

Wet location cord sets are yellow.

FIXTURE PERFORMANCE DATA

LED PACKAGE	DELIVERED LUMENS	WATTAGE	EFFICACY (lm/W)	MAXIMUM TEMPERATURE (°C)	
				STANDARD	EMERGENCY
2'					
L21	2201	18.0	120.5	40	–
L29	3028	25.0	118.4	40	–
4'					
L40	4086	30.0	137.4	40	40
L62	6434	48.0	133.1	40	30
L81	8121	65.0	125.0	30	25
L110	11075	88.0	126.2	30	–
8'					
L80	8018	61.0	132.8	40	40
L130	13026	95.0	138.0	40	30
L160	16188	123.0	133.3	30	25
L220	22056	166.0	135.7	30	–

CCT MULTIPLIER TABLE

SHIELDING	CONVERSION FACTOR
HIAFR	1.000
PCFR	0.913
DFR	1.052
DCL	1.062 ¹

¹ Due to lens being clear, striations in the light distribution will be visible.

- Lumens based on HIAFR shielding.
- Photometrics tested in accordance with IESNA LM-79
- Results shown are based on 25°C ambient temperature and FR shielding
- Wattage shown is average for 120V through 277V input
- Results scaled based on relative CCT output

PHOTOMETRY

96-4-L62/830-HIAFR-DRV Report #: 20008.0; 08/15/17 | Total Luminaire Output: 6434 lumens; 48.3 Watts
Efficacy: 133.1 lm/W | 83.6 CRI; 4041K CCT | IES Spacing Criteria: End: 1.1, Across: 1.1, Diagonal: 1.1

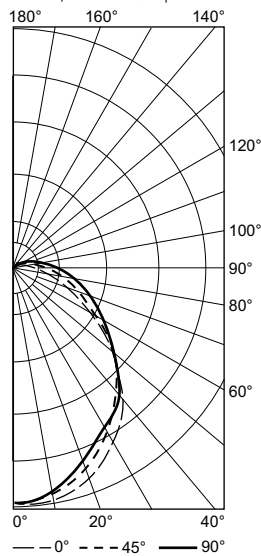

Vertical Angle	Horizontal Angle			Zonal Lumens
	0°	45°	90°	
0	2318	2318	2318	
5	2352	2298	2283	219.8
15	2259	2169	2120	616.7
25	2066	1943	1865	899.3
35	1780	1666	1704	1065.3
45	1370	1379	1389	1055.1
55	943	1007	1062	900.6
65	546	695	828	690.8
75	231	449	599	456.6
85	38	251	361	251.9
90	15	185	272	
95	14	150	217	143.2
105	8	84	138	79.4
115	4	39	85	39.0
125	0	8	42	13.7
135	0	0	9	1.8
145	0	0	2	0.6
155	0	0	0	0.0
165	0	0	0	0.0
175	0	0	0	0.0
180	0	0	0	0.0

LUMEN SUMMARY	Zone	Lumens	% Fixture
	0 - 30	1736	27.0
0 - 40	2801	43.5	
0 - 60	4757	73.9	
0 - 90	6156	95.7	
90 - 120	262	4.1	
90 - 150	275	4.3	
90 - 180	278	4.3	
0 - 180	6434	100.0	

FIXTURE DETAILS

BACK VIEW

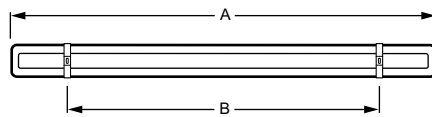

Nominal Length	Overall Length (A)	Mounting Distance (B)
2'	27-5/8"	12" - 17" OC
4'	51-7/8"	30" - 42" OC
8'	100-1/4"	48" - 80" OC

MOUNTING

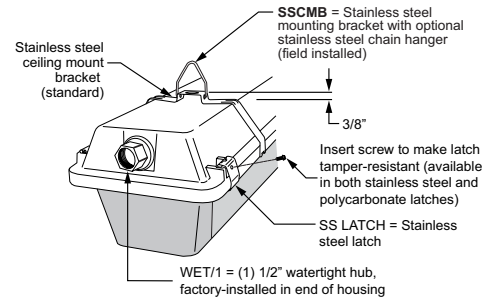

WMB

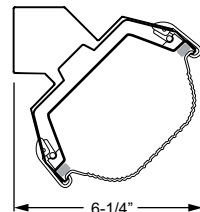

Wet location listed with fixture lens facing down

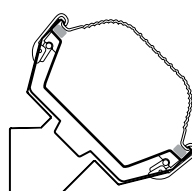

Dry or damp location only with fixture lens facing up

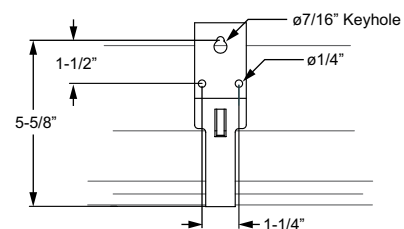

OCCUPANCY SENSOR

EXAMPLE

OCCWS FSP-211B - L2

OCCUPANCY
SENSOR

LENS

- ▶ Fully adjustable high and low dimmed light levels.
- ▶ Designed for LED fixtures; rated for extreme temperatures and up to 200,000 on/off cycles.
- ▶ Hold-off setpoint with automatic calibration option for convenience and added energy savings.
- ▶ Adjustable via handheld wireless configuration tool (ordered separately, see Accessory Details).
- ▶ IP66 rated with choice of lenses for wet and outdoor locations, and mounting heights from 8' to 20'.
- ▶ Adjustable time delay and cutoff delay.
- ▶ Factory set to 10% dimming at 5 minutes, cutoff at 1 hour.
- ▶ Multi-level control based on motion and/or daylight contribution.

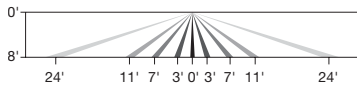

L2 Lens

ORDERING INFORMATION

OCCWS FSP-211B-__ Factory-installed occupancy sensor, must specify lens (120V or 277V only)

LENS

- L2** Coverage at 8' mounting height: ø48'
- L3** Coverage at 20' mounting height: ø40'

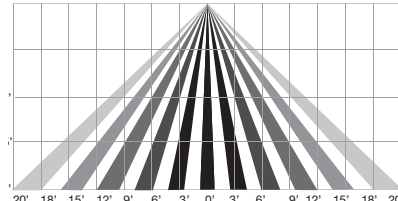

L3 Lens

ACCESSORY DETAILS

FSIR-100 – Occupancy Sensor Remote



Initial setup and subsequent sensor adjustments are made using a handheld configuration tool (FSIR-100). The wireless tool stores up to five sensor parameter profiles to speed configuration of multiple sensors. Please specify quantity required per project.

Visit www.wattstopper.com for more information.

