

4" CONTINUOUS – SURFACE MOUNT

LX4S

CATALOG #:	TYPE:
PROJECT:	NOTES:

PoE



EXAMPLE **LX4S - 4 - P8/835 - S - A - OPTIONS - POE N**

SERIES NOMINAL LENGTH LUMENS PER FOOT CRI & CCT FIXTURE TYPE SHIELDING OPTIONS/ACCESSORIES CONTROL

CROSS SECTION

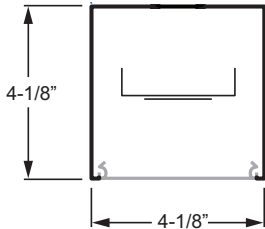

ORDERING INFORMATION

SERIES
LX4S 4" Continuous – Surface Mount – PoE

SHIELDING
A Diffuse acrylic

NOMINAL LENGTH
 See page 3 for actual illuminated length
 Stand-alone – 2'-12' nominal lengths specified in 2' increments; fixture ships assembled.
 Example: **2** = 2'.
 Row-mount – Row mounted fixtures ship unassembled. Specify lengths per chart on page 3.
 Example: **36** = 35'-3/8".
 Contact apps@hew.com for layout assistance.

OPTIONS
 For color options, visit the LX4S online at hew.com.
ASY Asymmetric reflector (reduces fixture output by 34%). Field installed. See page 2 for details.

LED PACKAGE

EXAMPLE: P8/835		
LUMEN PACKAGE	NOMINAL LUMENS PER FOOT	MINIMUM CRI & CCT
P8	800	827 = 80 CRI, 2700K
		830 = 80 CRI, 3000K
		835 = 80 CRI, 3500K
		840 = 80 CRI, 4000K

ACCESSORIES
 See hew.com/poe for compatible sensors & switches

Nominal lumen output based on 3500 CCT. Actual lumens may vary +/-5%, see lengths configuration table for fixture performance data and system wattages.

CONTROL
 For additional PoE info, see hew.com/poe
POE N Power over Ethernet network node
POE D Power over Ethernet device node (not available for fixtures over 40W)

FIXTURE TYPE
S Stand-alone, 2'-12' nominal
F/J Row mount for runs greater than 12' nominal

FEATURES

- ▶ Williams turn-key Power over Ethernet (PoE) solution provides plug-and-play networked lighting and control.
- ▶ Efficacies up to 112 lm/W
- ▶ Sleek, linear design incorporates clean lines, slim styling, and a continuous row of light.
- ▶ Available in seamless stand-alone units up to 12' in nominal length or row-mount configurations greater than 12' nominal.
- ▶ Attractive source of direct lighting for use in offices, hallways, conference rooms or common areas.
- ▶ Linear extrusion contains snap-in light cartridges for ease of installation and maintenance.
- ▶ LX4 system includes suspended, recessed, wall mount, and corner configurations, see hew.com.
- ▶ Diffuse acrylic lens shields LEDs from view.
- ▶ This fixture is proudly made in the USA.

SYSTEM REQUIREMENTS

- Lighting system (site software)
- Gateway or alternate server (runs software)
- PoE switches or Ethernet switches and mid-span power injectors
- See hew.com/poe for details

Note: For corner fixtures, see LX4S90.

LX4S

4" CONTINUOUS – SURFACE MOUNT

PoE

PHOTOMETRY

SPECIFICATIONS

Housing – Extruded aluminum with die-cast end plates.

Shielding – Extruded diffuse acrylic lens.

Finish – Textured matte white polyester TGIC powder coat bonded to phosphate-free, multi-stage pretreated metal. All parts painted after fabrication to facilitate installation, increase efficiency, and inhibit corrosion.

Electrical – High quality mid-power LED boards. L70 >60,000 hours per IES TM-21. Low-voltage DC fixture, to be fed by Class 2 power supply.

Mounting – Surface.

Labels – cCSAus certified as luminaire suitable for dry or damp locations.

Warranty – 5-year limited warranty, see hew.com/warranty.

ASYMMETRIC REFLECTOR DETAIL

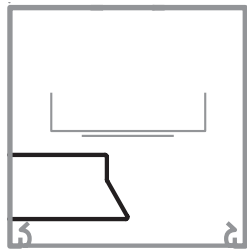

Reflector will shadow 50% of the lens.

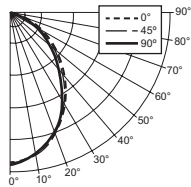

LX4S-4-P8/835-A Total Luminaire Output: 2764 lumens; 25 Watts | Efficacy: 111 lm/W | 82.7 CRI; 3500K CCT

CANDLEPOWER DISTRIBUTION	Vertical Angle	Horizontal Angle			Zonal Lumens
		0°	45°	90°	
	0	1163	1163	1163	
5	1148	1156	1165	110	
15	1094	1097	1101	309	
25	986	982	976	451	
35	835	820	800	512	
45	659	635	602	488	
55	478	451	418	402	
65	307	286	261	283	
75	159	150	140	159	
85	45	46	44	50	
90	0	0	0		

LUMEN SUMMARY	Zone	Lumens	% Fixture
	0 - 30	870	32
	0 - 40	1382	50
	0 - 60	2272	82
	0 - 90	2764	100
	0 - 180	2764	100

LX4S-4-P8/835-A-ASY Total Luminaire Output: 1824 lumens; 25 Watts | Efficacy: 73 lm/W | 83.9 CRI; 3500K CCT

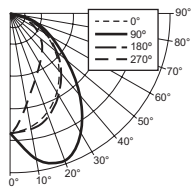

CANDLEPOWER DISTRIBUTION	Vertical Angle	Horizontal Angle				Zonal Lumens
		0°	90°	180°	270°	
	0	684	684	684	684	
5	673	765	681	615	65	
15	642	887	658	467	187	
25	586	884	606	377	283	
35	507	756	526	319	333	
45	411	572	426	269	327	
55	305	386	319	213	277	
65	201	235	209	150	200	
75	105	124	112	85	115	
85	32	41	33	27	37	
90	0	0	0	0		

LUMEN SUMMARY	Zone	Lumens	% Fixture
	0 - 30	536	29
	0 - 40	868	48
	0 - 60	1472	81
	0 - 90	1824	100
	0 - 180	1824	100

FIXTURE DETAILS

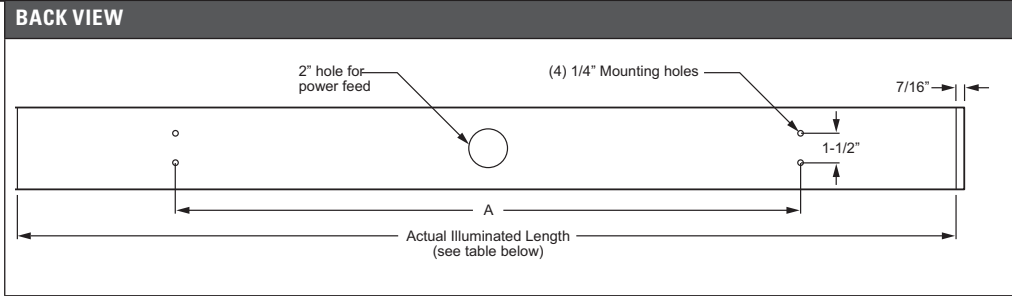

ROW MOUNTED LENGTHS

NOMINAL LENGTH	ACTUAL ILLUMINATED LENGTH	DIM. A	LUMENS PER 11"	TOTAL FIXTURE LUMENS	TOTAL FIXTURE WATTAGE	EFFICACY (lm/W)	NODE QUANTITY ¹	FIXTURE CONFIGURATIONS											
2	1', 10-1/8"	16"	751	1382	13	106.3	1	2' S											
4	3', 8-1/4"	32"	751	2764	25	110.5	1	4' S											
6	5', 6-3/8"	48"	743	4101	36	113.9	1	6' S											
8	7', 4-1/2"	64"	751	5527	50	110.5	1	8' S											
10	9', 2-5/8"	80"	751	6865	61	112.5	2	10' S											
12	11', 3/4"	80"	751	8291	75	110.5	2	12' S											
13	12', 10-7/8"		743	9629	86	112.0	2	6' F	8' J										
15	14', 9"		751	11055	100	110.5	2	8' F	8' J										
17	16', 7-1/8"		751	12392	111	111.6	3	6' F	6' J	6' J									
19	18', 5-1/4"		751	13818	125	110.5	3	8' F	4' J	8' J									
21	20', 3-3/8"		743	15156	136	111.4	3	8' F	6' J	8' J									
23	22', 1-1/2"		751	16582	150	110.5	3	8' F	8' J	8' J									
24	23', 11-5/8"		751	17920	161	111.3	4	4' F	6' J	8' J	8' J								
26	25', 9-3/4"		751	19346	175	110.5	4	4' F	8' J	8' J	8' J								
28	27', 7-7/8"		743	20683	186	111.2	4	6' F	8' J	8' J	8' J								
30	29', 6"		751	22109	200	110.5	4	8' F	8' J	8' J	8' J								
32	31', 4-1/8"		751	23447	211	111.1	5	4' F	6' J	8' J	8' J	8' J							
34	33', 2-1/4"		751	24873	225	110.5	5	4' F	8' J	8' J	8' J	8' J							
36	35', 3/8"		743	26211	236	111.1	5	6' F	8' J	8' J	8' J	8' J							
37	36', 10-1/2"		751	27637	250	110.5	5	8' F	8' J	8' J	8' J	8' J							
39	38', 8-5/8"		751	28974	261	111.0	6	4' F	6' J	8' J	8' J	8' J	8' J						
41	40', 6-3/4"		751	30400	275	110.5	6	4' F	8' J	8' J	8' J	8' J	8' J						
43	42', 4-7/8"		743	31738	286	111.0	6	6' F	8' J	8' J	8' J	8' J	8' J						
45	44', 3"		751	33164	300	110.5	6	8' F	8' J	8' J	8' J	8' J	8' J						
47	46', 1-1/8"		751	34502	311	110.9	7	4' F	6' J	8' J	8' J	8' J	8' J	8' J					
48	47', 11-1/4"		743	35928	325	110.5	7	4' F	8' J	8' J	8' J	8' J	8' J	8' J					
50	49', 9-3/8"		751	37266	336	110.9	7	6' F	8' J	8' J	8' J	8' J	8' J	8' J	8' J				

TYPE	
S	Stand-Alone
F	Feeder
J	Joiner

¹ One power drop per node required.

- Photometrics tested in accordance with IESNA LM-79. Results shown are based on 25°C ambient temperature.
- Results scaled based on relative CCT output.
- Use multiplier table to calculate additional options.

MULTIPLIER TABLES

COLOR TEMPERATURE	
CCT/CRI	CONVERSION FACTOR
3000K/80CRI	0.97
3500K/80CRI	1.00
4000K/80CRI	1.03

