

PERFORMANCE HIGH BAY

GP2

PoE

CATALOG #: _____ TYPE: _____

PROJECT: _____ NOTES: _____

EXAMPLE → **GP2 - P136/840 - M - OPTIONS - POE N**

SERIES LUMEN PACKAGE CRI & CCT DISTRIBUTION OPTIONS/ACCESSORIES CONTROL



CROSS SECTIONS

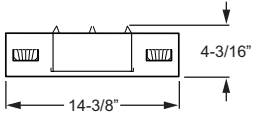

ORDERING INFORMATION

SERIES
GP2 Performance LED High Bay – PoE

LED PACKAGE

EXAMPLE: P136/840			WATTAGE
LUMEN PACKAGE	NOMINAL LUMENS	MINIMUM CRI & CCT	
P136	13,600	840 = 80 CRI, 4000K 850 = 80 CRI, 5000K	100

Nominal lumen output based on 4000 CCT and (W) wide distribution. Actual lumens may vary, see fixture performance data.

DISTRIBUTION

N Narrow
M Medium
W Wide

OPTIONS

UP Uplight reflector, see page 3 for details
UPM One module in upright orientation, see page 3 for details (wide distribution only; minimum of 48" from mounting surface required)
UPMA All modules in upright orientation (wide distribution only; minimum of 48" from mounting surface required)
CL Clear polycarbonate lens (wide distribution only), see page 3 for details
DL Diffuse polycarbonate lens (wide distribution only), see page 3 for details
VBY (2) Y-hangers
VBY-2 (2) Y-hangers and (2) 2' chains

ACCESSORIES

See hew.com/poe for compatible sensors & switches
 See page 3 for mounting details.
GP2-SMK Surface mount kit for GP2 (increases fixture height, see page 3 for details)
WG11 11-gauge wireguard, chrome powder coated, see page 3 for details (recommended with optional DL lens to eliminate striations)
GS/Y26/10 Cable suspension kit, 10' adjustable length (1 pair)
HUB MT 3/4" Cast iron hub and junction box for single 3/4" pendant mount (shipped not attached)
HUB/HOOK MT Cast iron hub with mounting hook (shipped not attached)
HOOK/CABLE Hook and cable mounting kit, 10'

CONTROL

For additional PoE info, see hew.com/poe
POE N Power over Ethernet network node

FEATURES

- ▶ Williams turn-key Power over Ethernet (PoE) solution provides plug-and-play networked lighting and control.
- ▶ Efficacies up to 136 lm/W
- ▶ Narrow, medium, wide distributions, and uplight option tailor performance to the application
- ▶ Clear and diffuse lens options
- ▶ Multiple module options for 33% to 100% uplight
- ▶ Open construction with aluminum heat sinks to maximize air flow and cooling
- ▶ This fixture is proudly made in the USA

SYSTEM REQUIREMENTS

- Lighting system (site software)
- Gateway or alternate server (runs software)
- PoE switches or Ethernet switches and mid-span power injectors
- See hew.com/poe for details



PHOTOMETRY

SPECIFICATIONS

Housing – Aluminum and steel construction.
Finish – Nickel and textured black powder coat bonded to phosphate-free, multi-stage pretreated metal. Painted after fabrication to facilitate installation, increase efficiency, and inhibit corrosion.

Electrical – High quality mid-power LED boards. L70 >54,000 hours. Low-voltage DC fixture, to be fed by Class 2 power supply.

Mounting – Suspended.

Labels – cCSAus certified as luminaire suitable for dry or damp locations.

Warranty – 5-year limited warranty, see hew.com/warranty.

IMPORTANT:

Electrostatic sensitive unit. Observe precautions when handling.

GP2-P136/840-W Total Luminaire Output: 13600 lumens; 100 Watts
 Efficacy: 136 lm/W | 82.2 CRI; 4000K CCT | IES Spacing Crit.: End: 1.3, Across: 1.3, Diagonal: 1.3

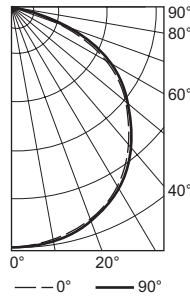

CANDLEPOWER DISTRIBUTION	Vertical Angle	Horizontal Angle			Zonal Lumens
		0°	45°	90°	
0	4726	4726	4726		
5	4741	4717	4695	449	
15	4605	4598	4572	1296	
25	4298	4321	4321	1989	
35	3855	3899	3940	2438	
45	3260	3303	3322	2550	
55	2531	2582	2611	2303	
65	1685	1754	1492	1657	
75	784	671	574	769	
85	109	110	105	151	
90	0	0	0		

LUMEN SUMMARY	Zone	Lumens	% Fixture
	0 - 30	3733	27
	0 - 40	6171	45
	0 - 60	11023	81
	0 - 90	13600	100
	0 - 180	13600	100

GP2-P136/840-M Total Luminaire Output: 12921 lumens; 100 Watts
 Efficacy: 129 lm/W | 82.0 CRI; 4000K CCT | IES Spacing Crit.: End: 1.3, Across: 1.4, Diagonal: 1.5

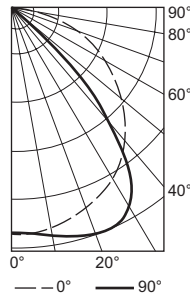

CANDLEPOWER DISTRIBUTION	Vertical Angle	Horizontal Angle			Zonal Lumens
		0°	45°	90°	
0	5497	5497	5497		
5	5494	5516	5532	527	
15	5346	5608	5771	1582	
25	5038	5623	5861	2551	
35	4565	5359	4976	3119	
45	3889	4077	2121	2674	
55	3071	1256	177	1537	
65	2127	138	16	709	
75	1054	12	5	186	
85	159	3	1	36	
90	0	0	0		

LUMEN SUMMARY	Zone	Lumens	% Fixture
	0 - 30	4660	36
	0 - 40	7779	60
	0 - 60	11990	93
	0 - 90	12921	100
	0 - 180	12921	100

GP2-P136/840-N Total Luminaire Output: 12784 lumens; 100 Watts
 Efficacy: 128 lm/W | 82.2 CRI; 4000K CCT | IES Spacing Crit.: End: 1.2, Across: .9, Diagonal: 1.0

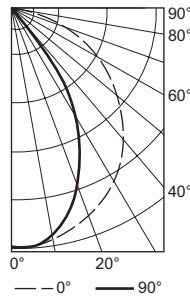

CANDLEPOWER DISTRIBUTION	Vertical Angle	Horizontal Angle			Zonal Lumens
		0°	45°	90°	
0	8499	8499	8499		
5	8407	8538	8396	805	
15	8148	8053	7657	2240	
25	7544	6631	5595	3034	
35	6674	4541	3155	2962	
45	5517	2338	28	1956	
55	4134	42	0	1094	
65	2656	0	0	506	
75	1181	0	0	161	
85	106	0	0	26	
90	0	0	0		

LUMEN SUMMARY	Zone	Lumens	% Fixture
	0 - 30	6080	48
	0 - 40	9041	71
	0 - 60	12091	95
	0 - 90	12784	100
	0 - 180	12784	100

FIXTURE PERFORMANCE DATA

LED PACKAGE	DELIVERED LUMENS	WATTAGE	EFFICACY (lm/W)
P136 ¹	13600	100	136

- ¹ Fixture contains two nodes; one power drop per node required.
- Photometrics tested in accordance with IESNA LM-79. Results shown are based on 25°C ambient temperature.
 - Results based on relative CCT output.
 - Use multiplier tables to calculate additional options.
 - Performance is the same for 4000 and 5000 CCT.

MULTIPLIER TABLES

DISTRIBUTION	
N	0.94
M	0.95
W	1.00

LENS	
CL	0.94
DL	0.76

FIXTURE DETAILS

BACK VIEW

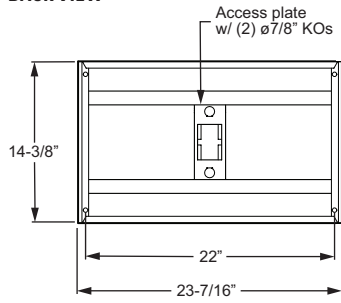

UPLIGHT MODULE (UPM Option)

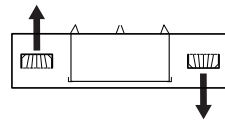

MOUNTING ACCESSORIES

GS/Y26/10

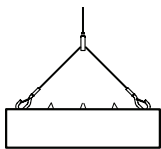

VBY or VBY-2

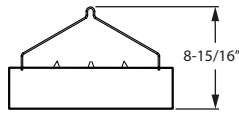

HUB MT 3/4"

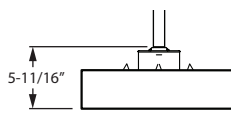

HUB/HOOK MT

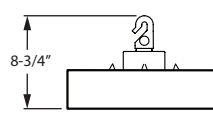

SURFACE MOUNT KIT (Shipped separately)

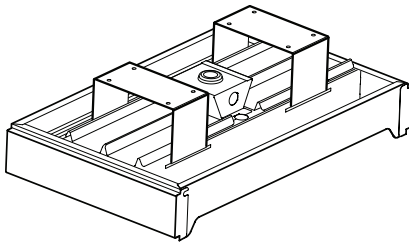

CROSS SECTION

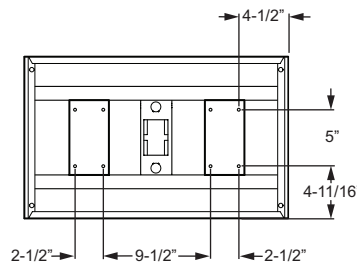

BACK VIEW

UPLIGHT % OF TOTAL FLUX	
UPLIGHT REFLECTOR	
N	8.4
M	8.2
W	8.6
CL	10.0
DL	16.0
UPLIGHT MODULES	
UPM	50.0
UPMA	100.0

OPTIONS

CLEAR LENS



DIFFUSE LENS



ACCESSORIES

WIREGUARD

