

ARCHITECTURAL VANDAL WRAP

AVX

tunable **WHITE** | PoE



CATALOG #: _____ TYPE: _____

PROJECT: _____ NOTES: _____

EXAMPLE **AVX - 4 - P53 / 835 - CPC - OPTIONS - POE N**

SERIES NOMINAL LENGTH LUMEN PACKAGE CRI & CCT SHIELDING OPTIONS/ACCESSORIES CONTROL

CROSS SECTION

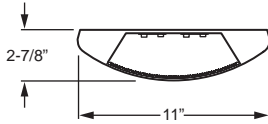

ORDERING INFORMATION

SERIES
AVX Architectural Vandal Wrap – PoE

NOMINAL LENGTH

4	4'
8	8' (two 4' units end-to-end)

LED PACKAGE

Example: P53/835		
LUMEN PACKAGE	NOMINAL LUMENS	WATTAGE
4'		
P25	2,500	25
P53	5,300	51
8'		
P50	5,000	46
P108	10,800	97

Nominal lumen output based on 3500K for single CCT and 4000K for TW and CPC shielding. Actual lumens may vary +/-5%, see fixture performance data.

CRI & CCT

827	82 CRI, 2700K
830	82 CRI, 3000K
835	82 CRI, 3500K
840	82 CRI, 4000K
850	82 CRI, 5000K
8TW	Tunable white (80 CRI, 3000K–5000K)

SHIELDING

CPC Clear, UV stabilized polycarbonate, .150" thick
WPC White, UV stabilized polycarbonate, .150" thick

OPTIONS

Suspended fixtures require power supply cable, see page 3. For color options, visit the AVX online at hew.com.

EM/CP12 Remote mount 12-watt Iota emergency LED battery (requires one additional category cable run to switch, see page 2 for details.)

ACCESSORIES (Must be ordered separately)

See hew.com/poe for compatible sensors & switches. See page 3 for suspended mounting accessories.

TPSN-8 #8, tamper-resistant (snake eyes) tool. (Tamper resistant (TPSN-8) tool must be ordered separately. Please specify quantity required per project.)

AVX-4 CMB 4', vandal-resistant corner mount

CONTROL

For additional PoE info, see hew.com/poe. 4' fixture requires remote mounting, see page 3 for details.

POE N Power over Ethernet network node
POE D Power over Ethernet device node

FEATURES

- ▶ Williams turn-key Power over Ethernet (PoE) solution provides plug-and-play networked lighting and control.
- ▶ Tunable white from 3000K to 5000K CCT, minimum 80 CRI.
- ▶ Efficacies up to 111 lm/W.
- ▶ Ideal for schools, hallways, stairwells, dormitories, locker rooms, or vandal prone areas.
- ▶ Heavy-duty marine grade aluminum housing, die-cast end caps, and extremely durable impact-resistant polycarbonate lens add strength and durability.
- ▶ Tamper-resistant #8 snake eye screws provided to protect against vandals.
- ▶ Designed for surface, wall, pendant, or vandal-resistant corner mount.
- ▶ ADA compliant in wall mount applications.
- ▶ Features easy row mount capability with integral alignment pieces.
- ▶ This fixture is proudly made in the USA.

SYSTEM REQUIREMENTS

- Lighting system (site software)
- Gateway or alternate server (runs software)
- PoE switches or Ethernet switches and mid-span power injectors
- See hew.com/poe for details



SPECIFICATIONS

Housing – Marine grade aluminum. Extruded housing with die-cast end caps.

Shielding – UV stabilized polycarbonate lens, .150" thick.

Reflective Surfaces – 92% minimum average reflective white powder coat on interior components.

Finish – Textured matte white polyester TGIC powder coat bonded to phosphate-free, multi-stage pretreated metal. All parts painted after fabrication to facilitate installation, increase efficiency, and inhibit corrosion.

Electrical – High quality mid-power LED board. L70 > 50,000 hours per IES TM-21. Low-voltage DC fixture, to be fed by Class 2 power supply. Tunable White products use LEDs of multiple CCTs and may produce a perceptibly different shade of white from single-CCT products at the same CCT. All CCTs are within 3 MacAdam ellipses.

Mounting – Surface (ceiling or wall). Suspended (hanging hardware required).

Labels – cCSAus certified as luminaire suitable for dry or damp locations.

Warranty – 5-year limited warranty, see hew.com/warranty.

IMPORTANT:

Electrostatic sensitive unit. Observe precautions when handling.

CORNER MOUNT BRACKET

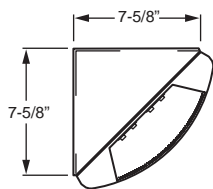

FIXTURE PERFORMANCE DATA

STANDARD

LED PACKAGE	DELIVERED LUMENS		WATTAGE	EFFICACY (lm/W)	
	CPC	WPC		CPC	WPC
4'					
P25	2529	1821	24.8	102.0	73.4
P53	5312	3825	50.5	105.2	75.7
8'					
P50	5019	3614	46.4	108.1	77.8
P108 ¹	10853	7814	97.2	111.6	80.4

¹ Fixture contains two nodes, one power drop per node required.

TUNABLE WHITE

LED PACKAGE	DELIVERED LUMENS		WATTAGE	EFFICACY (lm/W)	
	CPC	WPC		CPC	WPC
4'					
P25	2521	1815	25.1	100.5	72.4
P53	5340	3845	51.2	104.4	75.2
8'					
P50	5000	3600	47.0	106.3	76.5
P108 ¹	10832	7799	99.6	108.7	78.3

MULTIPLIER TABLES

STANDARD

CCT	CONVERSION FACTOR
2700K	0.97
3000K	0.99
3500K	1.00
4000K	1.03
5000K	1.06

TUNABLE WHITE

CCT	CONVERSION FACTOR
3000K	0.95
3500K	0.98
4000K	1.00
5000K	0.96

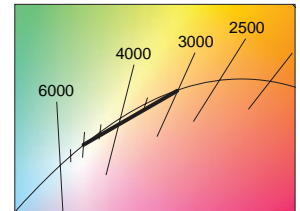

- Photometrics tested in accordance with IESNA LM-79. Results shown are based on 25°C ambient temperature.
- Standard results based on 3500K standard, 80 CRI, actual lumens may vary +/-5%
- Tunable white results based on 4000K standard, 80 CRI, actual lumens may vary +/-5%
- Use multiplier table to calculate additional options.

PHOTOMETRY

AVX-4-P53/835-CPC Total Luminaire Output: 5312 lumens; 50.5 Watts
 Efficacy: 105 lm/W | 83.6 CRI; 3500K CCT | IES Spacing Criteria: End: 1.3, Across: 1.3

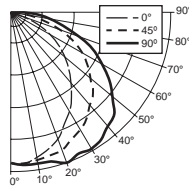

Vertical Angle	Horizontal Angle			Zonal Lumens
	0°	45°	90°	
0	1736	1736	1736	
5	1746	1756	1770	167
15	1603	1702	1792	484
25	1373	1581	1788	732
35	1127	1462	1744	891
45	837	1287	1599	938
55	563	1007	1281	838
65	335	726	943	650
75	126	407	562	394
85	21	169	286	175
90	5	80	160	

LUMEN SUMMARY	Zone	Lumens	% Fixture
	0 - 30	1382	26
	0 - 40	2273	43
	0 - 60	4049	76
	0 - 80	5268	99
	0 - 180	5312	100

FIXTURE DETAILS

BACK VIEW-4'

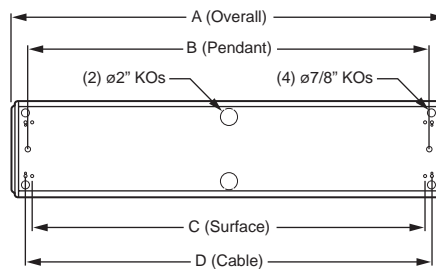

Actual Lengths

Dimension Types	4' Unit	8' Unit
A (Overall)	48-1/16"	95-9/16"
B (Pendant)	45-7/16"	92-5/16"
C (Surface)	44"	91-1/2"
D (Cable)	46"	93-1/2"

For continuous row applications, subtract 7/8" from dimension "A" for every additional fixture per row.

BACK VIEW-8'

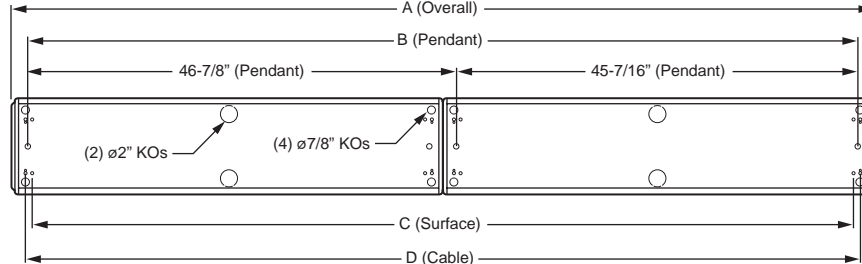

REMOTE MOUNT DETAILS

Includes 2' plenum-rated 18ga. solid cable. Remote box can be installed in:

- Above ceiling grid
- Remote closet (within 100ft)
- Surface below ceiling

See [Technical Info](#) for dimension details.

NODE

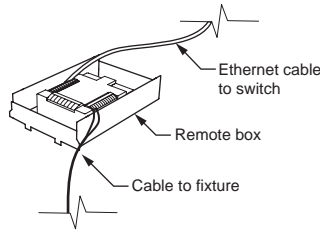

NODE AND EM OPTION

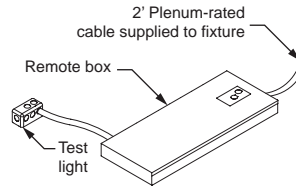

SUSPENDED MOUNT DETAILS

AIRCRAFT CABLE

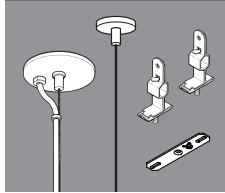

EXAMPLE: ACF(Y12)/D48

MOUNTING	TYPE	LENGTH
ACF(Y12) = Aircraft	D = 1' grid & hardpan	24 = 24"
	N = 9/16" grid	48 = 48"
	S = Slot grid	96 = 96"

Fixtures are provided with adjustable length aircraft cables and mounting hardware, must specify.

POWER SUPPLY CABLE

Required for aircraft cable mounted fixtures. Please specify cord type using ordering example below.

EXAMPLE: P24/W

CORD TYPE	LENGTH	COLOR
P = PoE	24 = 24"	/W = White /B = Black
	48 = 48"	
	96 = 96"	

