

ARCHITECTURAL SURFACE MOUNT

ASM

tunable **WHITE**

CATALOG #: _____ TYPE: _____

PROJECT: _____ NOTES: _____

EXAMPLE **ASM - 4 - L46/8TW - P - F - A - AC(Y12)/D24 - OPTIONS - DALI - UNV**

SERIES NOMINAL LENGTH LUMEN PACKAGE CRI & CCT MOUNTING TYPE FIXT. TYPE SHIELDING MOUNTING OPTIONS/ACCESSORIES DRIVER VOLTAGE

CROSS SECTION

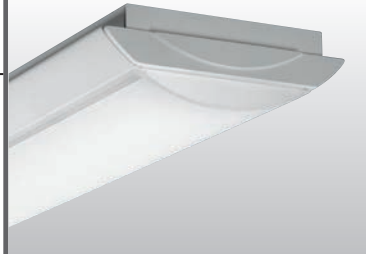
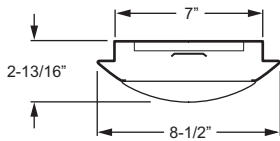

ORDERING INFORMATION

SERIES
ASM Architectural Surface Mount – Tunable White

NOMINAL LENGTH

4	4'
8	8'

LED PACKAGE

EXAMPLE: L46/8TW		
LUMEN PACKAGE	NOMINAL LUMENS	WATTAGE
4'		
L25	2,500	19
L46	4,600	38
8'		
L50	5,000	38
L92	9,200	77

Nominal lumen output based on 4000K CCT. Actual lumens may vary +/-5%, see fixture performance data. Additional LED lumen packages available, see options.

CRI & CCT
8TW Tunable white (80 CRI, 3000K–5000K)

MOUNTING TYPE
 See page 3 for details
S Surface
P Suspended (must specify, see Mounting)
R Semi-recessed (available in stand-alone fixtures only)

FIXTURE TYPE (Surface or suspended only)
F Electrical feeder unit, two end caps packed with fixture, quick-connect wiring harness. Suspended includes straight white cord standard (wire gauge to be determined by row length)
J Joiner unit, quick-connect wiring harness
S Stand-alone unit, two end caps included. Suspended includes straight white cord standard (wire gauge to be determined by row length)

SHIELDING
A Ribbed acrylic diffuser

MOUNTING (Suspended mounting type only)
 See page 3 for details.

EXAMPLE: AC(Y12)/D24		
PREFIX	TYPE	LENGTH
ADJUSTABLE AIRCRAFT CABLE		
AC(Y12/)	D = 1" grid & hardpan	24 = 24"
	N = 9/16" grid	48 = 48"
	S = Slot grid	96 = 96"
PENDANT MOUNT USING STEM (3/8" IPS) AND CANOPY (ø5")		
SS-__		Specify length in inches (4" minimum)

Note: Power cord provided with aircraft cables only

OPTIONS
EM/10WLP Low profile 10-watt emergency battery (120V-277V only)
AMW (L__) Anti-microbial white finish. Additional lower lumen packages available. Specify in increments of 100 nominal lumens. Option must be specified with next *higher* lumen package. **Example:** 3,500 nominal lumens = ASM-4-L46/8TW-A-(L35)

CONTROL
 See page 3 for details.
DALI Driver prewired for DALI applications
DIM (1) 0-10V signal to control dimming
 (1) 0-10V signal to control CCT
DMX Driver prewired for DMX applications

VOLTAGE

120	120V
277	277V
UNV	120-277V

FEATURES

- ▶ Tunable white from 3000K to 5000K CCT, minimum 80 CRI.
- ▶ Surface or semi-recessed mount for ultra-low-profile appearance.
- ▶ Efficacies up to 131 lm/W.
- ▶ Suspended mount available.
- ▶ Decorative die-cast aluminum end caps provide high-end appearance.
- ▶ Optional anti-microbial white finish available for use in healthcare applications.
- ▶ This fixture is proudly made in the USA.



SPECIFICATIONS

Housing – .040" die-formed aluminum with die-cast decorative end caps.
Shielding – Ribbed acrylic diffuser.
Finish – Textured matte white polyester TGIC powder coat bonded to phosphate-free, multi-stage pretreated metal. All parts painted after fabrication to facilitate installation, increase efficiency, and inhibit corrosion.
Electrical – High quality mid-power LED board. L85 > 50,000 hours per IES TM-21. Tunable White products use LEDs of multiple CCTs and may produce a perceptibly different shade of white from single-CCT products at the same CCT. All CCTs are within 3 MacAdam ellipses.
Mounting – Semi-recessed in NEMA Type "G" ceiling, surface (ceiling or wall), or suspended.
Labels – cCSAus certified as luminaire suitable for dry or damp locations.
Warranty – 5-year limited warranty, see hew.com/warranty.

IMPORTANT:

Electrostatic sensitive unit. Observe precautions when handling.

FIXTURE PERFORMANCE DATA

LED PACKAGE	DELIVERED LUMENS	WATTAGE	EFFICACY (lm/W)
4'			
L25	2509	19.1	131.2
L46	4726	38.3	123.3
8'			
L50	5018	38.2	131.2
L92	9451	76.7	123.3

- Photometrics tested in accordance with IESNA LM-79. Results shown are based on 25°C ambient temperature.
- Wattage shown is average for 120V through 277V input.
- Results based on 4000K, 80 CRI, actual lumens may vary +/-5%
- Use multiplier table to calculate additional options.

MULTIPLIER TABLE

CCT	CONVERSION FACTOR	
	LUMENS	WATTAGE
3000K	0.95	1.04
3500K	0.98	1.02
4000K	1.00	1.00
5000K	0.96	1.04

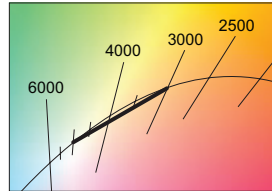

PHOTOMETRY

ASM-4-L46/8TW-A-S-DALI-UNV Report #: 18639.1; 02/17/15 | Total Luminaire Output: 4726 lumens; 38.3 Watts
 Efficacy: 123 lm/W | 82 CRI; 3456K CCT | IES Spacing Crit.: End: 1.2, Across: 1.2, Diag.: 1.2

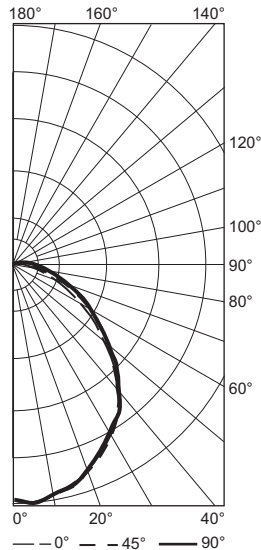

Vertical Angle	Horizontal Angle			Zonal Lumens
	0°	45°	90°	
0	1809	1809	1809	
5	1839	1837	1837	173
15	1758	1753	1746	491
25	1591	1578	1573	726
35	1382	1380	1380	853
45	1055	1085	1093	828
55	707	771	788	682
65	416	508	525	487
75	191	290	309	290
85	49	138	167	137
90	12	79	113	
95	0	41	73	46
105	0	0	24	10
115	0	0	0	2
125	0	0	0	0
135	0	0	0	0
145	0	0	0	0
155	0	0	0	0
165	0	0	0	0
175	0	0	0	0
185	0	0	0	0

LUMEN SUMMARY	Zone	Lumens	% Fixture
	0 - 30	1390	29
0 - 40	2243	48	
0 - 60	3753	79	
0 - 90	4668	99	
90 - 120	58	1	
90 - 150	58	1	
90 - 180	58	1	
0 - 180	4726	100	

FIXTURE DETAILS

BACK VIEW

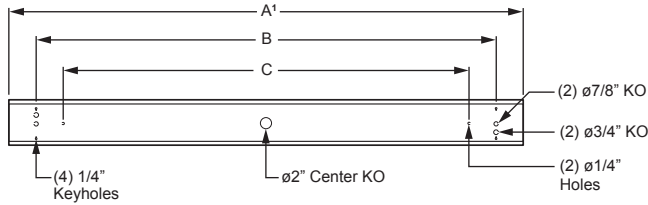

	A ¹	B	C
4'	46-13/16"	40"	32"
8'	93-5/8"	87"	80"

¹ Dimension A is for row-mounted units without end caps. End caps add 3/4" to dimension A.

MOUNTING TYPES

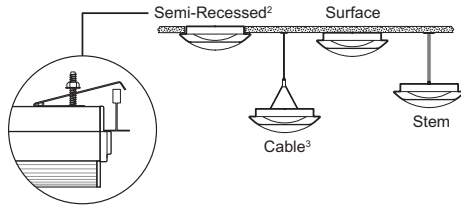

² Semi-recessed model is suitable for installation in NEMA Type "G" ceiling system of 1" wide (nominal) tees mounted across ends of fixture 48" O.C., using factory furnished mounting brackets. Fixtures may be mounted in continuous row. Ceiling tiles are supported along sides by fixture housing. Fixture protrudes 2" below ceiling plane.

³ Depending on installation method, cable mounting may require additional counter-weights due to side-mounted driver.

ROW ALIGNER (Not available with semi-recessed units.)

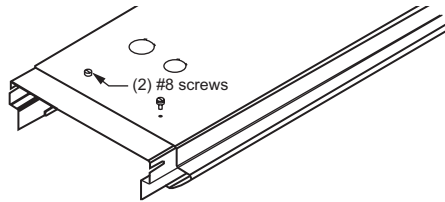

CONTROL DETAILS

DIM



DALI



DMX



STANDARD SUSPENDED HARDWARE (Grid and Hardpan)

FEEDER

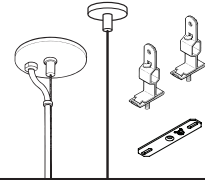

JOINER

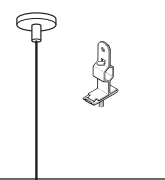

Notes:

- Fixtures are provided with adjustable length aircraft cables with two-point "Y" connectors and mounting hardware, must specify.
- Electrical supply is brought into the feeder fixture, either as part of a row or as a stand-alone unit. Joiner fixtures complete the row.
- The feeder kits are standard with a 5" canopy to cover the junction box and a 2" canopy at the non-feed point. No J-box is required at non-feed points.