

Shown with PC Shielding

CATALOG #: _____

TYPE: _____

PROJECT: _____

FEATURES

- Fully gasketed fixture resists dust, bugs, and moisture
- Polycarbonate toggle latches ensure a tight seal and provide easy access to electrical components
- Optional tamper-resistant latches available
- Closed-cell polyurethane gasket poured and formed in place to ensure tight seal – does not absorb water or support fungal growth
- TLED fixtures provide on-site lamping flexibility and simple installation
- Stainless steel latches are available for harsh environments
- Made Right Here® in the USA

SPECIFICATIONS

- ENCLOSURE – Outer housing consists of 5VA (f1) fiberglass, rated for flame and weather resistance.
- INTERNAL HOUSING – 25-gauge die-formed C.R.S.
- LATCHING – Injection-molded polycarbonate latches.
- REFLECTIVE SURFACES – 92% minimum average reflective white polyester powder coat bonded to phosphate-free, multi-stage pretreated metal.
- SHIELDING – Clear polycarbonate or acrylic UV stabilized diffuser.
- ELECTRICAL – Prewired for Type B, single or double end, LED tubes. Lamps by others.
- MOUNTING – Surface or suspended. Stainless steel ceiling mount bracket standard.
- LISTINGS –
 - UL/CUL listed as LED surface luminaire suitable for dry or damp locations.
 - UL/CUL listed as suitable for wet locations when specified with watertight hub, STOW cord, or mini-male receptacle option.
 - NSF/ANSI Standard 2–Splash Zone certified, IP65, IP66, and IP67 certified, and rated for NEMA 4X.
- WARRANTY – 5-year limited warranty, see hew.com/warranty.

ORDERING EXAMPLE: 96 - 4 - 24T8LS/B - PC - OPTIONS - UNV

ORDERING INFO

SERIES	NOMINAL LENGTH	TOTAL LAMPS ⁽¹⁾	LAMP SIZE	WIRING	LAMP TYPE
96	4 4'	4' Fixtures	4T5L 4' T5 LED tube	S Single end	B Type B
	8 8'	1, 2, or 3 8' Fixtures	4T8L 4' T8 LED tube	D Double end	

SHIELDING		OPTIONS ⁽²⁾		VOLTAGE
PC	Drop, clear, 100% polycarbonate diffuser ⁽³⁾	3WC6	3-wire, 6' STOW cord	UNV 120-277V
HIA	Drop, high-impact injection-molded acrylic ⁽⁴⁾	3WC20	3-wire, 20' STOW cord	
HIAFR	Frosted, ribbed, impact-resistant acrylic	3WMR	3-wire mini-male receptacle only	
DFR	Drop, frosted, 100% acrylic, impact-resistant diffuser	3WMRC6	3-wire mini-male receptacle with 6' STOW cord	
DCL	Drop, clear, 100% acrylic, impact-resistant diffuser with frosted ends	3WMRC20	3-wire mini-male receptacle with 20' STOW cord	
		WET/1	(1) 1/2" watertight hub ⁽⁵⁾	
		WET/2	(2) 1/2" watertight hubs ⁽⁶⁾	
		SSCMB	Stainless steel chain mounting brackets ⁽⁷⁾	
		TP	Tamper-resistant polycarbonate latches ⁽⁸⁾	
		SS LATCH	Stainless steel latches	
		TP/SS LATCH	Tamper-resistant stainless steel latches ⁽⁹⁾	
		WMB	Stainless steel 45° wall mount bracket ⁽¹⁰⁾	
		GMF	Fuse, slow blow	
		GLR	Fuse, fast blow	

OCCUPANCY SENSORS

OCCWS HB350W-L3W Factory-installed occupancy sensor⁽¹¹⁾

NOTES

- 1, 2, or 3-lamp cross-section
- Wet location cord sets are yellow. See page 2 for MOUNTING DETAILS.
- Vacuum-formed. 4' only, standard
- Standard in 8' units
- Factory-installed in end of housing
- Factory-installed in ends of housing. Not available with occupancy sensor option
- 2 per fixture, field installed

- Requires a tamper-resistant tool. Must be ordered separately. Please specify quantity required per project.
- Requires a tamper-resistant tool. Must be ordered separately. Please specify quantity required per project.
- 2 per fixture
- Not available with IP66 or IP67 certification when specified with occupancy sensor. See page 2 for OCCUPANCY SENSOR DETAILS.



FIXTURE DETAILS

BACKVIEW

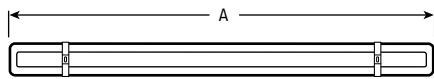

NOMINAL LENGTH	ACTUAL LENGTH (A)
4'	51-3/4"
8'	100"

MOUNTING DETAILS

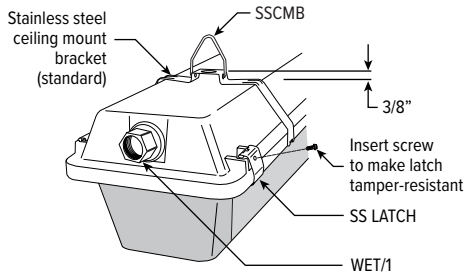

WMB OPTION

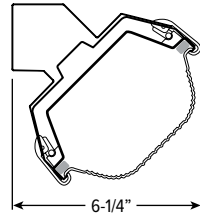

Wet location listed with fixture lens facing down

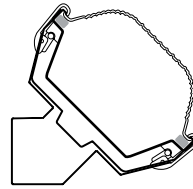

Dry or damp location only with fixture lens facing up

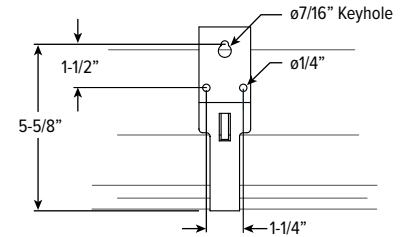

CROSS SECTIONS

PC | HIA

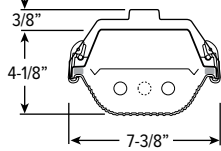

DCL | DFR

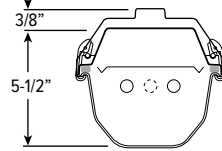

OCCUPANCY SENSOR DETAILS

ORDERING EXAMPLE: OCCWS HB350W-L3W

FEATURES

- Line voltage passive infrared (PIR)
- Adjustable time delay (15 seconds to 30 minutes)
- Factory preset to 15 minutes
- IP65 rated for use in wet locations
- 24' diameter coverage at 20' mounting height

LENS COVERAGE PATTERN

Top View

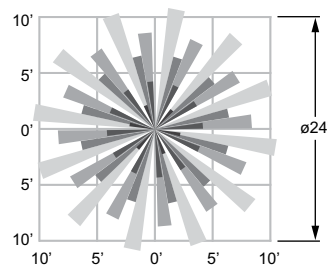

Side View

