

CATALOG #: _____

Type: _____

PROJECT: _____

FEATURES

- Two heavy-duty, spring-loaded quarter-turn fasteners secure reflector to housing
- Channel connector furnished for continuous row applications
- Heavy-duty ribbed reflector
- Maximize energy savings with efficacies as high as 158 lm/W
- Made Right Here® in the USA

SPECIFICATIONS

- HOUSING** – 20-gauge die-formed, ribbed C.R.S.
- REFLECTOR** – 22-gauge die-formed, ribbed C.R.S.
- FINISH** – 92% minimum average reflective white polyester powder coat bonded to phosphate-free, multi-stage pretreated metal. All parts painted after fabrication to facilitate installation, increase efficiency, and inhibit corrosion.
- ELECTRICAL** – High quality mid-power LED boards. L85 at 50,000 hours. 45°C maximum ambient operating temperature.
- MOUNTING** – Surface or suspended.
- LISTINGS** –
 - cCSAus certified as luminaire suitable for dry or damp locations.
 - DesignLights Consortium qualified product. Not all versions of this product may be DLC qualified, see the DLC Qualified Products List at www.designlights.org/QPL
- WARRANTY** – 5-year limited warranty, see hew.com/warranty.

ORDERING EXAMPLE: 82 - 4 - L107/840 - OPTIONS - DIM - UNV

ORDERING INFO

SERIES	LENGTH	LUMENS ^[1]	CRI	CCT
82	4 4'	L64 6,400lm	8 80	35 3500K
	8 8'	L107 10,700lm		40 4000K
		L128 12,800lm		50 5000K
		L214 21,400lm		

OPTIONS

- EM/10W (L__)** 10-watt emergency battery
Additional lower lumen packages available.
Example: 9,500 lumens = 82-4-L107/840-(L95) ^[3]
- WG-8211** 11-gauge white powder coat wireguard
- WG-8214** 14-gauge white powder coat wireguard
- RA-82** Steel reflector row aligner ^[4]
- MSA** Myers sway adapter
- T-2** Tong hanger
- 325** 1-1/2" ceiling spacer
- GAT** GAT fastener ^[5]
- VBY** (2) Y-hangers
- VBY-2** (2) Y-hangers and (2) 2' chains

CONTROL ^[2]

- DIM** Dimming driver
- DRV** Non-dimming driver

VOLTAGE

- 120** 120V
- 277** 277V
- UNV** 120-277V
- 480** 480V ^[6]



NOTES

- Lumen output based on 4000 CCT. Actual lumens may vary +/-5%. See page 2 for FIXTURE PERFORMANCE DATA.
- See page 2 for ADDITIONAL CONTROL OPTIONS.
- Specify in increments of 100 nominal lumens. Option must be specified with next higher lumen package.
- 1 pair.
- T-bar clip.
- With stepdown transformer. Not available with EM drivers.



FIXTURE PERFORMANCE DATA

	LED PACKAGE	DELIVERED LUMENS	WATTAGE	EFFICACY (lm/W)
4'	L64	6526	42.8	152.5
	L107	10828	68.3	158.5
8'	L128	12887	81.9	157.4
	L214	21656	136.7	158.5

MULTIPLIER TABLE

COLOR TEMPERATURE	
CCT	CONVERSION FACTOR
3500K	0.97
4000K	1.00
5000K	1.03

- Photometrics tested in accordance with IESNA LM-79. Results shown are based on 25°C ambient temperature.
- Wattage shown is average for 120V through 277V input.
- Results based on 4000K, 80 CRI, actual lumens may vary +/-5%
- Use multiplier table to calculate additional options.

PHOTOMETRY

82-4-L107/840-DRV-UNV Total Luminaire Output: 10828 lumens; 68.3 Watts | Efficacy: 159 lm/W | 80 CRI; 4000K CCT

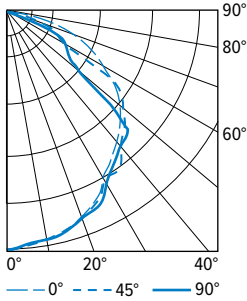

VERTICAL ANGLE	HORIZONTAL ANGLE			ZONAL LUMENS
	0°	45°	90°	
0	4043	4043	4043	
5	4108	4001	3996	383
15	3996	3889	4043	1116
25	3762	3791	3653	1714
35	3423	3324	3324	2117
45	2949	2904	2866	2216
55	2337	2315	1201	1718
65	1616	880	863	1087
75	787	175	163	400
85	92	46	20	77
90	3	12	0	

LUMEN SUMMARY	ZONE	LUMENS	% FIXTURE
	0 - 30	3213	30
	0 - 40	5329	49
	0 - 60	9263	86
	0 - 90	10828	100
	0 - 180	10828	100

ADDITIONAL CONTROL OPTIONS

Note: Lumen restrictions apply, consult product builder at hew.com/product-builder.

CATALOG NUMBER	DESCRIPTION
DRV	Driver prewired for non-dimming applications
DIM	Dimming driver prewired for 0-10V low voltage applications
DIM1	1% dimming driver prewired for 0-10V low voltage applications
DIM LINE	Line voltage dimming driver (Must specify 120V or 277V only)
SD40	40% step-dimming driver
SD50	50% step-dimming driver
DALI	DALI dimming driver
LTE LINE	Lutron Hi-lume 1% 2-wire dimming driver forward phase line voltage controls (120V only)
LDE1	Lutron Hi-lume 1% EcoSystem dimming LED driver
LDE5	Lutron 5-Series 5% EcoSystem dimming LED driver
ELDO SOLOB	EldoLED Solodrive, 0.1% dimming driver for 0-10V controls
ELDO SOLOB DALI	EldoLED Solodrive, 0.1% dimming driver for DALI controls
ELDO ECO1	EldoLED Ecodrive, 1% dimming driver for 0-10V controls
ELDO ECO1 DALI	EldoLED Ecodrive, 1% dimming driver for DALI controls

FIXTURE DETAILS

BACKVIEW

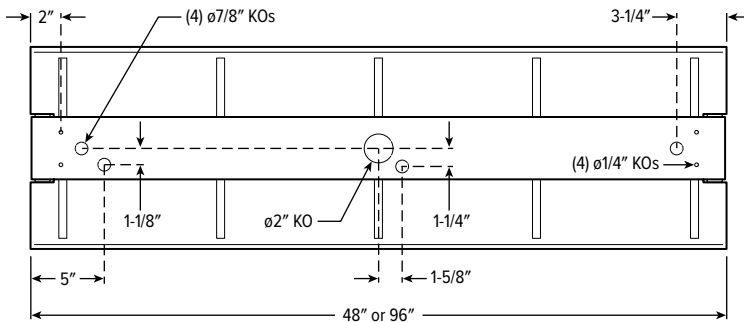

MOUNTING ACCESSORIES DETAILS

MSA

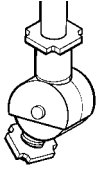

325

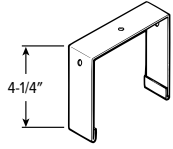

GAT

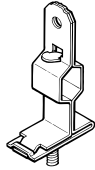

T-2

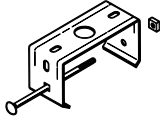

VBY OR VBY-2



WG-8011 OR WG-8014

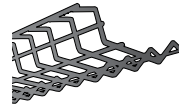

RA-80

