

# 8DR LED 8" High Output Downlight – Round

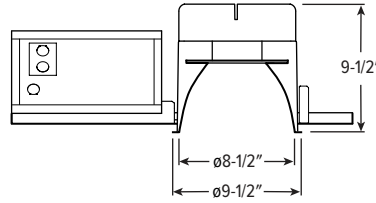

CATALOG #: \_\_\_\_\_

TYPE: \_\_\_\_\_

PROJECT: \_\_\_\_\_

## NEW CONSTRUCTION AND REMODEL

### FEATURES

- High-output illumination for tall ceiling applications
- Beam angles ranging from 35° narrow to 65° wide for tailored performance
- Open reflector with 9 finishes to complement any interior style
- Spring clip retention system eliminates trim sag
- Fully room-side accessible

### SPECIFICATIONS

- HOUSING** – Die-cast aluminum lamp housing with forged aluminum heat sink. Galvanized steel splice compartment with driver mounting box/enclosure. Swing-out mounting arms adjust for ceiling thickness from 1/2" - 1-7/16" (see options for additional ceiling thicknesses).
- OPEN REFLECTOR** – Low-iridescent anodized aluminum. Clear specular finish standard.
- ELECTRICAL** – High-power LEDs on multi-channel metal core PCB. Modular quick-connect plug for easy field-connection of LED light assembly to driver. Reported L70>60,000 hours. Reported L90>59,000 hours. Estimated L70 = 177,000 hours.
- MOUNTING** – Recessed. 20 ga. galvanized steel mounting pan for new construction. Remodel kit option includes receiver bracket hardware. Minimum 24" O.C. marked spacing required. Minimum 3" clearance above for L40 and L60 lumen packages. Minimum 5" clearance above for L80 and L100 lumen packages.
- LISTINGS** –
  - cCSAus conforms to UL STD 1598; Certified to CAN/CSA STD C22.2 No. 250.0 for damp locations. LED light assembly conforms to UL 2108 for remote installation.
  - Suitable for wet location under covered ceiling.
  - Complies with ASTM-E283 when specified with ATH option.
  - RoHS compliant.
- WARRANTY** – 5-year limited warranty, see [hew.com/warranty](http://hew.com/warranty).

ORDERING EXAMPLE: **8DR - L100/835 - OPTIONS - DIM - 120 - OW - SPC - TRIM OPTIONS - N - BA1**

### HOUSING

SERIES	LUMENS <sup>[1]</sup>	CRI	CCT	OPTIONS	DRIVER <sup>[2]</sup>	VOLTAGE
8DR	L40 4,000lm, 2 channel	8 80 9 90 <sup>[3]</sup>	27 2700K <sup>[4]</sup> 30 3000K 35 3500K <sup>[5]</sup> 40 4000K <sup>[6]</sup>	SCA__ Sloped ceiling adapter <sup>[7]</sup>	DIM Dimming driver, 0-10V	120 120V 277 277V
	L60 6,000lm, 3 channel			ATH Airtight construction	DIM1 1% Dimming driver, 0-10V	347 347V <sup>[11]</sup>
	L80 8,000lm, 4 channel			F Fuse		
	L100 10,000lm, 5 channel			EM/12W 12-watt emergency battery <sup>[8]</sup>		
				EM/12W/RTS 12-watt emergency battery with regressed test switch <sup>[9]</sup>		
				SDT Stepdown transformer <sup>[10]</sup>		
				TC Adjustable mounting arms for 1-1/2" – 2-1/4" thick ceilings		

### TRIM<sup>[12]</sup>

TRIM TYPE	DISTRIBUTION <sup>[13]</sup>	REFLECTOR FINISH	TRIM OPTIONS
O Open reflector	W 65° Wide	SPC Clear specular anodize	MWT Textured white trim flange <sup>[14]</sup>
	M 50° Medium	CS Clear semi-specular anodize	WET/CC Wet location, covered ceiling listed <sup>[15]</sup>
	N 35° Narrow	SG Satin-glow anodize	AM Anti-microbial <sup>[16]</sup>
		GD Gold anodize	
		CG Champagne gold anodize	
		PW Pewter anodize	
		RG Rose gold anodize	
		WH White texture powder coat	
		BL Black texture powder coat	

### MOUNTING

MOUNTING TYPE <sup>[17]</sup>	MOUNTING HARDWARE <sup>[18]</sup>
N Open pan for new construction <sup>[19]</sup>	BA1 Adjustable butterfly pan bracket, bar hanger not included
R Remodel kit <sup>[20]</sup>	BA2 Adjustable butterfly pan bracket, heavy-duty universal bar hanger included

### NOTES

- Lumen output based on O trim type, W distribution and CS finish, 3500K/80CRI. Actual lumens may vary +/-5%. See page 2 for FIXTURE PERFORMANCE DATA.
- See page 3 for ADDITIONAL DRIVER OPTIONS.
- Extended lead times may apply. Consult factory for availability.
- 90 CRI only.
- 80 CRI only.
- 80 CRI only.
- 14" aperture, specify degrees of slope in 5° increments, 05°-30°. See page 3 for SLOPED CEILING ADAPTOR DETAILS. Not available with ATH or TC options. N Mounting Type only. Not available with WET/CC.
- N Mounting Type only.
- Not available with WET/CC or ATH options. N Mounting Type only. Consult factory for details.
- May be required for 347V, see product builder at [hew.com/product-builder](http://hew.com/product-builder).
- Not available with EM batteries or DMX controls.
- Trim ships separately.
- Available with Beam angle based on SPC reflector finish.
- Not available with WH Reflector Finish.
- Reduces lumen output, use .85 multiplier.
- WH and BL Reflector Finishes only.
- See page 3 for MOUNTING TYPE DETAILS.
- Specify for N Mounting Type only. See page 4 for MOUNTING HARDWARE DETAILS.
- Mounting hardware required (N only), ordered separately, see MOUNTING HARDWARE ordering info.
- Also used in new construction sheetrock ceilings.



# 8DR LED 8" High Output Downlight – Round

## FIXTURE PERFORMANCE DATA

	DISTRIBUTION	DELIVERED LUMENS	WATTAGE	EFFICACY (lm/W)
L40	W	4345	72	60.3
	M	4301		59.7
	N	3764		52.2
L60	W	6518	108	60.4
	M	6451		59.7
	N	5645		52.2
L80	W	8690	144	60.3
	M	8602		59.7
	N	7527		52.2
L100	W	10863	180	60.4
	M	10752		59.7
	N	9409		52.2

## MULTIPLIER TABLES

	COLOR TEMPERATURE	
	CCT	CONVERSION FACTOR
80 CRI	2700K	—
	3000K	0.98
	3500K	1.00
90 CRI	2700K	0.75
	3000K	0.80
	3500K	—
	4000K	—

REFLECTOR FINISH		
CATALOG NUMBER	REFLECTOR FINISH	CONVERSION FACTOR
SPC	Specular	100.0
CS	Clear semi-specular	0.98
SG	Satin-glow	0.81
GD	Gold	0.95
CG	Champagne Gold	0.94
PW	Pewter	0.84
RG	Rose Gold	0.86
WH	White, textured	0.88
BL	Black, textured	0.77

- Photometrics tested in accordance with IESNA LM-79. Results shown are based on 25°C ambient temperature.
- Wattage shown based on 120V input.
- Results based on 3500K, 80 CRI, actual lumens may vary +/-5%
- Use multiplier table to calculate additional options.

## PHOTOMETRY

8DR-L100/835-OW-SPC Report #: ATAL011607; 12/11/15 | Total Luminaire Output: 10863 lumens; 180.1 Watts | Efficacy: 60.3lm/W | 83.2 CRI; 3501K CCT | Spacing Criteria: 1.0

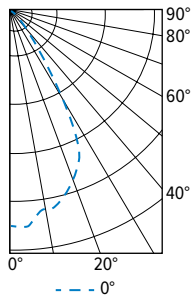

CANDLEPOWER DISTRIBUTION	VERTICAL ANGLE	HORIZONTAL ANGLE	ZONAL LUMENS
		0°	
	0	10777	
	5	10830	1007
	15	9752	2745
	25	8636	3862
	35	4278	2658
	45	585	553
	55	20	22
	65	9	9
	75	4	5
	85	1	1
	90	0	

LUMEN SUMMARY	ZONE	LUMENS	% FIXTURE
	0 - 30	7614	70
	0 - 40	10272	95
	0 - 60	10847	99
	0 - 90	10863	100
	0 - 180	10863	100

8DR-L100/835-OM-SPC Report #: ATAL011609; 12/11/15 | Total Luminaire Output: 10752 lumens; 180.0 Watts | Efficacy: 59.7 lm/W | 83.2 CRI; 3506K CCT | Spacing Criteria: .7

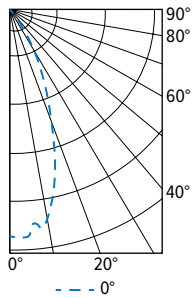

CANDLEPOWER DISTRIBUTION	VERTICAL ANGLE	HORIZONTAL ANGLE	ZONAL LUMENS
		0°	
	0	16775	
	5	16800	1563
	15	13867	3824
	25	7468	3445
	35	2437	1592
	45	333	309
	55	9	11
	65	5	5
	75	2	2
	85	1	1
	90	0	

LUMEN SUMMARY	ZONE	LUMENS	% FIXTURE
	0 - 30	8831	82
	0 - 40	10424	97
	0 - 60	10744	99
	0 - 90	10752	100
	0 - 180	10752	100

## PHOTOMETRY

8DR-L100/835-ON-SPC Report #: ATAL011610; 12/11/15 | Total Luminaire Output: 9409 lumens; 180.1 Watts | Efficacy: 52.2 lm/W | 83.2 CRI; 3506K CCT | Spacing Criteria: .6

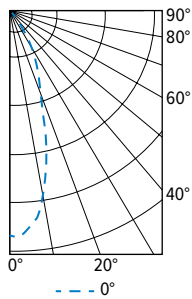

CANDLEPOWER DISTRIBUTION	VERTICAL ANGLE	HORIZONTAL ANGLE	ZONAL LUMENS
		0°	
	0	18330	
	5	17826	1641
	15	11928	3267
	25	5623	2621
	35	2455	1534
	45	371	333
	55	7	9
	65	3	3
	75	1	1
	85	0	0
	90	0	

LUMEN SUMMARY	ZONE	LUMENS	% FIXTURE
	0 - 30	7529	80
	0 - 40	9063	96
	0 - 60	9405	99
	0 - 90	9409	100
	0 - 180	9409	100



# 8DR LED 8" High Output Downlight – Round

## ADDITIONAL DRIVER OPTIONS

CATALOG NUMBER	DESCRIPTION
<b>DIM</b>	Dimming driver prewired for 0-10V low voltage applications
<b>DIM1</b>	1% dimming driver prewired for 0-10V low voltage applications
<b>DMX</b>	0.1% dimming driver for DMX controls
<b>LTE LINE</b>	Lutron Hi-lume 1% 2-wire dimming driver forward phase line voltage controls (120V only)
<b>LDE1</b>	Lutron Hi-lume 1% EcoSystem dimming LED driver
<b>LDE5</b>	Lutron 5-Series 5% EcoSystem dimming LED driver
<b>ELDO SOLOB</b>	EldoLED Solodrive, 0.1% dimming driver for 0-10V controls
<b>ELDO SOLOB DALI</b>	EldoLED Solodrive, 0.1% dimming driver for DALI controls
<b>ELDO ECO1</b>	EldoLED Ecodrive, 1% dimming driver for 0-10V controls
<b>ELDO ECO1 DALI</b>	EldoLED Ecodrive, 1% dimming driver for DALI controls
<b>SD</b>	Fixture prewired for step dimming applications

## SLOPED CEILING ADAPTOR DETAILS

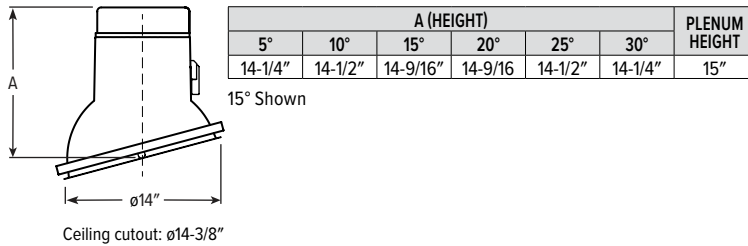

## REFLECTOR FINISH DETAILS

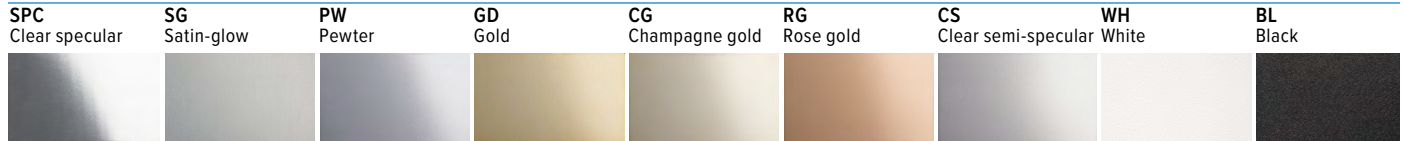

## MOUNTING TYPE DETAILS

### NEW CONSTRUCTION

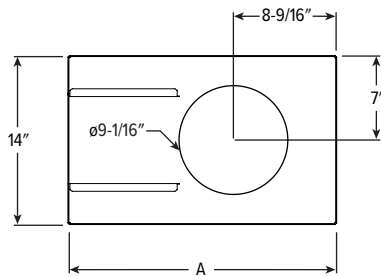

### DRIVER & JUNCTION BOX (REMODEL & NEW CONSTRUCTION)

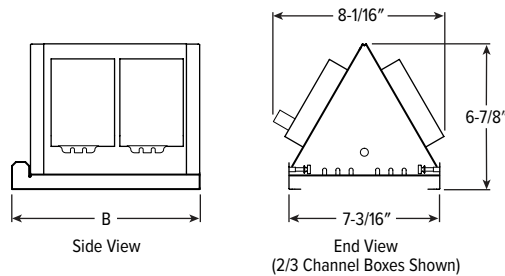

### REMODEL

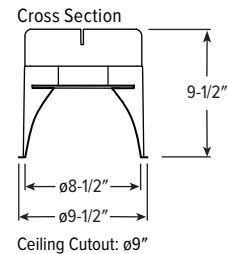
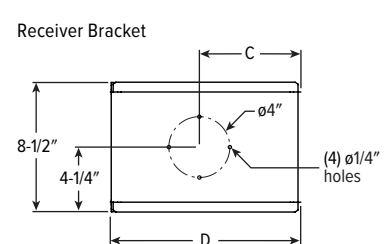

LUMENS	LENGTH			
	A	B	C	D
L40 & L60	22-5/16"	9-1/4"	5-1/16"	9-5/16"
L80 & L100	25-1/2"	12-7/16"	6-11/16"	12-1/2"



# 8DR LED 8" High Output Downlight – Round

## MOUNTING HARDWARE DETAILS

**BA1** Adjustable butterfly pan bracket, bar hanger not included (N Mounting Type only)

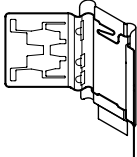

**BA2** Adjustable butterfly pan bracket, heavy-duty universal bar hanger included (N Mounting Type only)

