

CATALOG #: \_\_\_\_\_

TYPE: \_\_\_\_\_

PROJECT: \_\_\_\_\_

## FEATURES

- Backlit curved lens provides uniform illumination for visual comfort
- Distinct curved deep center detail creates a highly-aesthetic presence
- Available with decorative inserts to customize center lens
- Maximize energy savings with efficacies as high as 118 lm/w
- Optional gasketed acrylic lens helps protect against contaminants
- Made Right Here® in the USA

## SPECIFICATIONS

- HOUSING** – 20-gauge die-formed, welded C.R.S.
- DOOR FRAME** – Hinged, flat, extruded aluminum door frame with optical assembly.
- SHIELDING** – Diffuse polycarbonate lens and acrylic center standard.
- FINISH** – 95% reflective white polyester powder coat bonded to phosphate-free, multi-stage pretreated metal. All parts painted after fabrication to facilitate installation, increase efficiency, and inhibit corrosion.
- ELECTRICAL** – High quality mid-power LED boards. L70 >60,000 hours per IES TM-21.
- MOUNTING** – Surface or suspended
- LISTINGS** –
  - cETLus conforms to UL STD 1598 and UL STD 8750.
  - Certified to CAN/CSA STD C22.2 No. 250.0.
  - Suitable for damp locations.
- WARRANTY** – 5-year limited warranty, see [hew.com/warranty](http://hew.com/warranty).

**ORDERING EXAMPLE: ATS2 - 2 4 - L70/835 - D - OPTIONS - DIM - UNV**

## ORDERING INFO

SERIES	WIDTH	LENGTH	LUMENS <sup>[1]</sup>	CRI	CCT	SHIELDING
ATS2	1 1'	2 2' <sup>[2]</sup>	2x2	8 80	27 2700K	D Diffuse matte acrylic center
		2 2'	L30 3,000lm	9 90 <sup>[3]</sup>	30 3000K	P Perforated center <sup>[4]</sup>
	2 2'	L40 4,000lm	2x4	L40 4,000lm	35 3500K	DECORATIVE INSERTS <sup>[5]</sup>
		L50 5,000lm		L50 5,000lm	40 4000K	
		L40 4,000lm		L40 4,000lm	50 5000K	
		L55 5,500lm		L55 5,500lm		
		L70 7,000lm		L70 7,000lm		
L100 10,000lm	L100 10,000lm					

## OPTIONS <sup>[6]</sup>

<b>EM/7W</b>	7-watt emergency LED battery <sup>[8]</sup>
<b>EM/10W</b>	10-watt emergency LED battery <sup>[9]</sup>
<b>EM/12W</b>	12-watt emergency LED battery <sup>[10]</sup>
<b>(L__)</b>	Additional lower lumen packages available. <sup>[11]</sup> Example: 5,000 nominal lumens = ATS2-24-L55/835-D-(L50).
<b>SS</b>	Gasketed clear flat acrylic lens
<b>AMW</b>	Anti-microbial white finish

## CONTROL <sup>[7]</sup>

<b>DIM</b>	Dimming driver	<b>120</b>	120V
<b>DRV</b>	Non-dimming driver	<b>277</b>	277V
<b>VDO/DSR</b>	Lutron Vive integral fixture control, RF with daylight and occupancy sensor (DFCSJ-OEM-OCC) and sensor-ready driver	<b>UNV</b>	120-277V
<b>VRF/DSR</b>	Lutron Vive integral fixture control, RF only (DFCSJ-OEM-RF) and sensor-ready driver	<b>347</b>	347V <sup>[12]</sup>

## VOLTAGE

## NOTES

- Lumen output based on 3500 CCT. Actual lumens may vary +/-5%, see page 2 for FIXTURE PERFORMANCE DATA.
- Additional lumen package available, see options
- 2' width only
- Extended lead times may apply. Consult factory for availability.
- Decreases lumen output by 15%
- Only available with D shielding option. See page 3 for DIFFUSE CENTER DECORATIVE INSERT DETAILS.
- See page 3 for FINISH OPTIONS. Suspended mounting available. See page 3 for SUSPENDED MOUNTING DETAILS.
- See page 3 for ADDITIONAL CONTROL OPTIONS.
- 120V-277V only
- 120V-277V only
- 120V-277V only
- Specify in increments of 100 nominal lumens. Option must be specified with next higher lumen package.
- Not available with EM drivers



# ATS2 LED Architectural Surface – Curved Deep Center

## FIXTURE PERFORMANCE DATA

	LED PACKAGE	DELIVERED LUMENS	WATTAGE	EFFICACY (lm/W)
2x2	L30	3119	29.5	105.7
	L40	4243	37.2	114.2
	L50	5208	48.3	107.8
2x4	L40	4117	34.2	120.5
	L55	5633	48.0	117.3
	L70	7143	63.3	112.8
	L100	10328	86.9	118.7

### MULTIPLIER TABLE

COLOR TEMPERATURE	
CCT	CONVERSION FACTOR
2700K	0.97
3000K	0.99
3500K	1.00
4000K	1.03
5000K	1.06

  

2700K	0.80
3000K	0.82
3500K	0.83
4000K	0.86
5000K	0.89

- Photometrics tested in accordance with IESNA LM-79. Results shown are based on 25°C ambient temperature.
- Wattage shown is average for 120V through 277V input.
- Results based on 3500K, 80 CRI, actual lumens may vary +/-5%
- Use multiplier table to calculate additional options.

## PHOTOMETRY

**ATS2-22-L40/835-D-DIM-UNV** Total Luminaire Output: 4117 lumens; 34 Watts | Efficacy: 120 lm/W | 82 CRI; 3500K CCT

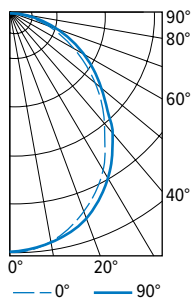

CANDLEPOWER DISTRIBUTION	VERTICAL ANGLE	HORIZONTAL ANGLE			ZONAL LUMENS
		0°	45°	90°	
	0	1729	1729	1729	
	5	1729	1729	1731	164
	15	1618	1636	1656	460
	25	1398	1439	1473	663
	35	1171	1225	1268	757
	45	888	945	984	723
	55	620	669	694	597
	65	397	440	461	431
	75	201	241	253	249
	85	52	65	60	72
	90	0	0	0	

LUMEN SUMMARY	ZONE	LUMENS	% FIXTURE
	0 - 30	1287	31
	0 - 40	2044	50
	0 - 60	3364	82
	0 - 90	4117	100
	0 - 180	4117	100

**ATS2-24-L70/835-D-DIM-UNV** Total Luminaire Output: 7143 lumens; 63 Watts | Efficacy: 113 lm/W | 82 CRI; 3500K CCT

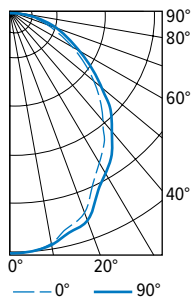

CANDLEPOWER DISTRIBUTION	VERTICAL ANGLE	HORIZONTAL ANGLE			ZONAL LUMENS
		0°	45°	90°	
	0	3000	3000	3000	
	5	3000	3000	3004	284
	15	2807	2839	2873	798
	25	2425	2496	2556	1151
	35	2032	2126	2200	1314
	45	1540	1639	1708	1254
	55	1076	1161	1205	1036
	65	690	763	800	749
	75	349	418	439	432
	85	90	113	103	126
	90	0	0	0	

LUMEN SUMMARY	ZONE	LUMENS	% FIXTURE
	0 - 30	2233	31
	0 - 40	3547	50
	0 - 60	5837	82
	0 - 90	7143	100
	0 - 180	7143	100

## FIXTURE DETAILS

### BACKVIEW

2x4

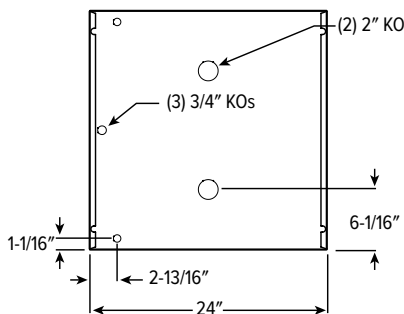

2x2

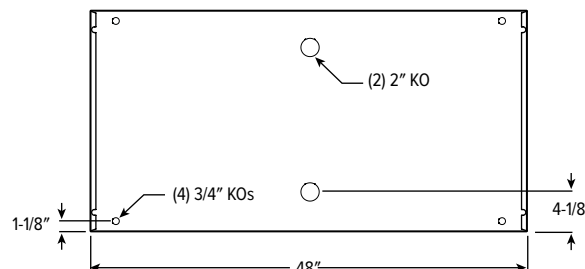

# ATS2 LED Architectural Surface – Curved Deep Center

## ADDITIONAL CONTROL OPTIONS

Note: Lumen restrictions apply, consult product builder at [hew.com/product-builder](http://hew.com/product-builder).

CATALOG NUMBER	DESCRIPTION
DRV	Driver prewired for non-dimming applications
DIM	Dimming driver prewired for 0-10V low voltage applications
DIM1	1% dimming driver prewired for 0-10V low voltage applications
DIM LINE	Line voltage dimming driver (Must specify 120V or 277V only)
DSR	Sensor-ready driver
SD40	40% step-dimming driver
SD50	50% step-dimming driver
DALI	DALI dimming driver
LTE LINE	Lutron Hi-lume 1% 2-wire dimming driver forward phase line voltage controls (120V only)
LDE1	Lutron Hi-lume 1% EcoSystem dimming LED driver
LDE5	Lutron 5-Series 5% EcoSystem dimming LED driver
VDO/DSR	Lutron Vive integral fixture control, RF with daylight and occupancy sensor (DFCSJ-OEM-OCC) and sensor-ready driver
VRF/DSR	Lutron Vive integral fixture control, RF only (DFCSJ-OEM-RF) and sensor-ready driver
VDO/DBI/LDE1	Lutron Vive integral fixture control, RF with daylight and occupancy sensor (DFCSJ-OEM-OCC), Lutron Hi-lume 1% EcoSystem dimming LED driver, and digital link interface
VDO/DBI/LDE5	Lutron Vive integral fixture control, RF with daylight and occupancy sensor (DFCSJ-OEM-OCC), Lutron 5-Series 5% EcoSystem dimming LED driver, and digital link interface
VRF/DBI/LDE1	Lutron Vive integral fixture control, RF only (DFCSJ-OEM-RF), Lutron Hi-lume 1% EcoSystem dimming LED driver, and digital link interface
VRF/DBI/LDE5	Lutron Vive integral fixture control, RF only (DFCSJ-OEM-RF), Lutron 5-Series 5% EcoSystem dimming LED driver, and digital link interface
ELDO SOLOB	EldoLED Solodrive, 0.1% dimming driver for 0-10V controls
ELDO SOLOB DALI	EldoLED Solodrive, 0.1% dimming driver for DALI controls
ELDO ECO1	EldoLED Ecodrive, 1% dimming driver for 0-10V controls
ELDO ECO1 DALI	EldoLED Ecodrive, 1% dimming driver for DALI controls

## DIFFUSE CENTER DECORATIVE INSERT DETAILS

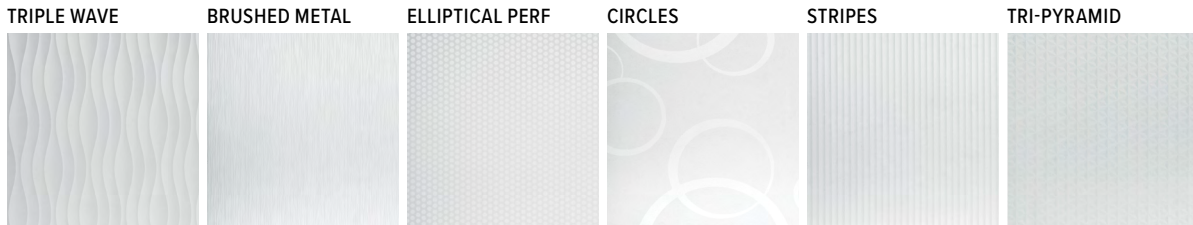

## FINISH OPTIONS

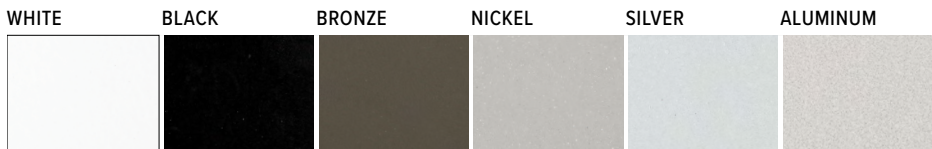

For custom color, please specify RAL code or a manufacturer code with description. All custom colors other than RAL require two sample swatches, minimum 1" square.

## SUSPENDED MOUNTING DETAILS

### ORDERING INFO (EXAMPLE: ACF\*4P/D48)

Prefix	Type	Length
ACF*4P	Adjustable	24 24"
	Aircraft Cable	48 48"
	D 1" grid & hardpan	96 96"
	N 9/16" grid	144 144"
	S Slot grid	192 192"
		240 240"
		300 300"

### STANDARD HARDWARE (Grid & Hardpan)

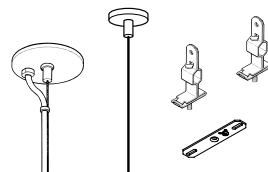

- Fixtures are provided with adjustable length aircraft cables and mounting hardware, must specify.
- One 5" canopy used at power feed location to cover the junction box. Three other suspension points use 2" canopy at the non-feed point. No J-box is required at non-feed points.

