

# M4PR dim to WARM

## 4.5" MRI Shallow Plenum Downlight – Round

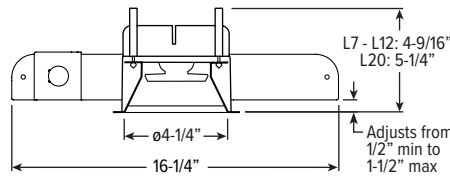

CATALOG #: \_\_\_\_\_

TYPE: \_\_\_\_\_

PROJECT: \_\_\_\_\_

### FEATURES

#### TrimLock®

- Innovative TrimLock reflector retention system ensures trim remains flush with ceiling plane
- Dim to warm from 1800K to 3000K CCT, minimum 95 CRI
- Designed with non-ferrous materials for MRI imaging suites
- IP65-rated die-cast trim includes easy-to-clean flush lens
- Beam angles ranging from 25° narrow to 65° wide for tailored performance
- 4 inch aperture is unobtrusive in small scale spaces
- Contemporary design provides glare-free illumination for a soft ceiling appearance

### SPECIFICATIONS

- HOUSING** – Spun housing with forged aluminum heat sink. Aluminum splice compartment. Trim housing adjusts for ceiling thickness from 1/2" - 1-1/2".
- TRIMLOCK** – Innovative TrimLock reflector retention system ensures the trim remains flush with the ceiling plane.
- LENSED TRIM** – Die-cast aluminum frame with micro-prismatic, tempered glass lens.
- ELECTRICAL** – High-performance Class 2 C.O.B. LED array. Modular quick-connect plug for easy field-connection of LED light assembly to driver. Reported L70>55,000 hours. Reported L90>55,000 hours. Estimated L70 = 200,000 hours. RF filter required, provided by others.
- MOUNTING** – Recessed. Aluminum mounting pan for new construction or IC-rated enclosure. Minimum 24" O.C. marked spacing required for L20 (R Mounting Type). Remote mounted driver enclosure required, ordered separately, must be located outside MRI room.
- LISTINGS** –
  - cCSAus conforms to UL STD 1598; Certified to CAN/CSA STD C22.2 No. 250.0 for damp locations. LED light assembly conforms to UL 2108 for remote installation.
  - Suitable for wet location under covered ceiling when specified with WET/CC option.
  - IC-rated for direct contact with insulation when specified with I Mounting Type.
  - City of Chicago Environmental Air approved when specified with CP option.
  - Complies with ASTM-E283 when specified with ATH option.
  - RoHS compliant.
- WARRANTY** – 5-year limited warranty, see [hew.com/warranty](http://hew.com/warranty).

ORDERING EXAMPLE: **M4PR - TL - L20/9DW - OPTIONS** - **LW - OF - WH - TRIM OPTIONS** - **N - F1M**  
 HOUSING TRIM MOUNT.

### HOUSING

SERIES	LUMENS <sup>(1)</sup>	COLOR	OPTIONS
<b>M4PR-TL</b>	<b>L7</b> 700lm	<b>9DW</b> Dim to warm (95 CRI, 1800K – 3000K)	<b>ATH</b> Airtight construction
TrimLock	<b>L12</b> 1,200lm <b>L20</b> 2,000lm		<b>CP</b> Chicago plenum (CEEA) <sup>(2)</sup>

### TRIM <sup>(3)</sup>

TRIM TYPE	DISTRIBUTION <sup>(4)</sup>	FLANGE TYPE	REFLECTOR FINISH	TRIM OPTIONS
L Flush lens	<b>W</b> 65° Wide	<b>OF</b> 1/2" standard flange	<b>CS</b> Clear semi-specular powder coat	<b>IP</b> IP65 rated trim
	<b>M</b> 35° Medium	<b>SF</b> 1/4" mud-in flange <sup>(5)</sup>	<b>WH</b> White texture powder coat	<b>AD</b> Diffuse acrylic lens <sup>(6)</sup>
	<b>N</b> 25° Narrow		<b>BL</b> Black texture powder coat	<b>PD</b> Diffuse 1/8" polycarbonate lens <sup>(7)</sup>
				<b>WET/CC</b> Wet location, covered ceiling listed
				<b>AM</b> Anti-microbial <sup>(8)</sup>

### MOUNTING

#### MOUNTING TYPE <sup>(9)</sup>

- N** Open pan for new construction
- I** IC-rated enclosure for new construction <sup>(11)</sup>

#### MOUNTING HARDWARE <sup>(10)</sup>

- F1M** Factory-installed 2-position fixed pan bracket, universal bar hanger included <sup>(12)</sup>
- BA1M** Adjustable butterfly pan bracket, aluminum, bar hanger not included <sup>(13)</sup>
- CA1M** Adjustable caterpillar pan bracket, aluminum, universal bar hanger included <sup>(14)</sup>

### REMOTE DRIVER ENCLOSURE (ORDERED SEPARATELY) <sup>(15)</sup>

ORDERING EXAMPLE: **M4PR - RDB1 - L20 - OPTIONS - DIM - UNV**

SERIES	DRIVER BOX	DRIVER QTY.	LUMENS	OPTIONS	CONTROL <sup>(16)</sup>	VOLTAGE
<b>M4PR</b>	<b>RDB</b> Remote driver enclosure	<b>1</b> <b>7</b>	<b>L7</b> 700lm	<b>EM/12W</b> 12-watt emergency battery <sup>(17)</sup>	<b>DIM</b> Dimming driver (0-10V signal to control dimming and CCT)	<b>UNV</b> 120-277V <b>347</b> 347V <sup>(19)</sup>
		<b>2</b> <b>8</b>	<b>L12</b> 1,200lm			
		<b>3</b> <b>9</b>	<b>L20</b> 2,000lm	<b>F</b> Fuse kit <b>SDT</b> Stepdown transformer <sup>(18)</sup>		
		<b>4</b> <b>10</b>				
		<b>5</b> <b>11</b>			<b>LUT</b> Lutron Ecosystem enabled	
		<b>6</b> <b>12</b>				

### NOTES

- Nominal lumen output based on full light output, N distribution and WH finish, 3000K/95CRI. Actual lumens may vary +/-5%. See page 2 for FIXTURE PERFORMANCE DATA.
- I Mounting Type required.
- Trim ships separately
- Beam angle based on WH reflector finish.
- For use with mud-in plaster construction only, supplied with mud flange installation kit. See page 3 for FLANGE TYPE DETAILS. Not available with ATH or IP options.
- Wide distribution only.
- Wide distribution only.
- WH and BL Reflector Finishes only.
- Mounting hardware required, ordered separately, see MOUNTING HARDWARE ordering info. See page 3 for MOUNTING TYPE DETAILS.

- See page 3 for MOUNTING HARDWARE DETAILS.
- L12 lumen package max.
- Universal bar hanger ships uninstalled
- N Mounting Type only.
- N Mounting Type only
- Required. Ordered as a separate catalog number, ships separately. See page 4 for REMOTE DRIVER ENCLOSURE DETAILS (ORDERED & SHIPPED SEPARATELY).
- All drivers dimmed by single control signal.
- Available with RDB1 only.
- May be required for 347V, see product builder at [hew.com](http://hew.com)
- Not available with EM batteries.



# M4PR dim to WARM

## 4.5" MRI Shallow Plenum Downlight – Round

### FIXTURE PERFORMANCE DATA

	DISTRIBUTION	DELIVERED LUMENS	CCT AT 100% (FULL OUTPUT)	CCT AT 1% (FULL DIM)	WATTAGE	EFFICACY (lm/W)
L7	W	668	3000K	1800K	14.0	47.7
	M	777			14.0	55.5
	N	772			14.0	55.1
L12	W	1171			23.4	50.1
	M	1363			23.4	58.3
	N	1353			23.4	57.9
L20	W	1918			37.7	50.9
	M	2232			37.7	59.2
	N	2216			37.7	58.8

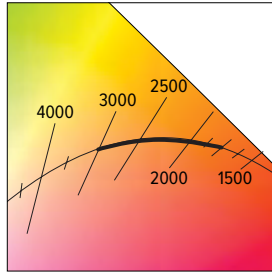

### MULTIPLIER TABLE

TRIM	
CATALOG NUMBER	CONVERSION FACTOR
AD	0.85
PD	0.85

- Photometrics tested in accordance with IESNA LM-79. Results shown are based on 25°C ambient temperature.
- Wattage shown is based on 120V input.
- Results based on 3000K, 95 CRI, full output, actual lumens may vary +/-5%
- Use multiplier table to calculate additional options.

### PHOTOMETRY

**M4PR-TL-L20/9DW-DIM-UNV-LW-OF-WH** Total Luminaire Output: 1918 lumens; 37.7 Watts | Efficacy: 50.9 lm/W | 95.0 CRI; 3000K CCT

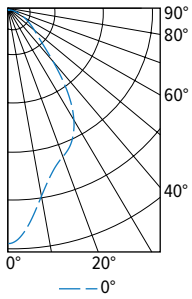

CANDLEPOWER DISTRIBUTION	VERTICAL ANGLE	HORIZONTAL ANGLE	ZONAL LUMENS
		0°	
	0	1535	
	5	1431	130
	15	1108	314
	25	970	443
	35	694	426
	45	319	255
	55	186	167
	65	109	109
	75	54	58
	85	14	17
	90	2	

LUMEN SUMMARY	ZONE	LUMENS	% FIXTURE
	0 - 40	1313	68
	0 - 60	1735	90
	0 - 90	1918	100
	0-180	1918	100

**M4PR-TL-L20/9DW-DIM-UNV-LM-OF-WH** Total Luminaire Output: 2232 lumens; 37.7 Watts | Efficacy: 59.2 lm/W | 95.0 CRI; 3000K CCT

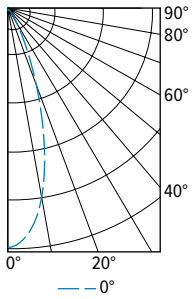

CANDLEPOWER DISTRIBUTION	VERTICAL ANGLE	HORIZONTAL ANGLE	ZONAL LUMENS
		0°	
	0	5244	
	5	4979	452
	15	3110	843
	25	1055	499
	35	316	207
	45	131	103
	55	68	61
	65	39	39
	75	20	21
	85	5	6
	90	1	

LUMEN SUMMARY	ZONE	LUMENS	% FIXTURE
	0 - 40	2001	90
	0 - 60	2166	97
	0 - 90	2232	100
	0-180	2232	100

**M4PR-TL-L20/9DW-DIM-UNV-LN-OF-WH** Total Luminaire Output: 2216 lumens; 37.7 Watts | Efficacy: 58.8 lm/W | 95.0 CRI; 3000K CCT

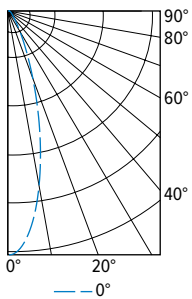

CANDLEPOWER DISTRIBUTION	VERTICAL ANGLE	HORIZONTAL ANGLE	ZONAL LUMENS
		0°	
	0	7437	
	5	6716	586
	15	3147	860
	25	841	404
	35	233	154
	45	110	86
	55	66	60
	65	40	39
	75	20	21
	85	5	6
	90	1	

LUMEN SUMMARY	ZONE	LUMENS	% FIXTURE
	0 - 40	2004	90
	0 - 60	2150	97
	0 - 90	2216	100
	0-180	2216	100



# M4PR dim to WARM

## 4.5" MRI Shallow Plenum Downlight – Round

### TRIMLOCK DETAILS



### FLANGE TYPE DETAILS

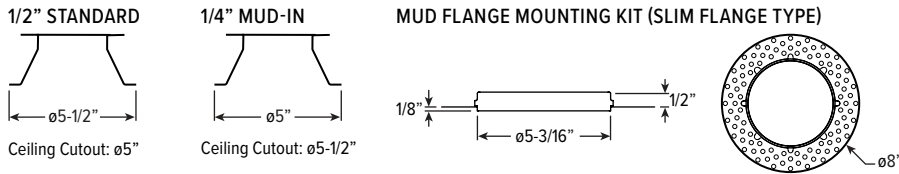

### REFLECTOR FINISH DETAILS

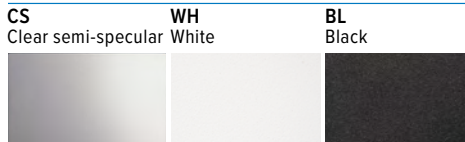

### MOUNTING TYPE DETAILS

#### NEW CONSTRUCTION

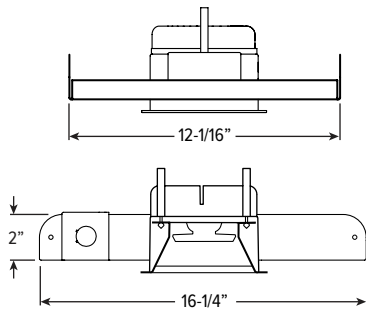

#### IC-RATED

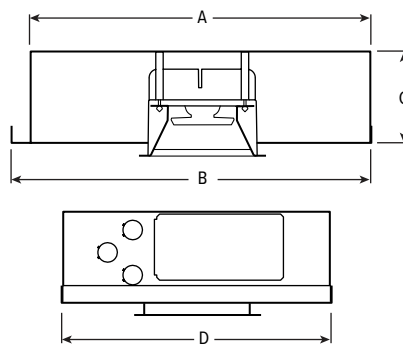

LUMENS	LENGTH			
	A	B	C	D
L7	15-3/16"	16"	4-1/8"	12-1/8"
L12	15-3/16"	16"	5-7/8"	12-1/8"

### MOUNTING HARDWARE DETAILS

**F1M** Factory-installed 2-position fixed pan bracket, universal bar hanger included

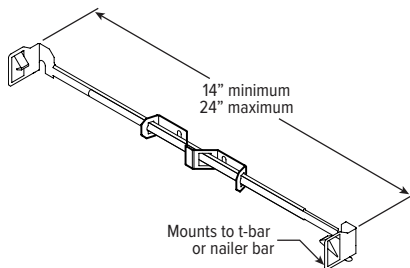

**BA1M** Adjustable butterfly pan bracket, aluminum, bar hanger not included (N Mounting Type only)

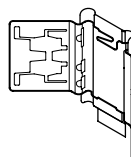

**CA1M** Adjustable caterpillar pan bracket, aluminum, universal bar hanger included (N Mounting Type only)

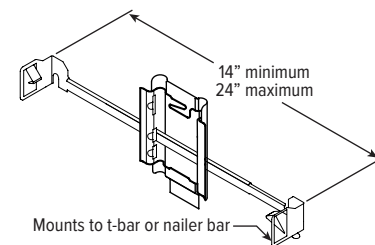

# M4PR dim to WARM

## 4.5" MRI Shallow Plenum Downlight – Round

### REMOTE DRIVER ENCLOSURE DETAILS (ORDERED & SHIPPED SEPARATELY)

#### REMOTE DRIVER ENCLOSURE FOR SINGLE FIXTURE

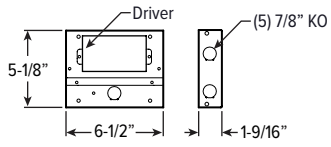

#### REMOTE DRIVER ENCLOSURE FOR SINGLE FIXTURE WITH EM/12W

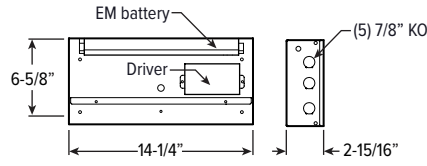

#### REMOTE DRIVER ENCLOSURE FOR 2 - 8 FIXTURES

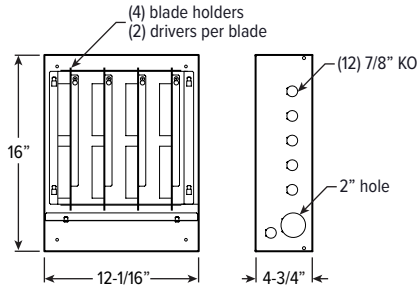

#### REMOTE DRIVER ENCLOSURE FOR 9 - 12 FIXTURES

