

MX2WUD LED 2" Continuous Up/Down – Wall

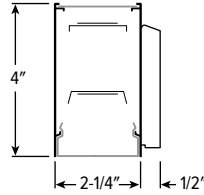
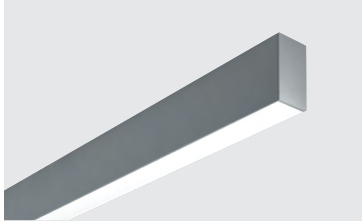

CATALOG #: _____

TYPE: _____

PROJECT: _____

FEATURES

- Create elegant spaces with a seamless, continuous row of illumination
- Specify in one inch increments to create a perfect fit
- Flat, glowing edge, drop and regressed lenses give designers a variety of looks
- Maximize energy savings with efficacies as high as 120 lm/W
- Linear extrusion contains snap-in light rails for ease of installation and maintenance
- Wall bracket design evenly spaces fixtures automatically
- Factory installed row alignment system creates straight rows with ease
- Versatile MX2 system includes recessed, surface, suspended and in-wall mounting, see hew.com
- Diffuse acrylic lens provides uniform illumination for visual comfort
- Made Right Here[®] in the USA

SPECIFICATIONS

- HOUSING – Extruded aluminum with die-cast end plates.
- SHIELDING – Extruded, flat, diffuse acrylic lens.
- FINISH – Textured matte white polyester TGIC powder coat bonded to phosphate-free, multi-stage pretreated metal. All parts painted after fabrication to facilitate installation, increase efficiency, and inhibit corrosion.
- ELECTRICAL – High quality mid-power LED boards. Reported L70: >54,000 hours. Reported L90: 52,000 hours. Estimated L70: 170,000 hours. 25°C maximum ambient operating temperature.
- MOUNTING – Wall mount. Powder coated, die-formed C.R.S. receiving bracket mounted to fixture which attaches to wall mounted bracket.
- LISTINGS –
 - cETLus conforms to UL STD 1598. Certified to CAN/CSA STD C22.2 No. 250.0. Suitable for damp locations.
 - DesignLights Consortium Premium qualified product. Not all versions of this product may be DLC Premium qualified, see the DLC Qualified Products List at www.designlights.org/QPL.
- WARRANTY – 5-year limited warranty, see hew.com/warranty.

ORDERING EXAMPLE: MX2WUD - 12'00 - L8/835U/L8/835D - F/F - OPTIONS - DIM - UNV

SERIES	LENGTH	LUMEN PACKAGE (EXAMPLE: L8/835U/L8/835D)			
MX2WUD	Lengths specified in feet and inches using 1" increments, 2" minimum. Example: 12'00 = 12'-0"	Specify lumen packages: U for Uplight and D for Downlight			
		LUMENS ^[1]	CRI	CCT	U or D
	L4 400lm	8 80	27 2700K	U Uplight	
	L8 800lm	9 90 ^[3]	30 3000K	D Downlight	
L12 1200lm ^[2]		35 3500K			
		40 4000K			
		50 5000K			

PRODUCT BUILDER
Simplify ordering & layout design with the Williams Linear Product Builder at hew.com/product-builder

SHIELDING UP	SHIELDING DOWN	OPTIONS ^[4]	
F Flat, diffuse acrylic	F Flat, diffuse acrylic	EM/7WLP	Low-profile 7-watt emergency battery ^[6]
G Diffuse acrylic with glowing edge	G Diffuse acrylic with glowing edge	EM/7WRM	Remote mount 7-watt emergency battery ^[7]
FW Flat, diffuse acrylic with widespread optic	D Diffuse acrylic with 1" drop	EM/10WLP	Low-profile 10-watt emergency battery ^[8]
FA Flat, diffuse acrylic with asymmetric optic	R Regressed diffuse acrylic, 1" ^[5]	EM/10WRM	Remote mount 10-watt emergency battery ^[9]
		OCC__	Factory-installed occupancy sensor ^[10] : OCCWS FS-355-L6
		(L__)	Additional lower lumen packages available ^[11] Example: 600 lumens = MX2WUD-12'00-L8/835-(L6)

CONTROL ^[12]	VOLTAGE
DIM Entire fixture switches and dims together	120 120V
	277 277V
	UNV 120-277V
	347 347V ^[13]

NOTES

- ¹ Lumens per foot output based on 80 CRI, 3500K CCT and F shielding. Actual lumens may vary ± 5%. See page 2 for FIXTURE PERFORMANCE DATA.
- ² Cannot be used for both U and D compartments in the same fixture. Only available with 1600 maximum combined lumens.
- ³ Extended lead times may apply. Consult factory for availability.
- ⁴ See page 3 for FINISH OPTIONS. Custom colors available upon request.
- ⁵ Increases fixture height. See page 3 for SHIELDING DETAILS.
- ⁶ Not available with fixtures less than 4'.
- ⁷ For fixtures less than 4' only.
- ⁸ Not available with fixtures less than 4'.
- ⁹ For fixtures less than 4' only.
- ¹⁰ Recommended for use in downlight orientation only. Reduces portion of lit fixture, consult factory. See page 3 for FIXTURE DETAILS.
- ¹¹ Specify in increments of 100 nominal lumens. Option must be specified with next higher lumen package.
- ¹² See page 2 for ADDITIONAL CONTROL OPTIONS.
- ¹³ Not available with EM drivers.



MX2WUD LED 2" Continuous Up/Down – Wall

FIXTURE PERFORMANCE DATA

	PER FOOT (1600 LUMENS PER FOOT MAXIMUM)				
	DELIVERED LUMENS			TOTAL WATTAGE	EFFICACY (lm/W)
	UP	DOWN	TOTAL		
L4/835U/L4/835D	416.9	375.8	792.7	6.8	116.6
L4/835U/L8/835D	416.9	751.5	1168.4	10.1	115.7
L8/835U/L4/835D	833.8	375.8	1209.6	10.1	119.8
L8/835U/L8/835D	833.8	751.5	1585.3	13.4	118.3
L4/835U/L12/835D	416.9	1127.3	1544.2	13.5	114.4
L12/835U/L4/835D	1250.8	375.8	1626.6	13.5	120.5

- Photometrics tested in accordance with IESNA LM-79. Results shown are based on 25°C ambient temperature.
- Wattage shown is average for 120V through 277V input.
- Results based on F shielding for Up and Down compartments, 3500K, 80 CRI, actual lumens may vary +/-5%.
- Use multiplier tables to calculate additional options.

MULTIPLIER TABLES

	COLOR TEMPERATURE	
	CCT	CONVERSION FACTOR
80 CRI	2700K	0.97
	3000K	0.99
	3500K	1.00
	4000K	1.03
	5000K	1.06
90 CRI	2700K	0.80
	3000K	0.82
	3500K	0.83
	4000K	0.86
	5000K	0.89

PHOTOMETRY

MX2WUD-4'00-L8/835U/L8/835D-A/F-DIM Total Luminaire Output: 6341 lumens; 53.6 Watts | Efficacy: 118 lm/W | 80 CRI; 3500K CCT

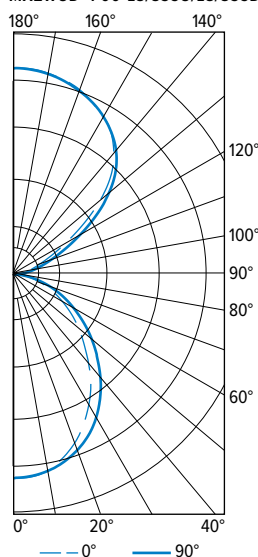

VERTICAL ANGLE	HORIZONTAL ANGLE			ZONAL LUMENS
	0°	45°	90°	
0	1354	1354	1354	
5	1343	1344	1348	128
15	1277	1268	1246	357
25	1147	1110	1063	511
35	954	899	845	563
45	734	672	615	522
55	523	476	431	428
65	336	303	274	303
75	168	155	143	166
85	40	44	45	50
90	2	5	4	
95	44	30	25	37
105	147	112	98	127
115	306	258	214	262
125	585	538	470	477
135	892	861	836	661
145	1097	1090	1087	681
155	1228	1230	1224	567
165	1314	1319	1321	373
175	1362	1358	1367	130
180	1367	1367	1367	

LUMEN SUMMARY	ZONE	LUMENS	% FIXTURE
	0 - 30	996	16
0 - 40	1559	25	
0 - 60	2509	40	
0 - 90	3027	48	
90 - 120	426	7	
90 - 130	903	14	
90 - 150	2246	35	
90 - 180	3150	50	
0 - 180	6341	100	

ADDITIONAL CONTROL OPTIONS

Note: Lumen restrictions apply, consult product builder at hew.com/product-builder.

CATALOG NUMBER	DESCRIPTION
DIM	Dimming driver prewired for 0-10V low voltage applications; entire fixture switches and dims together
DRVU/DIMD	Driver prewired for non-dimming applications; up and down portions switch separately; 0-10V on down portion only
DIMU/DRVU	Up and down portions switch separately; dimming driver prewired for 0-10V low voltage applications on up portion only ^[1]
DIMU/DIMD	Dimming driver prewired for 0-10V low voltage applications; up and down portions switch and dim separately
DRVU/DIMU	Entire fixture switches together; dimming driver prewired for 0-10V low voltage applications on up portion only
DRVU/DIMD	Entire fixture switches together; dimming driver prewired for 0-10V low voltage applications on down portion only
DIM1	1% dimming driver prewired for 0-10V low voltage applications
DIM LINE	Line voltage dimming driver (Must specify 120V or 277V only)
DIM LINEU/DIM LINED	Line voltage switching and line voltage dimming; up and down portions switch separately
DIM LINEU/DRVU	Up and down portions switch separately; line voltage dimming on up portion only ^[1]
DRVU/DIM LINED	Up and down portions switch separately; line voltage dimming on down portion only ^[1]

¹ Length restrictions may apply, consult factory.



MX2WUD LED 2" Continuous Up/Down – Wall

MOUNTING DETAILS

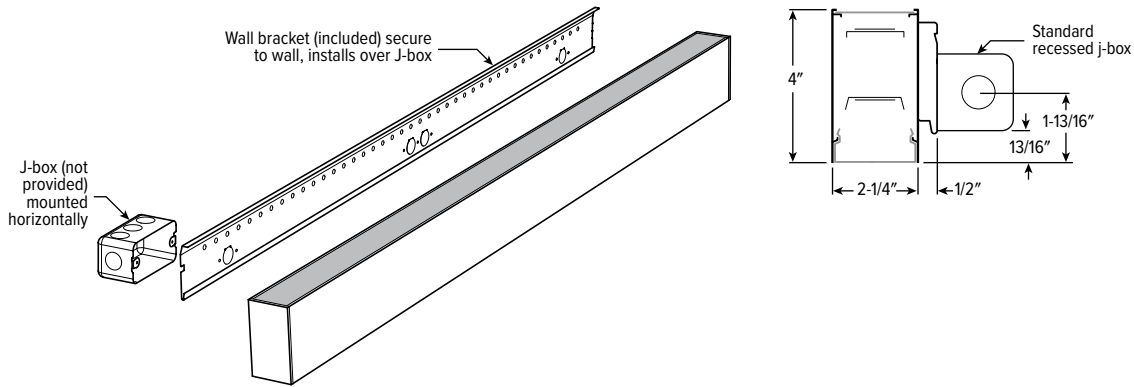

ROW ALIGNMENT SYSTEM

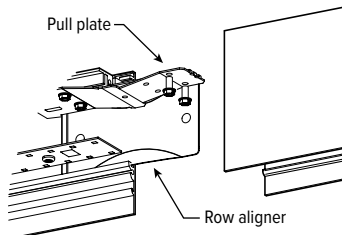

Installer friendly row aligners ensure seamless joining between fixtures while factory installed pull plate locks extrusions in place without disassembly of fixture internals.

FIXTURE DETAILS

BACK VIEW

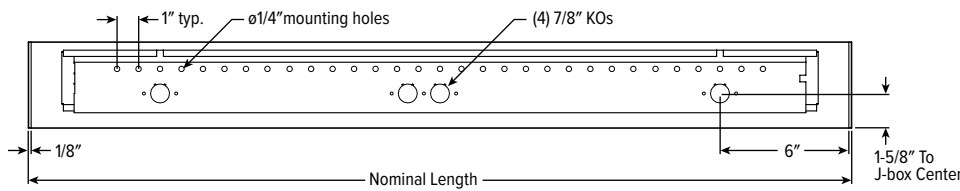

OCCUPANCY SENSOR

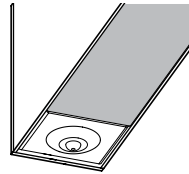

SHIELDING DETAILS

FLAT

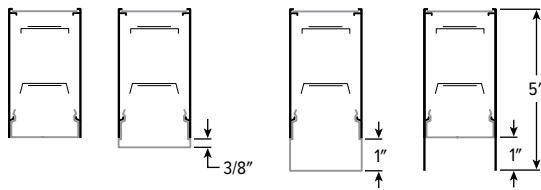

FLAT GLOWING EDGE DROP REGRESSED

GLOWING EDGE

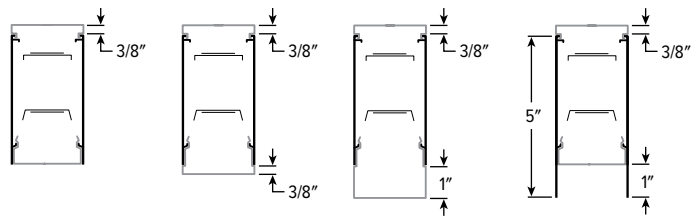

FLAT GLOWING EDGE DROP REGRESSED

FINISH OPTIONS

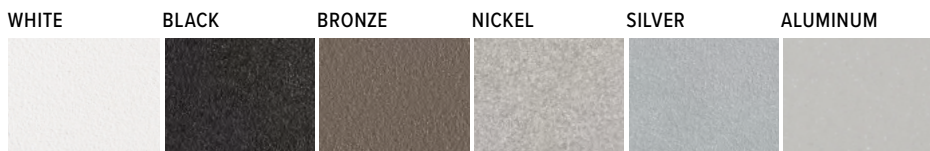

For custom color, please specify RAL code or a manufacturer code with description. All custom colors other than RAL require two sample swatches, minimum 1" square.