

CATALOG #: _____

TYPE: _____

PROJECT: _____



FEATURES

- Easily change the color temperature on-site with FieldSELECT technology
- Three switchable CCT settings provide ultimate flexibility – 3000K, 3500K and 4000K
- Slim fixture depth for low-profile surface mount
- Uniform ambient illumination
- Companion recessed and retrofit kit preserve continuity
- Optional anti-microbial finish for healthcare applications
- Round or square diffuse ribbed acrylic lens options enhance the space
- High-performance up to 123 lm/W
- Heavy duty C.R.S. construction
- Made Right Here[®] in the USA

SPECIFICATIONS

- **HOUSING** – Precision die-formed 20-gauge C.R.S.
- **REFLECTOR** – Precision die-formed 22-gauge C.R.S. Highly reflective non-glare matte white polyester powder coat.
- **SHIELDING** – Diffuse ribbed acrylic.
- **FINISH** – Textured matte white polyester TGIC powder coat bonded to phosphate-free, multi-stage pretreated metal. All parts painted after fabrication to facilitate installation, increase efficiency, and inhibit corrosion.
- **ELECTRICAL** – High-quality mid-power LED boards with switchable CCT – 3000K, 3500K, and 4000K. L70 >50,000 hours. FieldSELECT products use LEDs of multiple CCTs and may produce a perceptibly different shade of white from single-CCT products at the same CCT. All CCTs are within 3 MacAdam ellipses.
- **MOUNTING** – Surface or suspended.
- **LISTINGS** –
 - cCSAus certified as luminaire suitable for dry locations.
 - Complies with the Buy American Act and other federal regulations. Request certification at hew.com/baa.
- **WARRANTY** – 5-year limited warranty, see hew.com/warranty.

ORDERING EXAMPLE: PTS - 2 4 - L62/8FS - RA - CONTROL/DIM - UNV

ORDERING INFO

SERIES	WIDTH	LENGTH	LUMENS ^[1]	CRI	CCT	SHIELDING
PTS	1 1' ^[2]	2 2' ^[3]	1x4	8 80	FS FieldSELECT 3000K, 3500K, 4000K ^[4]	RA Diffuse ribbed acrylic, round
			L25 2,500lm			
	2 2'	4 4'	L37 3,700lm			SA Diffuse ribbed acrylic, square ^[5]
			L50 5,000lm			
			2x2			
			L24 2,400lm			
			L36 3,600lm			
			2x4			
			L37 3,700lm			
			L55 5,500lm			
			L62 6,200lm			

OPTIONS ^[6]

EM/10W	10-watt emergency battery ^[8]
EM/10WLP	Low-profile 10-watt emergency battery ^[9]
EM/12W	12-watt emergency battery ^[10]
AMW	Anti-microbial white finish

CONTROL ^[7]

<i>See page 4 for ADDITIONAL CONTROL OPTIONS.</i>	
–	None
VDO	Lutron Vive integral fixture control, RF with daylight and occupancy sensor (DFCSJ-OEM-OC) ^[11]
VRF	Lutron Vive integral fixture control, RF only (DFCSJ-OEM-RF) ^[12]

DRIVER

<i>See page 4 for ADDITIONAL DRIVER OPTIONS.</i>	
DIM	Dimming driver
DRV	Non-dimming driver
DSR	Sensor-ready driver ^[13]

VOLTAGE

120	120V
277	277V
UNV	120-277V
347	347V ^[14]

NOTES

- ¹ Lumen output based on 3500 CCT. Actual performance may vary +/-5%, see page 2 for FIXTURE PERFORMANCE DATA.
- ² 4' length only.
- ³ 2' width only.
- ⁴ See page 3 for FIELDSELECT DETAILS.
- ⁵ Increases lumen output by 3%.
- ⁶ See page 3 for FINISH OPTIONS. Custom colors available upon request. Suspended mounting available. See page 3 for SUSPENDED MOUNTING DETAILS.
- ⁷ See page 4 for SENSOR PLACEMENT DETAILS.

- ⁸ 2x2 & 2x4 only.
- ⁹ 1x4 only.
- ¹⁰ 2x2 & 2x4 only. Not available when CEC regulations are required.
- ¹¹ DSR or LDE Drivers only. LDE drivers require driver interface.
- ¹² DSR or LDE Drivers only. LDE drivers require driver interface.
- ¹³ VDO and VRF Controls only.
- ¹⁴ Not available with EM batteries or DSR Driver.



FIXTURE PERFORMANCE DATA

	LED PACKAGE	DELIVERED LUMENS	WATTAGE	EFFICACY (lm/W)
1x4	L25	2441	19.8	123
	L37	3674	30.8	119
2x2	L50	4969	42.6	117
	L24	2378	20.8	114
	L36	3595	30.9	116
2x4	L37	3674	30.8	119
	L55	5460	47.3	115
	L62	6208	54.8	113

MULTIPLIER TABLE

COLOR TEMPERATURE	
CCT	CONVERSION FACTOR
3000K	0.94
3500K	1.00
4000K	0.95

- Photometrics LM-79. Results based on RA shielding, 80 CRI/3500K CCT, average wattage for 120V through 277V input, and 25°C ambient temperature. Actual performance may vary +/-5%.
- To calculate lumen output in emergency mode, multiply the battery wattage by the efficacy.
- Use multiplier table to calculate additional options.

PHOTOMETRY

PTS-24-L62/8FS-RA-DIM-UNV Total Luminaire Output: 6208 lumens; 55 Watts | Efficacy: 113 lm/W | 80 CRI; 3500K CCT

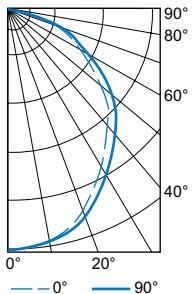

CANDLEPOWER DISTRIBUTION	VERTICAL ANGLE	HORIZONTAL ANGLE			ZONAL LUMENS
		0°	45°	90°	
	0	2375	2375	2375	
	5	2339	2336	2323	223
	15	2270	2278	2287	638
	25	2000	2027	2052	923
	35	1617	1668	1711	1041
	45	1314	1387	1458	1062
	55	956	1046	1130	938
	65	619	733	833	724
75	293	451	558	474	
85	60	199	228	186	
90	0	0	0		

LUMEN SUMMARY	ZONE	LUMENS	% FIXTURE
	0 - 30	1784	29
	0 - 40	2825	46
	0 - 60	4825	78
	0 - 90	6208	100
	0 - 180	6208	100

PTS-14-L50/8FS-RA-DIM-UNV Total Luminaire Output: 4969 lumens; 43 Watts | Efficacy: 117 lm/W | 80 CRI; 3500K CCT

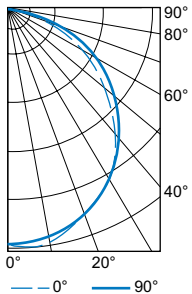

CANDLEPOWER DISTRIBUTION	VERTICAL ANGLE	HORIZONTAL ANGLE			ZONAL LUMENS
		0°	45°	90°	
	0	1811	1811	1811	
	5	1852	1831	1804	173
	15	1770	1765	1744	495
	25	1619	1627	1607	744
	35	1409	1427	1428	885
	45	1124	1173	1191	895
	55	804	884	921	785
	65	516	611	627	585
75	229	321	335	326	
85	35	58	68	80	
90	0	0	0		

LUMEN SUMMARY	ZONE	LUMENS	% FIXTURE
	0 - 30	1413	28
	0 - 40	2298	46
	0 - 60	3978	80
	0 - 90	4969	100
	0 - 180	4969	100

CROSS SECTIONS

FIXTURE DETAILS

BACKVIEW

1x4

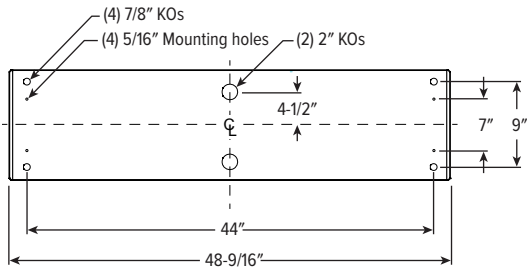

2x4

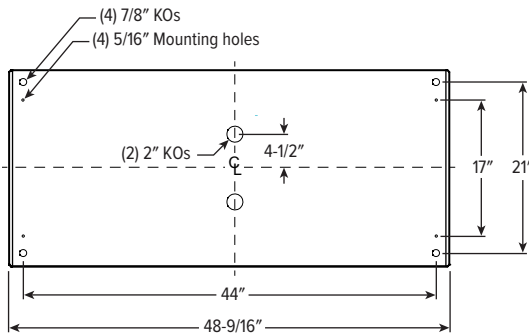

2x2

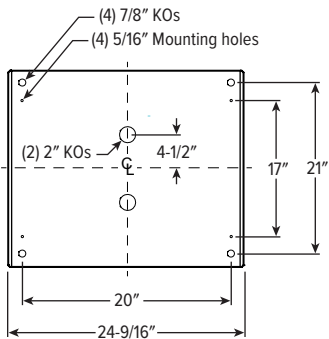

FIELDSELECT DETAILS

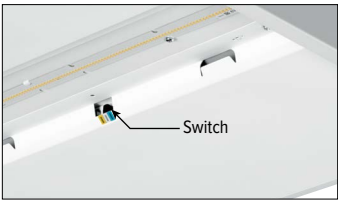

SUSPENDED MOUNTING DETAILS

AIRCRAFT CABLE

ORDERING EXAMPLE: ACF*4P/D48			
PREFIX	TYPE	LENGTH	
ACF*4P	Four point mount adjustable aircraft cable	D 1" grid & hardpan	24 24"
		N 9/16" grid	48 48"
		S Slot grid	96 96"
			144 144"
			192 192"
			240 240"
			300 300"

CORD OPTIONS

Units specified with aircraft cable require cord. Please specify cord type using ordering information below. Long fixture rows may require multiple feed points based on 18ga conductor size.

EXAMPLE: S2438D/W				
CORD TYPE	LENGTH	# OF COND. ^[1]	WIRE SIZE	COLOR
S	24 24"	3	8D 18ga	/W White /B Black
	48 48"	4		
	96 96"	5		
		6		

¹ Includes (2) 22ga purple & pink dimming conductors

STANDARD HARDWARE (Grid & Hardpan)

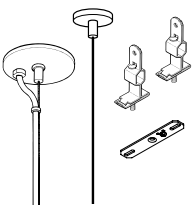

- Fixtures are provided with adjustable length aircraft cables and mounting hardware, must specify.
- One 5" canopy used at power feed location to cover the junction box. Three other suspension points use 2" canopy at the non-feed point. No J-box is required at non-feed points.

FINISH OPTIONS

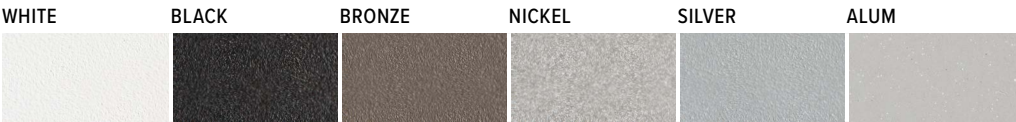

For custom color, please specify RAL code or a manufacturer code with description. All custom colors other than RAL require two sample swatches, minimum 1" square.



SENSOR PLACEMENT DETAILS

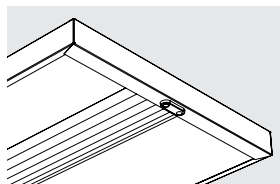

ADDITIONAL CONTROL OPTIONS

VDO Lutron Vive integral fixture control, RF with daylight and occupancy sensor (DFCSJ-OEM-OCC). DSR or LDE Drivers only. LDE drivers require driver interface

SPECIFICATIONS	
TYPE	PIR Motion + Daylight
MOUNTING HEIGHT	8' – 12'
DETECTION ANGLE	360°
TEMPERATURE RANGE	0° to 55°C
RELATIVE HUMIDITY	0 to 90%, non-condensing
COMMISSIONING	App (iOS or Android)
MANUFACTURER	Lutron

SENSOR COVERAGE PATTERNS

9' height: ø12' coverage

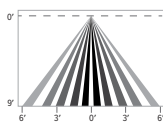

Motion Sensor Coverage

CEILING HEIGHT	COVERAGE AREA (SQ FT)
8'	114
9'	144
10'	178
12'	256

SENSOR DETAIL



Dimensions: 2-11/16" x 1"

VIVE CONTROL OPTIONS

CATALOG NUMBER	DESCRIPTION
VRF	Lutron Vive integral fixture control, RF only (DFCSJ-OEM-RF), for use with sensor-ready driver
VDO	Lutron Vive integral fixture control, RF with daylight and occupancy sensor (DFCSJ-OEM-OC), for use with sensor-ready driver
VRF/DBI	Lutron Vive integral fixture control, RF only (DFCSJ-OEM-RF) and digital link interface, for use with Lutron Hi-lume 1% EcoSystem dimming LED driver
VDO/DBI	Lutron Vive integral fixture control, RF with daylight and occupancy sensor (DFCSJ-OEM-OC) and digital link interface, for use with Lutron Hi-lume 1% EcoSystem dimming LED driver

ADDITIONAL DRIVER OPTIONS

Note: Lumen restrictions apply, consult product builder at hew.com/product-builder.

CATALOG NUMBER	DESCRIPTION
DRV	Driver prewired for non-dimming applications
DIM	Dimming driver prewired for 0-10V low voltage applications
DIM1	1% dimming driver prewired for 0-10V low voltage applications
DIM LINE	Line voltage dimming driver (TRIAC and ELV compatible, 120V only)
DIM TRC	Line voltage dimming driver (TRIAC compatible, 120V only)
DSR	Sensor-ready driver (D4i DALI-2)
SD40	40% step-dimming driver
SD50	50% step-dimming driver
DALI	DALI dimming driver
LDE1	Lutron Hi-lume 1% EcoSystem dimming LED driver