

PXG-42 shown

CATALOG #: _____

TYPE: _____

PROJECT: _____

FEATURES

- Wide asymmetric distribution produces ample general illumination in high-ceiling environments
- Sleek, linear design incorporates clean lines, slim styling, and a continuous row of light
- Allows for 90° run connections in both inside and outside corner installs
- Quick and easy installation with wall mounted bracket providing multiple pre-drilled screw locations and a quick hang feature for the fixture
- Solutions for both grid and drywall ceilings
- Adjustable extensions allow for a perfect fit to meet adjacent walls and create corners
- Made Right Here® in the USA

SPECIFICATIONS

- HOUSING** – Formed sheet metal and aluminum.
- FINISH** – Textured matte white polyester TGIC powder coat bonded to phosphate-free, multistage pretreated metal. All parts painted after fabrication to facilitate installation, increase efficiency, and inhibit corrosion.
- ELECTRICAL** – High quality mid-power LED boards. L70 >60,000 hours per IES TM-21. 25°C maximum ambient operating temperature.
- MOUNTING** – Wall mount rail, predrilled with wall screw locations, with quick hang feature.
- LABELS** – cETLus conforms to UL STD 1598. Certified to CAN/CSA STD C22.2 No. 250.0. Suitable for damp locations.
- WARRANTY** – 5-year limited warranty, see hew.com/warranty.

ORDERING EXAMPLE: PX G - 42 - 14'08 - L10/835 - S - L90IN/RWALL - OPTIONS - DIM - UNV

ORDERING INFO

SERIES	CEILING TYPE	WIDTH	HEIGHT	LENGTH
PX	G Grid	4 4"	2 2"	Lengths specified in feet and inches using 1" increments, 2" minimum. Example: 14'08 = 14'-8"
	F Drywall	6 6"		

PRODUCT BUILDER

Simplify ordering & layout design with the Williams Linear Product Builder at hew.com/product-builder

LUMEN PACKAGE ^[1]	CRI	CCT	DISTRIBUTION	LEFT END TYPE	RIGHT END TYPE
L4 400lm	8 80	27 2700K	S Slot	LWALL Wall	RWALL Wall
L7 700lm		30 3000K		LCAP Cap	RCAP Cap
L10 1000lm		35 3500K		L90IN 90° inward	R90IN 90° inward
L13 1300lm		40 4000K		L90OUT 90° outward	R90OUT 90° outward

OPTIONS	DRIVER ^[2]	VOLTAGE
EM/10WLP Low-profile 10-watt emergency battery ^[3]	DRV Non-dimming driver	120 120V
EM/10WRM Remote mount 10-watt emergency battery ^[4]	DIM Dimming driver	277 277V
		UNV 120-277V
		347 347V ^[5]

NOTES

- ¹ Nominal lumens per foot output based on 3500 CCT. Actual lumens per foot may vary +/-5%. See page 2 for FIXTURE PERFORMANCE DATA.
- ² See page 2 for ADDITIONAL DRIVER OPTIONS.
- ³ Minimum 4' fixture; 120V-277V only.
- ⁴ Required for fixtures below 4'; 120V-277V only.
- ⁵ Not available with EM drivers.



FIXTURE PERFORMANCE DATA

	WIDTH & HEIGHT	DELIVERED LUMENS PER FOOT	WATTAGE PER FOOT	EFFICACY (lm/W)
L4	42	390	4	98
	62	395		99
L7	42	682	7	97
	62	691		99
L10	42	974	10	97
	62	987		97
L13	42	1364	14	97
	62	1382		97

MULTIPLIER TABLE

COLOR TEMPERATURE	
CCT	CONVERSION FACTOR
2700K	0.97
3000K	0.99
3500K	1.00
4000K	1.03

- Photometrics tested in accordance with IESNA LM-79. Results shown are based on 25°C ambient temperature.
- Wattage shown is average for 120V through 277V input.
- Results based on 3500K, 80 CRI, actual lumens may vary +/-5%
- Use multiplier table to calculate additional options.

PHOTOMETRY

PXF-42-03*08-L10/835-S-LCAP/RCAP-DIM-UNV Report #: 20584; 09/12/17 | Total Luminaire Output: 3570 lumens; 37.1 Watts | Efficacy: 96.3 lm/W | 83 CRI; 3574K CCT

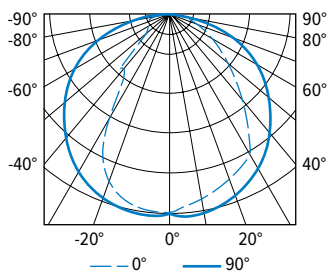

VERTICAL ANGLE	HORIZONTAL ANGLE					ZONAL LUMENS
	0°	45°	90°	135°	180°	
0	1617	1617	1617	1617	1617	
5	1574	1604	1654	1634	1607	153
15	1494	1536	1616	1577	1530	438
25	1389	1423	1522	1436	1251	653
35	1145	1274	1378	1086	591	717
45	782	1001	1187	511	254	641
55	511	635	963	212	194	513
65	293	360	687	149	175	302
75	109	143	376	106	105	136
85	0	8	35	24	23	18
90	0	0	0	1	0	

LUMEN SUMMARY	ZONE	LUMENS	% FIXTURE
	0 - 30	1244	35
	0 - 40	1961	55
	0 - 60	3114	87
	0 - 90	3570	100
	0 - 180	3570	100

PXF-62-03*08-L10/835-S-LCAP/RCAP-DIM-UNV Report #: 20590; 09/11/18 | Total Luminaire Output: 3622 lumens; 37.2 Watts | Efficacy: 97.4 lm/W | 83 CRI; 3591K CCT

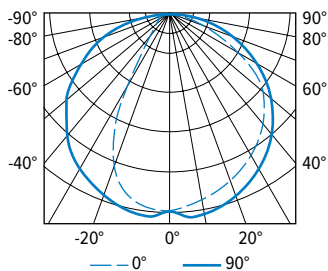

VERTICAL ANGLE	HORIZONTAL ANGLE					ZONAL LUMENS
	0°	45°	90°	135°	180°	
0	1627	1627	1627	1627	1627	
5	1586	1607	1676	1641	1610	154
15	1509	1536	1632	1568	1491	438
25	1405	1423	1536	1383	1068	640
35	1279	1271	1396	967	328	691
45	1096	1099	1200	318	157	659
55	864	872	969	134	115	548
65	453	565	681	89	106	313
75	156	209	352	72	78	163
85	0	4	25	21	19	16
90	0	0	0	0	0	

LUMEN SUMMARY	ZONE	LUMENS	% FIXTURE
	0 - 30	1231	34
	0 - 40	1923	53
	0 - 60	3129	86
	0 - 90	3622	100
	0 - 180	3622	100

ADDITIONAL DRIVER OPTIONS

Note: Lumen restrictions apply, consult product builder at hew.com/product-builder.

CATALOG NUMBER	DESCRIPTION
DRV	Driver prewired for non-dimming applications
DIM	Dimming driver prewired for 0-10V low voltage applications
DIM1	1% dimming driver prewired for 0-10V low voltage applications
DIM LINE	Line voltage dimming driver (Must specify 120V or 277V only)
SD40	40% step-dimming driver
SD50	50% step-dimming driver
DALI	DALI dimming driver
LTE LINE	Lutron Hi-lume 1% 2-wire dimming driver forward phase line voltage controls (120V only)
LDE1	Lutron Hi-lume 1% EcoSystem dimming LED driver
LDE5	Lutron 5-Series 5% EcoSystem dimming LED driver
ELDO SOLOB	EldoLED Solodrive, 0.1% dimming driver for 0-10V controls
ELDO SOLOB DALI	EldoLED Solodrive, 0.1% dimming driver for DALI controls
ELDO ECO1	EldoLED Ecodrive, 1% dimming driver for 0-10V controls
ELDO ECO1 DALI	EldoLED Ecodrive, 1% dimming driver for DALI controls



CROSS SECTIONS

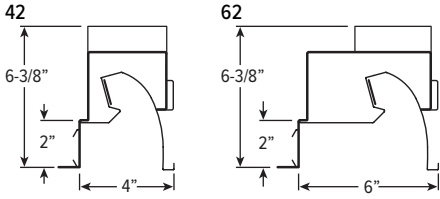

CEILING TYPE DETAILS

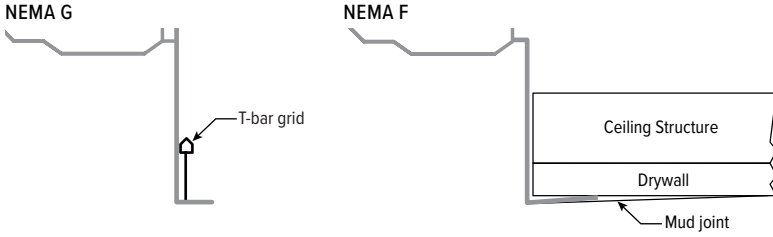

END TYPE DETAILS

