

PXG-42 shown

CATALOG #: _____

TYPE: _____

PROJECT: _____

FEATURES

- Williams turn-key Power over Ethernet (PoE) solution provides plug-and-play networked lighting and control
- Tunable white from 3000K to 5000K CCT, minimum 80 CRI
- Wide asymmetric distribution produces ample general illumination in high-ceiling environments
- Sleek, linear design incorporates clean lines, slim styling, and a continuous row of light
- Allows for 90° run connections in both inside and outside corner installs
- Quick and easy installation with wall mounted bracket providing multiple pre-drilled screw locations and a quick hang feature for the fixture
- Solutions for both grid and drywall ceilings
- Adjustable extensions allow for a perfect fit to meet adjacent walls and create corners
- Diffuse acrylic lens shields LEDs from view
- Made Right Here® in the USA

SYSTEM REQUIREMENTS

- Lighting system (site software)
- Gateway or alternate server (runs software)
- PoE switches or Ethernet switches and mid-span power injectors
- See hew.com/poe for details

SPECIFICATIONS

- HOUSING** – Formed sheet metal and aluminum.
- FINISH** – Textured matte white polyester TGIC powder coat bonded to phosphate-free, multistage pretreated metal. All parts painted after fabrication to facilitate installation, increase efficiency, and inhibit corrosion.
- ELECTRICAL** – High quality mid-power LED board. L70 > 50,000 hours per IES TM-21. Low-voltage DC fixture, to be fed by Class 2 power supply. Tunable White products use LEDs of multiple CCTs and may produce a perceptibly different shade of white from single-CCT products at the same CCT. All CCTs are within 3 MacAdam ellipses.
- MOUNTING** – Wall mount rail, predrilled with wall screw locations, with quick hang feature.
- LABELS** – cETLus conforms to UL STD 1598. Certified to CAN/CSA STD C22.2 No. 250.0. Suitable for damp locations.
- WARRANTY** – 5-year limited warranty, see hew.com/warranty.

ORDERING EXAMPLE: PX G - 42 - 14'08 - P11/835 - S - L90IN/R45OUT - OPTIONS - POE N

ORDERING INFO

SERIES	CEILING TYPE	WIDTH	HEIGHT	LENGTH
PX	G Grid	4 4"	2 2"	Lengths specified in feet and inches using 1" increments, 2" minimum. Example: 14'08 = 14'-8"
	F Drywall	6 6"		

PRODUCT BUILDER

Simplify ordering & layout design with the Williams Linear Product Builder at hew.com/product-builder

LUMEN PACKAGE ^[1]	CRI	CCT	DISTRIBUTION	LEFT END TYPE	RIGHT END TYPE
P6 600lm	8 80	27 2700K	S Slot	LWALL Wall	RWALL Wall
P11 1100lm		30 3000K		LCAP Cap	RCAP Cap
		35 3500K		L90IN 90° inward	R90IN 90° inward
		40 4000K		L90OUT 90° outward	R90OUT 90° outward
		TW Tunable white (80 CRI, 3000K–5000K)			

OPTIONS ^[2]

- EM/10WLP** Low-profile 10-watt emergency battery ^[4]
- EM/10WRM** Remote mount 10-watt emergency battery ^[5]

CONTROL ^[3]

- POE N** Power over Ethernet network node
- POE D** Power over Ethernet device node ^[6]

NOTES

- ¹ Lumens per foot based on 3500K for single CCT and 4000K for TW. Actual lumens per foot may vary +/-5%. See page 2 for **FIXTURE PERFORMANCE DATA**.
- ² See hew.com/poe for compatible sensors and switches.
- ³ For additional PoE info, see hew.com/poe.
- ⁴ Minimum 4' fixture; 120V-277V only.
- ⁵ Required for fixtures below 4'; 120V-277V only.
- ⁶ Not available for fixtures over 40W.



FIXTURE PERFORMANCE DATA

STANDARD

	WIDTH & HEIGHT	DELIVERED LUMENS	WATTAGE PER FOOT	EFFICACY (lm/W)
P6	42	568	5.2	109.2
	62	587		112.9
P11	42	1059	10.4	101.8
	62	1094		105.2

TUNABLE WHITE

	WIDTH & HEIGHT	DELIVERED LUMENS	WATTAGE PER FOOT	EFFICACY (lm/W)
P6	42	531	5.2	102.1
	62	549		105.6
P11	42	968	10.4	93.1
	62	999		96.1

MULTIPLIER TABLE

COLOR TEMPERATURE		
CCT	LUMENS	
	STANDARD	TUNABLE WHITE
2700K	0.97	–
3000K	0.99	0.95
3500K	1.00	0.98
4000K	1.03	1.00
5000K	–	0.96

- Photometrics tested in accordance with IESNA LM-79. Results shown are based on 25°C ambient temperature.
- Standard results based on 3500K standard, 80 CRI, actual lumens may vary ±5%.
- Tunable white results based on 4000K standard, 80 CRI, actual lumens may vary ±5%.
- Use multiplier table to calculate additional options.

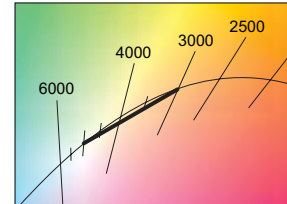

PHOTOMETRY

PXF-42-03'08-P11/835-S-LCAP/RCAP-DIM-UNV Total Luminaire Output: 3886 lumens; 38.2 Watts | Efficacy: 101.7 lm/W | 80 CRI; 3500K CCT

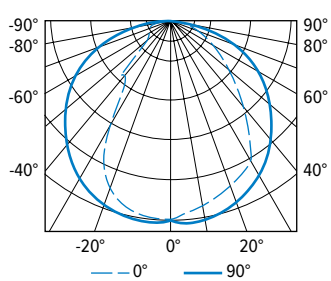

VERTICAL ANGLE	HORIZONTAL ANGLE					ZONAL LUMENS
	0°	45°	90°	135°	180°	
0	1731	1731	1731	1731	1731	1731
5	1685	1717	1771	1749	1721	164
15	1600	1645	1730	1688	1638	469
25	1487	1524	1630	1537	1339	696
35	1226	1364	1475	1163	633	768
45	837	1072	1271	547	272	685
55	547	680	1031	227	208	538
65	314	385	736	160	187	354
75	117	153	403	113	112	178
85	0	9	37	26	25	35
90	0	0	0	1	0	0

LUMEN SUMMARY	ZONE	LUMENS	% FIXTURE
0 - 30	1329	34	
0 - 40	2096	54	
0 - 60	3320	85	
0 - 90	3886	100	
0 - 180	3886	100	

PXF-62-03'08-P11/835-S-LCAP/RCAP-DIM-UNV Total Luminaire Output: 4015 lumens; 38.2 Watts | Efficacy: 105.1 lm/W | 80 CRI; 3500K CCT

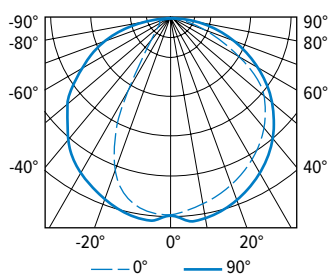

VERTICAL ANGLE	HORIZONTAL ANGLE					ZONAL LUMENS
	0°	45°	90°	135°	180°	
0	1774	1774	1774	1774	1774	1774
5	1729	1752	1827	1789	1755	168
15	1645	1674	1779	1709	1625	476
25	1532	1551	1674	1508	1164	695
35	1394	1386	1522	1054	358	755
45	1195	1198	1308	347	171	703
55	942	951	1056	146	125	592
65	494	616	742	97	116	395
75	170	228	384	78	85	198
85	0	4	27	23	21	33
90	0	0	0	0	0	0

LUMEN SUMMARY	ZONE	LUMENS	% FIXTURE
0 - 30	1339	33	
0 - 40	2094	52	
0 - 60	3389	84	
0 - 90	4015	100	
0 - 180	4015	100	

REMOTE MOUNT DETAILS

Includes 2' plenum-rated 18ga. solid cable. Remote box can be installed in:

- Above ceiling grid
- Remote closet (within 100ft)
- Surface below ceiling

See **Technical Info** for dimension details.

NODE

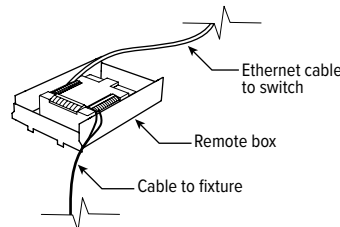

NODE AND EM OPTION

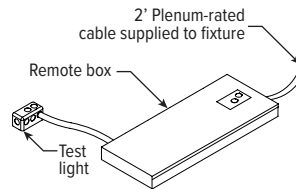

CROSS SECTIONS

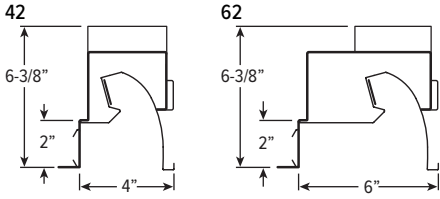

CEILING TYPE DETAILS

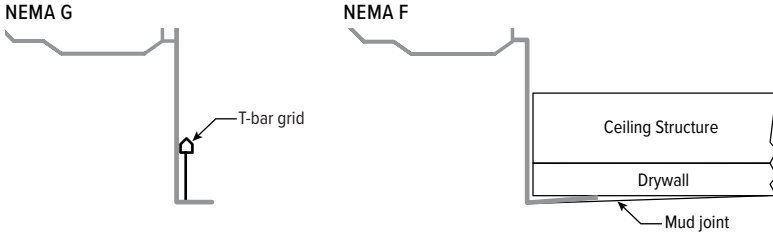

END TYPE DETAILS

