

STRIP RETROFIT KIT

SRK

LED

CATALOG #:	TYPE:
PROJECT:	NOTES:

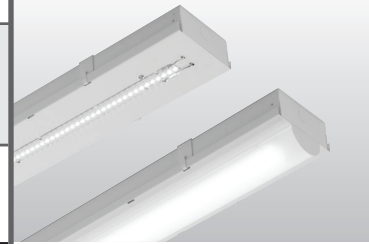

EXAMPLE → **SRK - M 8 - L140/840 - OPTIONS - DRV - UNV**

SERIES NOMINAL WIDTH NOMINAL LENGTH LUMEN PACKAGE CRI & CCT OPTIONS DRIVER VOLTAGE

CROSS SECTION

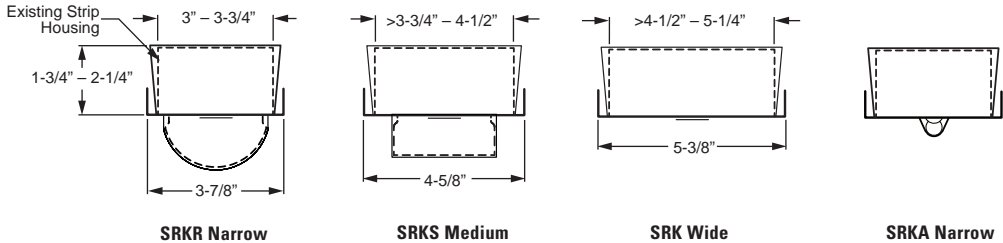

FEATURES

- ▶ Quickly upgrade existing fluorescent strips to energy-saving LED.
- ▶ Four distinct styles enhance any space.
- ▶ Simple installation does not require tools.
- ▶ Fits any 3" - 5-1/4" wide existing strip housing. Additional widths available, consult factory.
- ▶ Diffuse acrylic lens on SRKR and SRKS enhances uniformity and minimizes glare
- ▶ SRKA features innovative aisle optic for even illumination from floor to ceiling.
- ▶ Heavy duty C.R.S. construction.
- ▶ This fixture is proudly made in the USA.

RETROFIT GUIDE

Fluorescent	Wattage	LED	Wattage	Savings
1 - 32W T8	30	SRK-4-L31	21	30%
2 - 32W T8	59	SRK-4-L52	34	42%
3 - 32W T8	85	SRK-4-L70	47	45%
2 - 32W T8	59	SRK-8-L63	43	28%
4 - 32W T8	112	SRK-8-L104	70	38%
6 - 32W T8	171	SRK-8-L140	94	45%

All assuming standard F032 T8 lamping and 0.88 ballast factor, instant start T8 ballast.

NOTE: H.E. Williams, Inc. recommends installing a trial fixture prior to ordering full project quantities.



ORDERING INFORMATION

SERIES
 Fixture relies on existing housing and end plates, by others.
SRK Strip Retrofit Kit
SRKR Strip Retrofit Kit — Round Lens
SRKS Strip Retrofit Kit — Square Lens
SRKA Strip Retrofit Kit — Aisle Optics

NOMINAL WIDTH
N Narrow, 3"–3-3/4"
M Medium, >3-3/4"– 4-1/2"
W Wide, >4-1/2" – 5-1/4"

NOMINAL LENGTH
4 4'
8 8' (two 4' wireway covers)

EXAMPLE: L140/840			WATTAGE	
LUMEN PACKAGE	LUMENS	MINIMUM CRI & CCT	SRK/ SRKA	SRKR/ SRKS
4'				
L31	3,100	830 = 82 CRI, 3000K 835 = 82 CRI, 3500K 840 = 82 CRI, 4000K	21	20
L52	5,200		34	34
L70	7,000		47	47
8'				
L63	6,300	850 = 82 CRI, 5000K	43	40
L104	10,400		70	70
L140	14,000		94	94

Lumen output based on 4000 CCT. Actual lumens may vary +/-5%, see fixture performance data. Additional LED lumen packages available, see options.

OPTIONS
EM/10WLP Low-profile 10-watt emergency battery (120V or 277V only)
(L__) Additional lower lumen packages available. Specify in increments of 100 nominal lumens. Option must be specified with next higher lumen package.
Example: 9,000 nominal lumens = SRK-8-L104/840-(L90)
OCC__ Integral, factory-installed occupancy and daylight sensor (120V or 277V only; SRK and SRKA only), see page 4 for details:
OCCSS SFR-7-120/277
OCCSS SFR-30-120/277
(H__) Additional housing heights available, must specify:
25 >2-1/4 – 2-3/4
30 >2-3/4 – 3-1/4
35 >3-1/4 – 3-3/4

DRIVER
 Additional dimming drivers available, see [Technical Info](#).
DRV Driver prewired for non-dimming applications
DIM 10% dimming driver prewired for 0-10V low voltage applications

VOLTAGE
120 120V
277 277V
UNV 120-277V
347 347V (not available with EM drivers)



LED

PHOTOMETRY

SPECIFICATIONS

Housing – Provided by others, must be 3" - 5-1/4" wide.

Wireway Cover – 22-gauge die-formed C.R.S.

Finish – 92% minimum average reflective white polyester powder coat bonded to phosphate-free, multi-stage pretreated metal. All parts painted after fabrication to facilitate installation, increase efficiency, and inhibit corrosion.

Electrical – High quality mid-power LED boards. Rated >50,000 hours at L70.

Mounting – Toolless mounting brackets attach to existing strip channels from 3" to 5-1/4" wide.

Listings –

- cCSAus classified as luminaire suitable for dry or damp locations
- DesignLights Consortium qualified product. Not all versions of this product may be DLC qualified, see the DLC Qualified Products List at www.designlights.org/QPL.

Warranty – 5-year limited warranty, see hew.com/warranty.

IMPORTANT:

Electrostatic sensitive unit. Observe precautions when handling.

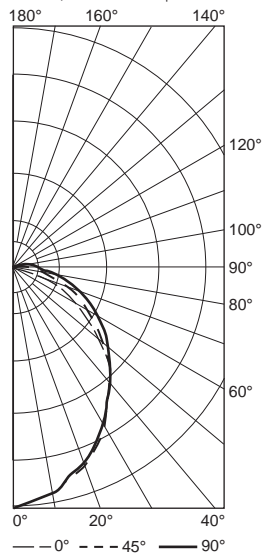
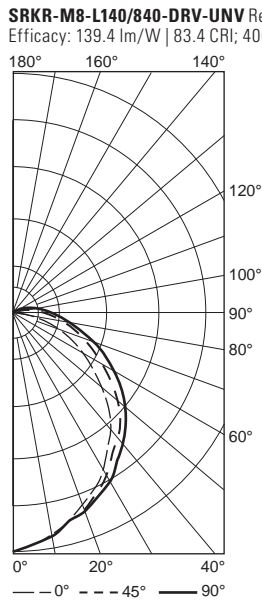
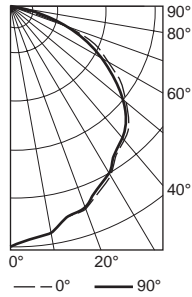

See next page for SRKA photometry.

SRK-M8-L140/840-DRV-UNV Report #: 19999.0; 08/08/17 | Total Luminaire Output: 14031 lumens; 94.3 Watts
Efficacy: 148.8 lm/W | 83 CRI; 4056K CCT | IES Spacing Criteria: End: 1.2, Across: 1.2, Diagonal: 1.2

CANDLEPOWER DISTRIBUTION	Vertical Angle	Horizontal Angle			Zonal Lumens
		0°	45°	90°	
	0	4947	4947	4947	
5	4814	4814	4812	459	
15	4506	4495	4484	1275	
25	4211	4193	4174	1941	
35	3774	3735	3705	2348	
45	3398	3342	3318	2595	
55	2745	2695	2645	2417	
65	1939	1876	1798	1859	
75	951	890	860	951	
85	176	174	167	187	
90	13	22	24		

LUMEN SUMMARY	Zone	Lumens	% Fixture
	0 - 30	3674	26
	0 - 40	6022	43
	0 - 60	11035	79
	0 - 90	14031	100
	0 - 180	14031	100

SRKR-M8-L140/840-DRV-UNV Report #: 20000.0; 08/08/17 | Total Luminaire Output: 13143 lumens; 94.3 Watts
Efficacy: 139.4 lm/W | 83.4 CRI; 4069K CCT | IES Spacing Criteria: End: 1.1, Across: 1.2, Diagonal: 1.2

CANDLEPOWER DISTRIBUTION	Vertical Angle	Horizontal Angle			Zonal Lumens
		0°	45°	90°	
	0	4521	4521	4521	
5	4395	4395	4400	420	
15	4052	4077	4094	1156	
25	3637	3720	3799	1722	
35	3058	3228	3373	2021	
45	2454	2797	3008	2141	
55	1763	2216	2454	1944	
65	1104	1616	1873	1537	
75	512	1049	1229	1020	
85	134	679	822	644	
90	0	490	618		
95	0	380	506	346	
105	0	158	266	144	
115	0	18	114	42	
125	0	0	22	7	
135	0	0	0	0	
145	0	0	0	0	
155	0	0	0	0	
165	0	0	0	0	
175	0	0	0	0	
180	0	0	0	0	

LUMEN SUMMARY	Zone	Lumens	% Fixture
	0 - 30	3297	25
	0 - 40	5318	41
	0 - 60	9403	72
	0 - 90	12603	96
	90 - 120	531	4
	90 - 150	539	4
	90 - 180	539	4
	0 - 180	13143	100

SRKS-M8-L140/840-DRV-UNV Report #: 20001.0; 08/08/17 | Total Luminaire Output: 13072 lumens; 94.2 Watts
Efficacy: 138.7 lm/W | 83.3 CRI; 4069K CCT | IES Spacing Criteria: End: 1.1, Across: 1.1, Diagonal: 1.1

CANDLEPOWER DISTRIBUTION	Vertical Angle	Horizontal Angle			Zonal Lumens
		0°	45°	90°	
	0	4796	4796	4796	
5	4677	4684	4677	446	
15	4325	4310	4295	1223	
25	3890	3873	3840	1792	
35	3262	3240	3198	2032	
45	2622	2655	2688	2058	
55	1864	2024	2194	1822	
65	1156	1466	1747	1453	
75	538	943	1207	970	
85	147	589	807	589	
90	0	402	576		
95	0	349	495	329	
105	0	226	352	208	
115	0	108	237	108	
125	0	22	119	39	
135	0	0	24	2	
145	0	0	0	0	
155	0	0	0	0	
165	0	0	0	0	
175	0	0	0	0	
180	0	0	0	0	

LUMEN SUMMARY	Zone	Lumens	% Fixture
	0 - 30	3461	27
	0 - 40	5493	42
	0 - 60	9374	72
	0 - 90	12385	95
	90 - 120	645	5
	90 - 150	687	5
	90 - 180	687	5
	0 - 180	13072	100

PHOTOMETRY (Continued)

SRKA-M8-L140/840-DRV-UNV Report #: 20002.0; 08/08/17 | Total Luminaire Output: 12822 lumens; 94.4 Watts
 Efficacy: 135.8 lm/W | 83.2 CRI; 4011K CCT | IES Spacing Criteria: End: 1.3, Across: .6, Diagonal: .5

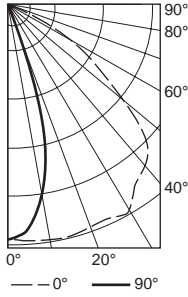

CANDLEPOWER DISTRIBUTION	Vertical Angle	Horizontal Angle			Zonal Lumens
		0°	45°	90°	
	0	14175	14175	14175	
5	13784	13384	13035	1279	
15	12766	9309	7037	2718	
25	12762	4630	2308	2771	
35	11349	1508	872	2106	
45	9545	795	572	1614	
55	5679	427	345	1081	
65	2685	245	245	586	
75	859	227	277	351	
85	114	218	277	252	
90	23	150	200		

LUMEN SUMMARY	Zone	Lumens	% Fixture
	0 - 30	6767	53
	0 - 40	8873	69
	0 - 60	11568	90
	0 - 90	12756	99
	0 - 180	12822	100

FIXTURE PERFORMANCE DATA

LED PACKAGE	SRK			SRKR/SRKS ¹			SRKA		
	DELIVERED LUMENS	WATTAGE	EFFICACY (lm/W)	DELIVERED LUMENS	WATTAGE	EFFICACY (lm/W)	DELIVERED LUMENS	WATTAGE	EFFICACY (lm/W)
4'									
L31	3116	21.4	145.8	2954	20.2	146.5	2922	20.2	144.9
L52	5179	33.7	153.6	4816	33.7	142.9	4764	33.7	141.3
L70	7015	47.2	148.8	6536	47.1	138.7	6441	47.2	135.8
8'									
L63	6358	42.5	149.6	6231	40.1	155.4	5849	42.5	137.6
L104	10358	67.4	153.6	9632	67.4	142.9	9529	67.4	141.3
L140	14031	94.3	148.8	13072	94.2	138.7	12822	94.4	135.8

80 CRI	COLOR TEMPERATURE MULTIPLIER	
	CCT	CONVERSION FACTOR
	3000K	0.96
3500K	0.97	
4000K	1.00	
5000K	1.03	

- ¹ SRKS shown
- Photometrics tested in accordance with IESNA LM-79. Results shown are based on 25°C ambient temperature and 4000K CCT.
- Wattage shown is average for 120V through 277V input.
- Results scaled based on relative CCT output.
- Use multiplier table to calculate additional options.

FIXTURE DETAILS

MOUNTING BRACKET LOCATIONS

4' FIXTURE

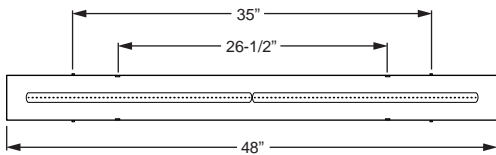

8' FIXTURE

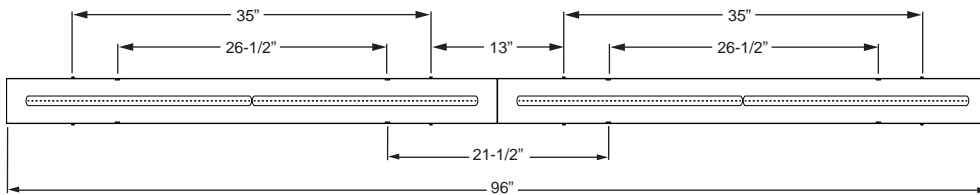

BRACKET INSTALLATION DETAILS

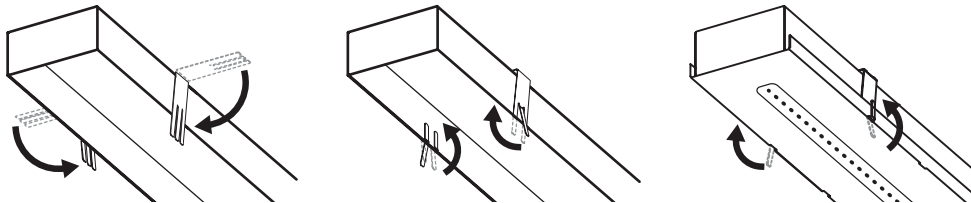

OCCUPANCY SENSOR DETAILS

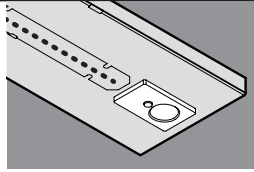

EXAMPLE

OCCSS SFR-7-120/277

OCCUPANCY
SENSOR

- ▶ Line voltage passive infrared (PIR)
- ▶ Self-contained relay, no power pack needed
- ▶ No minimum load requirements
- ▶ Interchangeable hot & load wires
- ▶ Push-button programmable
- ▶ Adjustable time delays
- ▶ No field calibration or sensitivity adjustments required
- ▶ Convenient test mode
- ▶ 100 hr lamp burn-in timer
- ▶ Adjustable time delay (30 seconds to 30 minutes)
- ▶ Factory set to 10 minutes

ORDERING INFORMATION

OCCSS SFR-7-120/277 Low bay 360° sensor
OCCSS SFR-30-120/277 Universal 360° sensor

COVERAGE PATTERNS

OCCSS SFR-7-120/277

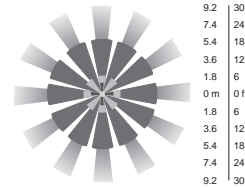

OCCSS SFR-30-120/277

